

Monitoring Locations: Three monitoring locations have been selected as shown in Figure 1 below
Level 2 Noise Monitor: KR Level 2 Zone 6
Level 2 Vibration Monitor: KR Level 2 Zone 6
Level 3 Vibration Monitor: SAM HD Lab
Equipment: H&K 2255 S/N 100100
Settings: A weighted, Fast, Leq, L10 and L90
Calibration Date: 4/05/2023 (valid for 24 months)
Data Sample Interval: 15 Mins

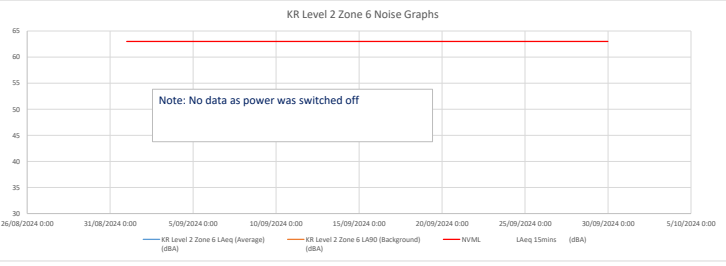
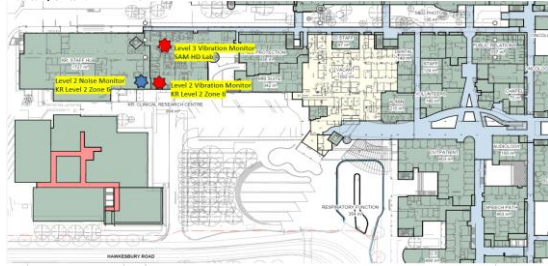

Figure 1: Noise & Vibration monitoring locations

Noise and Vibration Management Levels

Level 2 Noise Monitor	KR Level 2 Zone 6	L _{Aeq} , 15min+6.3dB
Level 2 Vibration Monitor	KR Level 2 Zone 6	DIN 4152-3 PPV <8mm/s
Level 3 Vibration Monitor	SAM HD Lab	VC-A Curve PPV <50um/s

Date/Time	KR Level 2 Zone 6 LAeq (Average) (dBA)	KR Level 2 Zone 6 LA90 (Background) (dBA)	NWML LAeq 15mins (dBA)
1/09/2024 0:00	0	0	63.0
1/09/2024 0:15	0	0	63.0
1/09/2024 0:30	0	0	63.0
1/09/2024 0:45	0	0	63.0
1/09/2024 1:00	0	0	63.0
1/09/2024 1:15	0	0	63.0
1/09/2024 1:30	0	0	63.0
1/09/2024 1:45	0	0	63.0
1/09/2024 2:00	0	0	63.0
1/09/2024 2:15	0	0	63.0
1/09/2024 2:30	0	0	63.0
1/09/2024 2:45	0	0	63.0
1/09/2024 3:00	0	0	63.0
1/09/2024 3:15	0	0	63.0
1/09/2024 3:30	0	0	63.0
1/09/2024 3:45	0	0	63.0
1/09/2024 4:00	0	0	63.0
1/09/2024 4:15	0	0	63.0
1/09/2024 4:30	0	0	63.0
1/09/2024 4:45	0	0	63.0
1/09/2024 5:00	0	0	63.0
1/09/2024 5:15	0	0	63.0
1/09/2024 5:30	0	0	63.0
1/09/2024 5:45	0	0	63.0
1/09/2024 6:00	0	0	63.0
1/09/2024 6:15	0	0	63.0
1/09/2024 6:30	0	0	63.0
1/09/2024 6:45	0	0	63.0
1/09/2024 7:00	0	0	63.0
1/09/2024 7:15	0	0	63.0
1/09/2024 7:30	0	0	63.0
1/09/2024 7:45	0	0	63.0
1/09/2024 8:00	0	0	63.0
1/09/2024 8:15	0	0	63.0
1/09/2024 8:30	0	0	63.0
1/09/2024 8:45	0	0	63.0
1/09/2024 9:00	0	0	63.0
1/09/2024 9:15	0	0	63.0
1/09/2024 9:30	0	0	63.0
1/09/2024 9:45	0	0	63.0
1/09/2024 10:00	0	0	63.0
1/09/2024 10:15	0	0	63.0
1/09/2024 10:30	0	0	63.0
1/09/2024 10:45	0	0	63.0
1/09/2024 11:00	0	0	63.0
1/09/2024 11:15	0	0	63.0
1/09/2024 11:30	0	0	63.0
1/09/2024 11:45	0	0	63.0
1/09/2024 12:00	0	0	63.0
1/09/2024 12:15	0	0	63.0
1/09/2024 12:30	0	0	63.0
1/09/2024 12:45	0	0	63.0
1/09/2024 13:00	0	0	63.0
1/09/2024 13:15	0	0	63.0
1/09/2024 13:30	0	0	63.0
1/09/2024 13:45	0	0	63.0
1/09/2024 14:00	0	0	63.0
1/09/2024 14:15	0	0	63.0
1/09/2024 14:30	0	0	63.0
1/09/2024 14:45	0	0	63.0
1/09/2024 15:00	0	0	63.0
1/09/2024 15:15	0	0	63.0
1/09/2024 15:30	0	0	63.0
1/09/2024 15:45	0	0	63.0
1/09/2024 16:00	0	0	63.0
1/09/2024 16:15	0	0	63.0
1/09/2024 16:30	0	0	63.0
1/09/2024 16:45	0	0	63.0
1/09/2024 17:00	0	0	63.0
1/09/2024 17:15	0	0	63.0
1/09/2024 17:30	0	0	63.0
1/09/2024 17:45	0	0	63.0
1/09/2024 18:00	0	0	63.0
1/09/2024 18:15	0	0	63.0
1/09/2024 18:30	0	0	63.0
1/09/2024 18:45	0	0	63.0
1/09/2024 19:00	0	0	63.0
1/09/2024 19:15	0	0	63.0
1/09/2024 19:30	0	0	63.0
1/09/2024 19:45	0	0	63.0
1/09/2024 20:00	0	0	63.0
1/09/2024 20:15	0	0	63.0
1/09/2024 20:30	0	0	63.0
1/09/2024 20:45	0	0	63.0
1/09/2024 21:00	0	0	63.0
1/09/2024 21:15	0	0	63.0
1/09/2024 21:30	0	0	63.0
1/09/2024 21:45	0	0	63.0
1/09/2024 22:00	0	0	63.0
1/09/2024 22:15	0	0	63.0
1/09/2024 22:30	0	0	63.0
1/09/2024 22:45	0	0	63.0
1/09/2024 23:00	0	0	63.0
1/09/2024 23:15	0	0	63.0
1/09/2024 23:30	0	0	63.0
1/09/2024 23:45	0	0	63.0
2/09/2024 0:00	0	0	63.0
2/09/2024 0:15	0	0	63.0
2/09/2024 0:30	0	0	63.0

29/09/2024 18:30	0	0	63
29/09/2024 18:45	0	0	63
29/09/2024 18:50	0	0	63
29/09/2024 18:55	0	0	63
29/09/2024 19:00	0	0	63
29/09/2024 19:15	0	0	63
29/09/2024 19:30	0	0	63
29/09/2024 19:45	0	0	63
29/09/2024 20:00	0	0	63
29/09/2024 20:15	0	0	63
29/09/2024 20:30	0	0	63
29/09/2024 20:45	0	0	63
29/09/2024 21:00	0	0	63
29/09/2024 21:15	0	0	63
29/09/2024 21:30	0	0	63
29/09/2024 21:45	0	0	63
29/09/2024 22:00	0	0	63
29/09/2024 22:15	0	0	63
29/09/2024 22:30	0	0	63
29/09/2024 22:45	0	0	63
29/09/2024 23:00	0	0	63
29/09/2024 23:15	0	0	63
29/09/2024 23:30	0	0	63
29/09/2024 23:45	0	0	63

Monitoring Locations: Three monitoring locations have been selected as shown in Figure 1 below
Level 2 Noise Monitor: KR Level 2 Zone 6
Level 2 Vibration Monitor: KR Level 2 Zone 6
Level 3 Vibration Monitor: SAM HD Lab
Equipment: B&K 3680C 5/N 3117893 with geophone 410
Settings: DIN 4150-3 (1-315 Hz)
Calibration Date: 09/08/2023(valid for 24 months)
Data Sample Interval: 15 mins

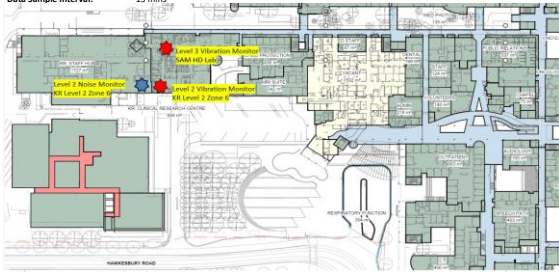
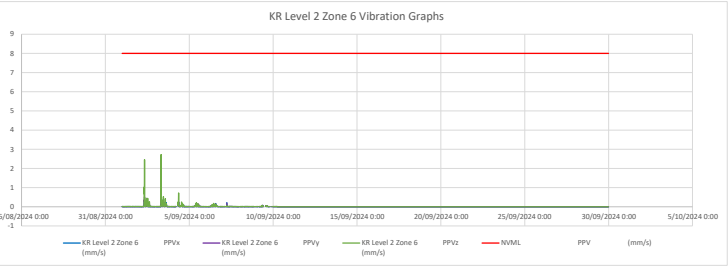

Figure 1: Noise & Vibration monitoring locations



Noise and Vibration Management Levels

Level 2 Noise Monitor	KR Level 2 Zone 6	LAeq, 15min=63dB
Level 2 Vibration Monitor*	KR Level 2 Zone 6	DIN 4150-3 PPV =8mm/s
Level 3 Vibration Monitor	SAM HD Lab	VC-A Curve PPV =50um/s

*Note: Vibration alerts will generate within the frequency range of 1-315Hz

Date/Time	KR Level 2 Zone 6		KR Level 2 Zone 6		NVML PPV (mm/s)
	PPVx (mm/s)	PPVy (mm/s)	PPVz (mm/s)	PPVz (mm/s)	
1/09/2024 0:00	0.0093	0.0094	0.0132	8	
1/09/2024 0:15	0.0089	0.0085	0.0128	8	
1/09/2024 0:30	0.008	0.0086	0.0137	8	
1/09/2024 0:45	0.0076	0.0077	0.0146	8	
1/09/2024 1:00	0.0091	0.0079	0.0139	8	
1/09/2024 1:15	0.0083	0.009	0.0141	8	
1/09/2024 1:30	0.0083	0.009	0.013	8	
1/09/2024 1:45	0.0063	0.0069	0.0139	8	
1/09/2024 2:00				8	
1/09/2024 2:15	0.0067	0.0076	0.014	8	
1/09/2024 2:30	0.0066	0.008	0.0125	8	
1/09/2024 2:45	0.0069	0.0075	0.0141	8	
1/09/2024 3:00	0.0071	0.0079	0.013	8	
1/09/2024 3:15	0.0071	0.008	0.013	8	
1/09/2024 3:30	0.0068	0.0073	0.013	8	
1/09/2024 3:45				8	
1/09/2024 4:00	0.0077	0.0077	0.0137	8	
1/09/2024 4:15	0.0073	0.008	0.0134	8	
1/09/2024 4:30	0.0073	0.0076	0.0135	8	
1/09/2024 4:45	0.0086	0.0083	0.0136	8	
1/09/2024 5:00	0.0083	0.0077	0.013	8	
1/09/2024 5:15	0.0074	0.0079	0.0125	8	
1/09/2024 5:30	0.0079	0.0083	0.0134	8	
1/09/2024 5:45	0.0074	0.0082	0.0128	8	
1/09/2024 6:00				8	
1/09/2024 6:15	0.0089	0.0074	0.0132	8	
1/09/2024 6:30	0.0088	0.0094	0.014	8	
1/09/2024 6:45	0.0115	0.0087	0.0129	8	
1/09/2024 7:00	0.0074	0.0082	0.0131	8	
1/09/2024 7:15	0.009	0.01	0.0132	8	
1/09/2024 7:30	0.0098	0.0097	0.0143	8	
1/09/2024 7:45	0.0078	0.0077	0.0125	8	
1/09/2024 8:00	0.0087	0.0079	0.0124	8	
1/09/2024 8:15	0.0092	0.0085	0.0132	8	
1/09/2024 8:30	0.0075	0.008	0.0131	8	
1/09/2024 8:45	0.0081	0.0089	0.0143	8	
1/09/2024 9:00	0.0082	0.0097	0.0154	8	
1/09/2024 9:15	0.0088	0.0085	0.0136	8	
1/09/2024 9:30	0.01	0.0089	0.0145	8	
1/09/2024 9:45	0.0084	0.0094	0.0149	8	
1/09/2024 10:00	0.0083	0.0082	0.0146	8	
1/09/2024 10:15	0.0082	0.0079	0.015	8	
1/09/2024 10:30	0.0097	0.0088	0.0142	8	
1/09/2024 10:45	0.0076	0.0082	0.0145	8	
1/09/2024 11:00	0.0083	0.0088	0.0153	8	
1/09/2024 11:15	0.0088	0.008	0.0143	8	
1/09/2024 11:30	0.0111	0.009	0.0148	8	
1/09/2024 11:45	0.0087	0.0083	0.0155	8	
1/09/2024 12:00	0.0083	0.007	0.0139	8	
1/09/2024 12:15	0.0088	0.0075	0.0144	8	
1/09/2024 12:30				8	
1/09/2024 12:45	0.0077	0.0075	0.0148	8	
1/09/2024 13:00	0.0089	0.0072	0.014	8	
1/09/2024 13:15				8	
1/09/2024 13:30				8	
1/09/2024 13:45	0.0078	0.0076	0.0136	8	
1/09/2024 14:00	0.0082	0.0075	0.0142	8	
1/09/2024 14:15	0.0076	0.0082	0.0136	8	
1/09/2024 14:30	0.01	0.0075	0.014	8	
1/09/2024 14:45	0.007	0.0069	0.0141	8	
1/09/2024 15:00	0.0153	0.0095	0.0147	8	
1/09/2024 15:15	0.0087	0.0078	0.0131	8	
1/09/2024 15:30	0.0081	0.0081	0.0149	8	
1/09/2024 15:45	0.0077	0.0076	0.0139	8	
1/09/2024 16:00	0.0082	0.0086	0.0139	8	
1/09/2024 16:15	0.0084	0.0072	0.0143	8	
1/09/2024 16:30	0.0083	0.0074	0.0144	8	
1/09/2024 16:45	0.0095	0.0077	0.0142	8	
1/09/2024 17:00	0.0074	0.0072	0.0137	8	
1/09/2024 17:15	0.0086	0.0081	0.014	8	
1/09/2024 17:30	0.0084	0.0081	0.0155	8	
1/09/2024 17:45	0.0077	0.0078	0.0137	8	
1/09/2024 18:00				8	
1/09/2024 18:15	0.0078	0.0085	0.0138	8	
1/09/2024 18:30	0.008	0.0081	0.0131	8	
1/09/2024 18:45	0.0072	0.007	0.0133	8	
1/09/2024 19:00	0.0087	0.0085	0.0133	8	
1/09/2024 19:15	0.012	0.0092	0.0131	8	
1/09/2024 19:30	0.0089	0.0083	0.0128	8	
1/09/2024 19:45	0.0098	0.0084	0.0124	8	
1/09/2024 20:00	0.0089	0.0091	0.0126	8	
1/09/2024 20:15	0.009	0.0082	0.0122	8	
1/09/2024 20:30	0.009	0.0076	0.0121	8	
1/09/2024 20:45	0.0086	0.0079	0.0124	8	
1/09/2024 21:00	0.0096	0.0079	0.0134	8	
1/09/2024 21:15	0.0096	0.0075	0.0127	8	
1/09/2024 21:30	0.0089	0.0086	0.0126	8	
1/09/2024 21:45	0.0082	0.008	0.0132	8	
1/09/2024 22:00	0.0074	0.0074	0.0129	8	
1/09/2024 22:15	0.0089	0.0078	0.0124	8	
1/09/2024 22:30	0.0111	0.0085	0.0134	8	
1/09/2024 22:45	0.0105	0.0087	0.0125	8	
1/09/2024 23:00	0.0088	0.0072	0.0134	8	
1/09/2024 23:15	0.0091	0.0082	0.0122	8	
1/09/2024 23:30	0.0072	0.007	0.0123	8	

1/09/2024 23:45	0.0081	0.0082	0.013	8
2/09/2024 0:00	0.0098	0.0076	0.0137	8
2/09/2024 0:15	0.0088	0.009	0.0147	8
2/09/2024 0:30	0.0091	0.008	0.0148	8
2/09/2024 0:45	0.0068	0.0077	0.0137	8
2/09/2024 1:00				8
2/09/2024 1:15	0.0095	0.0097	0.0132	8
2/09/2024 1:30	0.0082	0.0079	0.0134	8
2/09/2024 1:45	0.007	0.007	0.0137	8
2/09/2024 2:00	0.0071	0.0072	0.0133	8
2/09/2024 2:15	0.0073	0.0078	0.0154	8
2/09/2024 2:30	0.0075	0.0082	0.0137	8
2/09/2024 2:45	0.0075	0.0072	0.014	8
2/09/2024 3:00	0.0054	0.0048	0.0099	8
2/09/2024 3:15				8
2/09/2024 3:30	0.0071	0.0074	0.0132	8
2/09/2024 3:45	0.0071	0.0076	0.0123	8
2/09/2024 4:00	0.007	0.0078	0.0126	8
2/09/2024 4:15	0.0077	0.0076	0.013	8
2/09/2024 4:30	0.009	0.0081	0.0134	8
2/09/2024 4:45	0.007	0.0078	0.0131	8
2/09/2024 5:00	0.0096	0.0091	0.0127	8
2/09/2024 5:15	0.0106	0.008	0.0135	8
2/09/2024 5:30	0.0099	0.0082	0.0132	8
2/09/2024 5:45	0.0097	0.0085	0.0131	8
2/09/2024 6:00	0.0084	0.0093	0.0138	8
2/09/2024 6:15	0.0097	0.0084	0.0146	8
2/09/2024 6:30	0.0105	0.0093	0.0149	8
2/09/2024 6:45	0.0081	0.0088	0.013	8
2/09/2024 7:00	0.0086	0.009	0.0134	8
2/09/2024 7:15	0.0097	0.0125	0.0179	8
2/09/2024 7:30	0.3236	0.3594	1.0289	8
2/09/2024 7:45	0.2879	0.2997	0.6562	8
2/09/2024 8:00	0.3395	0.306	2.4545	8
2/09/2024 8:15	0.2423	0.2344	0.471	8
2/09/2024 8:30	0.0321	0.0403	0.0566	8
2/09/2024 8:45	0.0813	0.0682	0.1069	8
2/09/2024 9:00	0.015	0.0282	0.0352	8
2/09/2024 9:15	0.0205	0.0162	0.021	8
2/09/2024 9:30	0.0111	0.0181	0.0217	8
2/09/2024 9:45	0.0122	0.0142	0.0221	8
2/09/2024 10:00	0.0111	0.0103	0.0181	8
2/09/2024 10:15	0.0715	0.2279	0.499	8
2/09/2024 10:30	0.0858	0.134	0.1896	8
2/09/2024 10:45	0.1331	0.16	0.4433	8
2/09/2024 11:00	0.0842	0.1079	0.2041	8
2/09/2024 11:15	0.0711	0.1333	0.2272	8
2/09/2024 11:30	0.052	0.0876	0.1341	8
2/09/2024 11:45	0.0563	0.0705	0.1373	8
2/09/2024 12:00	0.0807	0.1118	0.2437	8
2/09/2024 12:15	0.0108	0.0154	0.0205	8
2/09/2024 12:30	0.2066	0.239	0.4416	8
2/09/2024 12:45	0.0357	0.0322	0.0579	8
2/09/2024 13:00	0.0114	0.0152	0.0222	8
2/09/2024 13:15	0.0126	0.0115	0.0169	8
2/09/2024 13:30	0.012	0.0128	0.0182	8
2/09/2024 13:45	0.0104	0.0114	0.0212	8
2/09/2024 14:00	0.0125	0.0148	0.0338	8
2/09/2024 14:15	0.0107	0.013	0.0152	8
2/09/2024 14:30	0.0155	0.0151	0.0245	8
2/09/2024 14:45	0.0157	0.0145	0.0259	8
2/09/2024 15:00	0.0668	0.155	0.2612	8
2/09/2024 15:15	0.0101	0.0093	0.0174	8
2/09/2024 15:30	0.0104	0.0147	0.02	8
2/09/2024 15:45	0.017	0.0207	0.0408	8
2/09/2024 16:00	0.0097	0.0134	0.021	8
2/09/2024 16:15	0.0113	0.0092	0.0155	8
2/09/2024 16:30	0.0099	0.0085	0.0157	8
2/09/2024 16:45	0.0092	0.0094	0.0153	8
2/09/2024 17:00	0.013	0.0181	0.0272	8
2/09/2024 17:15	0.0082	0.0095	0.0148	8
2/09/2024 17:30	0.0077	0.009	0.0133	8
2/09/2024 17:45	0.008	0.0077	0.0157	8
2/09/2024 18:00	0.0085	0.0094	0.0147	8
2/09/2024 18:15	0.0082	0.0082	0.0145	8
2/09/2024 18:30	0.0086	0.0085	0.0145	8
2/09/2024 18:45	0.0109	0.0092	0.0144	8
2/09/2024 19:00	0.0077	0.0088	0.0127	8
2/09/2024 19:15				8
2/09/2024 19:30	0.0081	0.0089	0.0131	8
2/09/2024 19:45	0.0075	0.0086	0.0121	8
2/09/2024 20:00	0.0085	0.0079	0.0123	8
2/09/2024 20:15	0.0083	0.0089	0.0126	8
2/09/2024 20:30	0.0073	0.008	0.0133	8
2/09/2024 20:45	0.006	0.0063	0.0115	8
2/09/2024 21:00	0.0076	0.0085	0.0132	8
2/09/2024 21:15	0.0068	0.0079	0.0136	8
2/09/2024 21:30				8
2/09/2024 21:45	0.0089	0.0074	0.0142	8
2/09/2024 22:00	0.0086	0.0084	0.0138	8
2/09/2024 22:15	0.0076	0.0091	0.0134	8
2/09/2024 22:30	0.0066	0.0081	0.0127	8
2/09/2024 22:45				8
2/09/2024 23:00	0.0073	0.0086	0.0136	8
2/09/2024 23:15	0.0069	0.0085	0.0137	8
2/09/2024 23:30				8
2/09/2024 23:45				8
3/09/2024 0:00				8
3/09/2024 0:15	0.0072	0.0094	0.0141	8
3/09/2024 0:30	0.0073	0.008	0.0133	8
3/09/2024 0:45	0.0078	0.0094	0.0139	8
3/09/2024 1:00	0.0077	0.0092	0.0139	8
3/09/2024 1:15	0.0068	0.0074	0.013	8
3/09/2024 1:30				8
3/09/2024 1:45	0.0078	0.0092	0.014	8
3/09/2024 2:00	0.0074	0.01	0.0133	8
3/09/2024 2:15				8
3/09/2024 2:30	0.0073	0.0085	0.013	8
3/09/2024 2:45	0.007	0.0094	0.0136	8
3/09/2024 3:00	0.007	0.0087	0.0138	8
3/09/2024 3:15	0.0056	0.0066	0.0116	8
3/09/2024 3:30	0.0074	0.01	0.0139	8
3/09/2024 3:45	0.0072	0.0087	0.013	8
3/09/2024 4:00				8
3/09/2024 4:15	0.0069	0.0089	0.014	8
3/09/2024 4:30	0.0071	0.0099	0.0146	8
3/09/2024 4:45	0.0079	0.0083	0.0134	8
3/09/2024 5:00	0.0067	0.0073	0.0119	8
3/09/2024 5:15	0.007	0.0092	0.0134	8
3/09/2024 5:30	0.0088	0.0095	0.0145	8
3/09/2024 5:45	0.0076	0.0095	0.0133	8
3/09/2024 6:00	0.0055	0.0065	0.0118	8
3/09/2024 6:15	0.0082	0.0096	0.014	8
3/09/2024 6:30	0.0115	0.0156	0.0252	8
3/09/2024 6:45	0.0072	0.0086	0.0135	8
3/09/2024 7:00	0.0267	0.0196	0.0216	8
3/09/2024 7:15	0.0109	0.0167	0.0279	8
3/09/2024 7:30	0.0092	0.0079	0.0122	8
3/09/2024 7:45	0.4769	0.6182	2.7239	8
3/09/2024 8:00	0.3316	0.2945	0.611	8
3/09/2024 8:15	0.0702	0.0958	0.1543	8
3/09/2024 8:30	0.0869	0.1225	0.2019	8
3/09/2024 8:45	0.0502	0.0919	0.2157	8
3/09/2024 9:00	0.0555	0.1073	0.1993	8
3/09/2024 9:15	0.1755	0.1633	0.3332	8
3/09/2024 9:30	0.0244	0.0543	0.0558	8
3/09/2024 9:45	0.0178	0.0226	0.0297	8
3/09/2024 10:00	0.0117	0.0131	0.0231	8
3/09/2024 10:15	0.0118	0.0132	0.0237	8
3/09/2024 10:30	0.0176	0.0175	0.0292	8
3/09/2024 10:45	0.0423	0.0495	0.1193	8
3/09/2024 11:00	0.3913	0.2774	0.5275	8

3/09/2024 11:15	0.0664	0.0498	0.1073	8
3/09/2024 11:30	0.0728	0.0978	0.1579	8
3/09/2024 11:45	0.0617	0.1265	0.1613	8
3/09/2024 12:00	0.0654	0.0981	0.1051	8
3/09/2024 12:15	0.0248	0.0254	0.0323	8
3/09/2024 12:30	0.0641	0.0474	0.0778	8
3/09/2024 12:45	0.009	0.0122	0.018	8
3/09/2024 13:00	0.01	0.0112	0.0231	8
3/09/2024 13:15	0.0093	0.0118	0.0151	8
3/09/2024 13:30	0.0518	0.0563	0.1243	8
3/09/2024 13:45	0.1865	0.2391	0.4225	8
3/09/2024 14:00	0.1089	0.0949	0.175	8
3/09/2024 14:15	0.2271	0.1261	0.1567	8
3/09/2024 14:30	0.0585	0.1047	0.1794	8
3/09/2024 14:45				8
3/09/2024 15:00	0.2191	0.1615	0.1554	8
3/09/2024 15:15	0.0689	0.0484	0.0568	8
3/09/2024 15:30	0.1002	0.0977	0.1051	8
3/09/2024 15:45				8
3/09/2024 16:00	0.0328	0.0277	0.019	8
3/09/2024 16:15	0.0089	0.0092	0.015	8
3/09/2024 16:30	0.0088	0.0117	0.0167	8
3/09/2024 16:45	0.0075	0.0091	0.0138	8
3/09/2024 17:00	0.0085	0.0085	0.0136	8
3/09/2024 17:15				8
3/09/2024 17:30	0.0093	0.0113	0.0163	8
3/09/2024 17:45	0.0101	0.0088	0.0209	8
3/09/2024 18:00	0.0091	0.0089	0.0192	8
3/09/2024 18:15	0.0089	0.0083	0.0146	8
3/09/2024 18:30	0.0079	0.009	0.0145	8
3/09/2024 18:45	0.008	0.008	0.0144	8
3/09/2024 19:00	0.0086	0.0086	0.0129	8
3/09/2024 19:15	0.0085	0.0061	0.0101	8
3/09/2024 19:30	0.0075	0.009	0.0125	8
3/09/2024 19:45	0.0075	0.0088	0.0134	8
3/09/2024 20:00	0.0075	0.0087	0.0139	8
3/09/2024 20:15	0.008	0.0079	0.0132	8
3/09/2024 20:30	0.0077	0.0081	0.0131	8
3/09/2024 20:45	0.0076	0.0078	0.0139	8
3/09/2024 21:00				8
3/09/2024 21:15	0.0069	0.0076	0.0125	8
3/09/2024 21:30				8
3/09/2024 21:45	0.0073	0.0092	0.0133	8
3/09/2024 22:00	0.007	0.009	0.0133	8
3/09/2024 22:15	0.0071	0.0088	0.0135	8
3/09/2024 22:30	0.0072	0.0093	0.0154	8
3/09/2024 22:45	0.0085	0.0084	0.0134	8
3/09/2024 23:00	0.0074	0.008	0.0131	8
3/09/2024 23:15				8
3/09/2024 23:30				8
3/09/2024 23:45	0.0076	0.0094	0.0132	8
4/09/2024 0:00	0.0073	0.0087	0.0141	8
4/09/2024 0:15	0.0076	0.009	0.0135	8
4/09/2024 0:30	0.0072	0.0086	0.0136	8
4/09/2024 0:45				8
4/09/2024 1:00				8
4/09/2024 1:15	0.0088	0.0092	0.0152	8
4/09/2024 1:30	0.0086	0.0075	0.0124	8
4/09/2024 1:45				8
4/09/2024 2:00	0.0071	0.0093	0.0139	8
4/09/2024 2:15	0.007	0.0092	0.0158	8
4/09/2024 2:30	0.0054	0.0071	0.0123	8
4/09/2024 2:45				8
4/09/2024 3:00	0.0081	0.0092	0.0141	8
4/09/2024 3:15	0.0049	0.0069	0.0108	8
4/09/2024 3:30	0.0073	0.0086	0.0129	8
4/09/2024 3:45	0.0107	0.0115	0.0133	8
4/09/2024 4:00	0.0069	0.0085	0.0143	8
4/09/2024 4:15				8
4/09/2024 4:30	0.0069	0.0095	0.0139	8
4/09/2024 4:45	0.0094	0.0089	0.0141	8
4/09/2024 5:00	0.0076	0.008	0.0135	8
4/09/2024 5:15				8
4/09/2024 5:30	0.0079	0.0102	0.0139	8
4/09/2024 5:45				8
4/09/2024 6:00				8
4/09/2024 6:15				8
4/09/2024 6:30	0.0285	0.0308	0.1058	8
4/09/2024 6:45				8
4/09/2024 7:00	0.009	0.0103	0.0169	8
4/09/2024 7:15				8
4/09/2024 7:30	0.1161	0.0661	0.0768	8
4/09/2024 7:45	0.0465	0.0784	0.1173	8
4/09/2024 8:00	0.1535	0.141	0.2515	8
4/09/2024 8:15	0.0577	0.0937	0.1586	8
4/09/2024 8:30	0.0658	0.0983	0.0717	8
4/09/2024 8:45	0.2346	0.2537	0.721	8
4/09/2024 9:00	0.0426	0.037	0.0489	8
4/09/2024 9:15	0.0146	0.015	0.0186	8
4/09/2024 9:30	0.0145	0.0252	0.0218	8
4/09/2024 9:45	0.0103	0.0121	0.0195	8
4/09/2024 10:00	0.0177	0.0242	0.0417	8
4/09/2024 10:15	0.0105	0.0103	0.0196	8
4/09/2024 10:30				8
4/09/2024 10:45	0.0215	0.0338	0.0355	8
4/09/2024 11:00	0.0068	0.0063	0.0117	8
4/09/2024 11:15	0.0129	0.0207	0.0238	8
4/09/2024 11:30	0.0283	0.0393	0.0468	8
4/09/2024 11:45	0.0287	0.0298	0.0412	8
4/09/2024 12:00	0.0291	0.0347	0.0371	8
4/09/2024 12:15				8
4/09/2024 12:30	0.0324	0.0358	0.0607	8
4/09/2024 12:45	0.0229	0.0329	0.0418	8
4/09/2024 13:00	0.0775	0.1183	0.2501	8
4/09/2024 13:15	0.0358	0.0522	0.134	8
4/09/2024 13:30	0.0817	0.1315	0.1588	8
4/09/2024 13:45	0.0113	0.0149	0.0203	8
4/09/2024 14:00	0.0167	0.0154	0.0218	8
4/09/2024 14:15	0.0097	0.0113	0.0157	8
4/09/2024 14:30	0.0089	0.011	0.0157	8
4/09/2024 14:45	0.0092	0.0109	0.0147	8
4/09/2024 15:00	0.0262	0.0385	0.0536	8
4/09/2024 15:15	0.0531	0.0597	0.0792	8
4/09/2024 15:30				8
4/09/2024 15:45	0.0801	0.0721	0.1255	8
4/09/2024 16:00	0.0104	0.011	0.0176	8
4/09/2024 16:15	0.0092	0.0113	0.015	8
4/09/2024 16:30	0.0099	0.0179	0.0168	8
4/09/2024 16:45	0.0099	0.0108	0.0217	8
4/09/2024 17:00	0.02	0.0196	0.0213	8
4/09/2024 17:15	0.0071	0.0083	0.014	8
4/09/2024 17:30	0.0083	0.0088	0.0125	8
4/09/2024 17:45	0.0083	0.0069	0.0094	8
4/09/2024 18:00	0.0086	0.0086	0.0143	8
4/09/2024 18:15	0.0125	0.0093	0.0124	8
4/09/2024 18:30	0.0101	0.01	0.0124	8
4/09/2024 18:45	0.0121	0.0107	0.0135	8
4/09/2024 19:00	0.0082	0.0088	0.0121	8
4/09/2024 19:15	0.0086	0.0076	0.0092	8
4/09/2024 19:30	0.0109	0.0098	0.0122	8
4/09/2024 19:45	0.0147	0.0116	0.0124	8
4/09/2024 20:00	0.0071	0.008	0.0092	8
4/09/2024 20:15	0.0096	0.01	0.0126	8
4/09/2024 20:30	0.0103	0.0099	0.0127	8
4/09/2024 20:45	0.014	0.0102	0.0119	8
4/09/2024 21:00				8
4/09/2024 21:15	0.0101	0.0095	0.0135	8
4/09/2024 21:30	0.0086	0.0091	0.0127	8
4/09/2024 21:45	0.0087	0.0092	0.0134	8
4/09/2024 22:00	0.0067	0.0095	0.0137	8
4/09/2024 22:15	0.0078	0.0099	0.0132	8
4/09/2024 22:30	0.0108	0.0091	0.0138	8

4/09/2024 22:45	0.0116	0.0096	0.0126	8
4/09/2024 23:00	0.0073	0.0088	0.0133	8
4/09/2024 23:15	0.0097	0.0089	0.0134	8
4/09/2024 23:30	0.0102	0.0088	0.0131	8
4/09/2024 23:45	0.0121	0.0099	0.0135	8
5/09/2024 0:00	0.0115	0.0099	0.0137	8
5/09/2024 0:15	0.0093	0.0094	0.0132	8
5/09/2024 0:30	0.005	0.0068	0.0096	8
5/09/2024 0:45				8
5/09/2024 1:00				8
5/09/2024 1:15	0.0074	0.0085	0.0137	8
5/09/2024 1:30				8
5/09/2024 1:45	0.0077	0.0093	0.0136	8
5/09/2024 2:00	0.0056	0.0082	0.0119	8
5/09/2024 2:15	0.007	0.0086	0.0129	8
5/09/2024 2:30	0.0067	0.009	0.0135	8
5/09/2024 2:45				8
5/09/2024 3:00	0.0065	0.0079	0.0128	8
5/09/2024 3:15				8
5/09/2024 3:30	0.007	0.0097	0.0154	8
5/09/2024 3:45	0.0071	0.0084	0.013	8
5/09/2024 4:00				8
5/09/2024 4:15	0.0079	0.0097	0.0135	8
5/09/2024 4:30	0.0069	0.0096	0.0142	8
5/09/2024 4:45	0.0114	0.0086	0.0138	8
5/09/2024 5:00	0.0071	0.0081	0.0133	8
5/09/2024 5:15	0.0131	0.0113	0.0142	8
5/09/2024 5:30	0.0121	0.0099	0.0135	8
5/09/2024 5:45	0.0089	0.0065	0.0104	8
5/09/2024 6:00	0.0117	0.0104	0.0145	8
5/09/2024 6:15	0.0059	0.0078	0.012	8
5/09/2024 6:30	0.0119	0.0093	0.0154	8
5/09/2024 6:45	0.012	0.0099	0.0131	8
5/09/2024 7:00	0.0103	0.0101	0.014	8
5/09/2024 7:15	0.0205	0.0268	0.0206	8
5/09/2024 7:30	0.0167	0.0156	0.0162	8
5/09/2024 7:45	0.0307	0.0457	0.0519	8
5/09/2024 8:00	0.0174	0.0255	0.0344	8
5/09/2024 8:15	0.0078	0.0085	0.0158	8
5/09/2024 8:30				8
5/09/2024 8:45				8
5/09/2024 9:00	0.0778	0.1085	0.1568	8
5/09/2024 9:15	0.0197	0.0271	0.0447	8
5/09/2024 9:30				8
5/09/2024 9:45	0.0504	0.0616	0.0867	8
5/09/2024 10:00	0.0186	0.0264	0.0762	8
5/09/2024 10:15	0.1571	0.1265	0.2152	8
5/09/2024 10:30	0.0142	0.0121	0.0161	8
5/09/2024 10:45	0.0083	0.0084	0.0123	8
5/09/2024 11:00	0.01	0.0138	0.0171	8
5/09/2024 11:15	0.0123	0.0104	0.0151	8
5/09/2024 11:30	0.0184	0.0213	0.0403	8
5/09/2024 11:45	0.0648	0.0565	0.1069	8
5/09/2024 12:00				8
5/09/2024 12:15	0.0805	0.1111	0.1537	8
5/09/2024 12:30	0.0943	0.1541	0.164	8
5/09/2024 12:45	0.0362	0.0349	0.0711	8
5/09/2024 13:00	0.0103	0.0114	0.017	8
5/09/2024 13:15	0.0085	0.0106	0.0154	8
5/09/2024 13:30	0.0099	0.0102	0.0163	8
5/09/2024 13:45	0.0121	0.0088	0.016	8
5/09/2024 14:00	0.0101	0.0118	0.0176	8
5/09/2024 14:15	0.0532	0.0921	0.0842	8
5/09/2024 14:30	0.0114	0.0153	0.0211	8
5/09/2024 14:45	0.0148	0.0136	0.0176	8
5/09/2024 15:00	0.0157	0.0162	0.0225	8
5/09/2024 15:15	0.0156	0.0213	0.0154	8
5/09/2024 15:30	0.0184	0.0136	0.0178	8
5/09/2024 15:45	0.0198	0.0293	0.0198	8
5/09/2024 16:00	0.0053	0.007	0.012	8
5/09/2024 16:15	0.011	0.0108	0.0153	8
5/09/2024 16:30	0.0083	0.0097	0.0145	8
5/09/2024 16:45	0.0093	0.0087	0.0203	8
5/09/2024 17:00	0.0076	0.0077	0.0134	8
5/09/2024 17:15	0.0084	0.0087	0.0143	8
5/09/2024 17:30	0.0085	0.0092	0.0134	8
5/09/2024 17:45	0.0075	0.0083	0.014	8
5/09/2024 18:00	0.0075	0.0074	0.0134	8
5/09/2024 18:15	0.0082	0.009	0.0135	8
5/09/2024 18:30	0.0052	0.0062	0.0095	8
5/09/2024 18:45	0.0094	0.0086	0.0125	8
5/09/2024 19:00	0.0081	0.0085	0.0121	8
5/09/2024 19:15				8
5/09/2024 19:30				8
5/09/2024 19:45	0.0067	0.0078	0.0117	8
5/09/2024 20:00	0.0073	0.0082	0.0131	8
5/09/2024 20:15	0.0072	0.0085	0.012	8
5/09/2024 20:30	0.0077	0.0085	0.0125	8
5/09/2024 20:45	0.0074	0.008	0.0122	8
5/09/2024 21:00	0.0097	0.0094	0.0131	8
5/09/2024 21:15	0.0091	0.0083	0.0123	8
5/09/2024 21:30	0.0058	0.006	0.0091	8
5/09/2024 21:45	0.0076	0.0085	0.0133	8
5/09/2024 22:00				8
5/09/2024 22:15				8
5/09/2024 22:30				8
5/09/2024 22:45	0.008	0.0088	0.0123	8
5/09/2024 23:00	0.0072	0.0076	0.0115	8
5/09/2024 23:15	0.0072	0.0089	0.0125	8
5/09/2024 23:30	0.0067	0.0086	0.0124	8
5/09/2024 23:45	0.0086	0.0088	0.0121	8
6/09/2024 0:00				8
6/09/2024 0:15				8
6/09/2024 0:30	0.0072	0.0092	0.0132	8
6/09/2024 0:45	0.0073	0.0081	0.013	8
6/09/2024 1:00	0.0048	0.0055	0.0092	8
6/09/2024 1:15				8
6/09/2024 1:30				8
6/09/2024 1:45	0.0072	0.0081	0.0126	8
6/09/2024 2:00	0.0071	0.0073	0.0115	8
6/09/2024 2:15				8
6/09/2024 2:30	0.0073	0.008	0.0125	8
6/09/2024 2:45				8
6/09/2024 3:00	0.008	0.0092	0.0131	8
6/09/2024 3:15	0.0052	0.0069	0.0102	8
6/09/2024 3:30				8
6/09/2024 3:45	0.0081	0.0087	0.0139	8
6/09/2024 4:00	0.0074	0.0091	0.0132	8
6/09/2024 4:15	0.005	0.0052	0.0107	8
6/09/2024 4:30	0.0083	0.0091	0.0139	8
6/09/2024 4:45	0.0109	0.0104	0.0128	8
6/09/2024 5:00	0.008	0.0092	0.0136	8
6/09/2024 5:15	0.0085	0.0096	0.0132	8
6/09/2024 5:30	0.0078	0.0091	0.0129	8
6/09/2024 5:45				8
6/09/2024 6:00	0.0074	0.009	0.0136	8
6/09/2024 6:15	0.0083	0.0082	0.0132	8
6/09/2024 6:30	0.009	0.0098	0.014	8
6/09/2024 6:45	0.0083	0.0091	0.0146	8
6/09/2024 7:00	0.0229	0.0371	0.0328	8
6/09/2024 7:15	0.0151	0.0225	0.0202	8
6/09/2024 7:30	0.0321	0.0624	0.0366	8
6/09/2024 7:45	0.0412	0.0508	0.0436	8
6/09/2024 8:00	0.0079	0.0087	0.0113	8
6/09/2024 8:15	0.0527	0.0715	0.1032	8
6/09/2024 8:30	0.0563	0.0624	0.0931	8
6/09/2024 8:45	0.0737	0.0603	0.1037	8
6/09/2024 9:00				8
6/09/2024 9:15	0.026	0.044	0.0323	8
6/09/2024 9:30	0.0069	0.0072	0.0138	8
6/09/2024 9:45	0.0128	0.0225	0.0245	8
6/09/2024 10:00	0.0077	0.0088	0.0148	8

6/09/2024 10:15	0.0131	0.0228	0.0309	8
6/09/2024 10:30	0.1193	0.1318	0.1465	8
6/09/2024 10:45	0.0283	0.0275	0.0326	8
6/09/2024 11:00	0.0899	0.0936	0.1177	8
6/09/2024 11:15	0.0443	0.0505	0.0766	8
6/09/2024 11:30	0.0143	0.0201	0.032	8
6/09/2024 11:45	0.0279	0.0273	0.0293	8
6/09/2024 12:00	0.0449	0.0578	0.0475	8
6/09/2024 12:15	0.0211	0.0312	0.0361	8
6/09/2024 12:30	0.0218	0.0253	0.026	8
6/09/2024 12:45	0.0129	0.0146	0.0236	8
6/09/2024 13:00	0.0147	0.0105	0.0179	8
6/09/2024 13:15	0.0111	0.0123	0.0224	8
6/09/2024 13:30	0.0129	0.0117	0.0245	8
6/09/2024 13:45	0.1706	0.1454	0.1395	8
6/09/2024 14:00	0.0547	0.0778	0.0511	8
6/09/2024 14:15	0.0237	0.0272	0.0708	8
6/09/2024 14:30	0.067	0.0767	0.0869	8
6/09/2024 14:45	0.0147	0.0183	0.0236	8
6/09/2024 15:00	0.047	0.0396	0.043	8
6/09/2024 15:15	0.0164	0.0192	0.0245	8
6/09/2024 15:30	0.0185	0.0273	0.0261	8
6/09/2024 15:45	0.0235	0.028	0.0202	8
6/09/2024 16:00	0.0238	0.0267	0.021	8
6/09/2024 16:15	0.0307	0.0277	0.0314	8
6/09/2024 16:30				8
6/09/2024 16:45	0.0085	0.0088	0.013	8
6/09/2024 17:00	0.0072	0.0089	0.0145	8
6/09/2024 17:15	0.0075	0.0089	0.0137	8
6/09/2024 17:30	0.0067	0.0069	0.0113	8
6/09/2024 17:45	0.0076	0.0089	0.0145	8
6/09/2024 18:00	0.0057	0.0058	0.0099	8
6/09/2024 18:15				8
6/09/2024 18:30	0.007	0.0078	0.0133	8
6/09/2024 18:45				8
6/09/2024 19:00	0.0079	0.0085	0.0127	8
6/09/2024 19:15				8
6/09/2024 19:30	0.0074	0.0081	0.0126	8
6/09/2024 19:45	0.0083	0.011	0.0128	8
6/09/2024 20:00				8
6/09/2024 20:15	0.0164	0.0162	0.0123	8
6/09/2024 20:30	0.0073	0.009	0.0124	8
6/09/2024 20:45	0.0076	0.0084	0.0136	8
6/09/2024 21:00	0.0058	0.0065	0.0107	8
6/09/2024 21:15				8
6/09/2024 21:30	0.0072	0.0083	0.0128	8
6/09/2024 21:45	0.0079	0.0084	0.0118	8
6/09/2024 22:00	0.0075	0.0077	0.0128	8
6/09/2024 22:15	0.0073	0.0093	0.015	8
6/09/2024 22:30	0.0068	0.009	0.0135	8
6/09/2024 22:45	0.0077	0.0079	0.013	8
6/09/2024 23:00	0.0075	0.0079	0.0124	8
6/09/2024 23:15	0.0062	0.0071	0.0116	8
6/09/2024 23:30	0.0082	0.0084	0.0123	8
6/09/2024 23:45	0.0075	0.0075	0.0121	8
7/09/2024 0:00	0.0073	0.0088	0.0128	8
7/09/2024 0:15	0.0073	0.0089	0.0129	8
7/09/2024 0:30	0.0087	0.0077	0.0133	8
7/09/2024 0:45	0.0049	0.005	0.0087	8
7/09/2024 1:00				8
7/09/2024 1:15				8
7/09/2024 1:30				8
7/09/2024 1:45	0.0077	0.0089	0.0127	8
7/09/2024 2:00	0.007	0.0084	0.0134	8
7/09/2024 2:15	0.0073	0.0082	0.0124	8
7/09/2024 2:30	0.0071	0.0085	0.013	8
7/09/2024 2:45	0.005	0.0059	0.0099	8
7/09/2024 3:00				8
7/09/2024 3:15				8
7/09/2024 3:30				8
7/09/2024 3:45	0.0073	0.0095	0.0131	8
7/09/2024 4:00				8
7/09/2024 4:15	0.0074	0.0085	0.013	8
7/09/2024 4:30	0.0068	0.0092	0.0121	8
7/09/2024 4:45				8
7/09/2024 5:00	0.008	0.0092	0.0126	8
7/09/2024 5:15	0.0076	0.0098	0.012	8
7/09/2024 5:30				8
7/09/2024 5:45	0.2178	0.1917	0.0719	8
7/09/2024 6:00	0.0487	0.0393	0.0544	8
7/09/2024 6:15				8
7/09/2024 6:30	0.0089	0.0085	0.0126	8
7/09/2024 6:45	0.0084	0.0092	0.0129	8
7/09/2024 7:00	0.0074	0.0086	0.0124	8
7/09/2024 7:15	0.0091	0.0109	0.0132	8
7/09/2024 7:30	0.0045	0.0054	0.0107	8
7/09/2024 7:45	0.0079	0.0098	0.0165	8
7/09/2024 8:00	0.0069	0.0088	0.014	8
7/09/2024 8:15	0.0077	0.008	0.0131	8
7/09/2024 8:30	0.0072	0.0084	0.0132	8
7/09/2024 8:45	0.0123	0.017	0.0228	8
7/09/2024 9:00	0.0078	0.0102	0.0142	8
7/09/2024 9:15	0.0077	0.0092	0.0133	8
7/09/2024 9:30				8
7/09/2024 9:45	0.0081	0.0097	0.0143	8
7/09/2024 10:00	0.009	0.0082	0.0147	8
7/09/2024 10:15	0.0156	0.0208	0.0141	8
7/09/2024 10:30	0.0196	0.0277	0.0249	8
7/09/2024 10:45	0.0058	0.0067	0.0101	8
7/09/2024 11:00				8
7/09/2024 11:15	0.0083	0.0095	0.0141	8
7/09/2024 11:30				8
7/09/2024 11:45				8
7/09/2024 12:00	0.01	0.0126	0.0168	8
7/09/2024 12:15	0.0083	0.0101	0.0155	8
7/09/2024 12:30	0.01	0.0125	0.0233	8
7/09/2024 12:45	0.0123	0.0174	0.0195	8
7/09/2024 13:00	0.0107	0.0132	0.0174	8
7/09/2024 13:15	0.0141	0.0148	0.0154	8
7/09/2024 13:30	0.0054	0.0054	0.0103	8
7/09/2024 13:45	0.0087	0.01	0.0146	8
7/09/2024 14:00	0.0072	0.0083	0.0139	8
7/09/2024 14:15	0.0085	0.0109	0.0126	8
7/09/2024 14:30	0.0085	0.0088	0.0129	8
7/09/2024 14:45	0.0088	0.0093	0.0133	8
7/09/2024 15:00	0.0049	0.0061	0.0098	8
7/09/2024 15:15	0.0074	0.0085	0.0129	8
7/09/2024 15:30	0.0055	0.0064	0.009	8
7/09/2024 15:45	0.0078	0.0087	0.0125	8
7/09/2024 16:00	0.0086	0.0088	0.013	8
7/09/2024 16:15	0.0075	0.0091	0.0125	8
7/09/2024 16:30	0.0079	0.0092	0.0118	8
7/09/2024 16:45	0.0083	0.0089	0.0121	8
7/09/2024 17:00	0.0078	0.0086	0.012	8
7/09/2024 17:15	0.0078	0.0081	0.0121	8
7/09/2024 17:30	0.0063	0.0066	0.0117	8
7/09/2024 17:45	0.009	0.0092	0.0125	8
7/09/2024 18:00	0.008	0.0078	0.0124	8
7/09/2024 18:15	0.0077	0.0082	0.0128	8
7/09/2024 18:30	0.0088	0.0087	0.0137	8
7/09/2024 18:45	0.0082	0.0087	0.012	8
7/09/2024 19:00	0.0084	0.008	0.0121	8
7/09/2024 19:15	0.0077	0.0087	0.0125	8
7/09/2024 19:30	0.0073	0.0083	0.0125	8
7/09/2024 19:45				8
7/09/2024 20:00	0.008	0.0084	0.0118	8
7/09/2024 20:15	0.0079	0.0087	0.0112	8
7/09/2024 20:30	0.0084	0.0095	0.0117	8
7/09/2024 20:45	0.0059	0.0058	0.0079	8
7/09/2024 21:00				8
7/09/2024 21:15	0.0078	0.008	0.0117	8
7/09/2024 21:30	0.0073	0.0083	0.0117	8

7/09/2024 21:45				8
7/09/2024 22:00	0.0075	0.0087	0.0121	8
7/09/2024 22:15	0.0045	0.0062	0.0089	8
7/09/2024 22:30	0.0085	0.0088	0.0121	8
7/09/2024 22:45	0.0056	0.0058	0.009	8
7/09/2024 23:00	0.0087	0.0088	0.0116	8
7/09/2024 23:15	0.0068	0.0058	0.0088	8
7/09/2024 23:30	0.0095	0.0085	0.0119	8
7/09/2024 23:45				8
8/09/2024 0:00				8
8/09/2024 0:15				8
8/09/2024 0:30				8
8/09/2024 0:45	0.0098	0.0085	0.0114	8
8/09/2024 1:00	0.0048	0.0051	0.009	8
8/09/2024 1:15	0.0088	0.0088	0.0111	8
8/09/2024 1:30	0.0079	0.0083	0.0112	8
8/09/2024 1:45	0.0078	0.008	0.0119	8
8/09/2024 2:00	0.0076	0.0088	0.0121	8
8/09/2024 2:15	0.0064	0.0062	0.0088	8
8/09/2024 2:30	0.0075	0.0081	0.0114	8
8/09/2024 2:45	0.0071	0.0058	0.0081	8
8/09/2024 3:00	0.0084	0.008	0.0119	8
8/09/2024 3:15	0.0078	0.0083	0.0122	8
8/09/2024 3:30	0.0065	0.0062	0.0087	8
8/09/2024 3:45	0.0082	0.0085	0.0121	8
8/09/2024 4:00	0.0086	0.0084	0.013	8
8/09/2024 4:15	0.0077	0.0082	0.0115	8
8/09/2024 4:30	0.0078	0.0078	0.0131	8
8/09/2024 4:45	0.0088	0.0089	0.0137	8
8/09/2024 5:00	0.0079	0.0081	0.0126	8
8/09/2024 5:15	0.0069	0.0085	0.0115	8
8/09/2024 5:30				8
8/09/2024 5:45	0.0096	0.0105	0.0121	8
8/09/2024 6:00				8
8/09/2024 6:15	0.0088	0.0085	0.012	8
8/09/2024 6:30	0.008	0.0091	0.0122	8
8/09/2024 6:45	0.0056	0.0067	0.0089	8
8/09/2024 7:00				8
8/09/2024 7:15	0.009	0.0083	0.0121	8
8/09/2024 7:30	0.0093	0.0084	0.012	8
8/09/2024 7:45	0.0079	0.0084	0.0123	8
8/09/2024 8:00	0.0076	0.0084	0.0125	8
8/09/2024 8:15	0.0083	0.0093	0.0136	8
8/09/2024 8:30	0.0084	0.0091	0.0135	8
8/09/2024 8:45	0.0074	0.0081	0.0131	8
8/09/2024 9:00	0.008	0.0093	0.014	8
8/09/2024 9:15	0.0076	0.0086	0.0133	8
8/09/2024 9:30	0.0087	0.0094	0.0136	8
8/09/2024 9:45	0.0075	0.008	0.0144	8
8/09/2024 10:00	0.0076	0.0086	0.0135	8
8/09/2024 10:15	0.008	0.0092	0.0134	8
8/09/2024 10:30	0.0079	0.0091	0.0148	8
8/09/2024 10:45	0.0083	0.0084	0.0141	8
8/09/2024 11:00	0.0078	0.0087	0.0137	8
8/09/2024 11:15	0.0073	0.009	0.015	8
8/09/2024 11:30	0.0078	0.0092	0.0136	8
8/09/2024 11:45	0.0077	0.0081	0.013	8
8/09/2024 12:00	0.0088	0.0101	0.0128	8
8/09/2024 12:15	0.0073	0.0088	0.0133	8
8/09/2024 12:30				8
8/09/2024 12:45	0.0068	0.0079	0.0133	8
8/09/2024 13:00	0.0089	0.0083	0.0135	8
8/09/2024 13:15	0.0054	0.0064	0.0104	8
8/09/2024 13:30	0.0075	0.009	0.0134	8
8/09/2024 13:45	0.0072	0.0085	0.0127	8
8/09/2024 14:00				8
8/09/2024 14:15				8
8/09/2024 14:30	0.01	0.009	0.0138	8
8/09/2024 14:45	0.0079	0.0089	0.0153	8
8/09/2024 15:00	0.007	0.0088	0.0143	8
8/09/2024 15:15	0.0087	0.0098	0.0134	8
8/09/2024 15:30				8
8/09/2024 15:45				8
8/09/2024 16:00	0.0077	0.0094	0.0138	8
8/09/2024 16:15	0.0078	0.0083	0.0129	8
8/09/2024 16:30				8
8/09/2024 16:45				8
8/09/2024 17:00	0.007	0.0084	0.013	8
8/09/2024 17:15	0.0074	0.0083	0.016	8
8/09/2024 17:30	0.0083	0.009	0.0128	8
8/09/2024 17:45	0.0054	0.007	0.0084	8
8/09/2024 18:00				8
8/09/2024 18:15	0.0073	0.009	0.0124	8
8/09/2024 18:30	0.008	0.0097	0.0124	8
8/09/2024 18:45	0.0068	0.009	0.0119	8
8/09/2024 19:00	0.0096	0.0086	0.0121	8
8/09/2024 19:15	0.0098	0.0092	0.0135	8
8/09/2024 19:30	0.0074	0.009	0.0126	8
8/09/2024 19:45	0.0083	0.0093	0.0116	8
8/09/2024 20:00	0.0076	0.0086	0.0125	8
8/09/2024 20:15	0.0051	0.0059	0.0092	8
8/09/2024 20:30	0.0104	0.0089	0.0125	8
8/09/2024 20:45				8
8/09/2024 21:00	0.0072	0.0085	0.0123	8
8/09/2024 21:15				8
8/09/2024 21:30				8
8/09/2024 21:45	0.0076	0.0086	0.0126	8
8/09/2024 22:00	0.0054	0.0066	0.0099	8
8/09/2024 22:15				8
8/09/2024 22:30				8
8/09/2024 22:45	0.0075	0.0086	0.0128	8
8/09/2024 23:00				8
8/09/2024 23:15	0.0092	0.0084	0.0131	8
8/09/2024 23:30	0.0083	0.0083	0.0126	8
8/09/2024 23:45				8
9/09/2024 0:00	0.0072	0.0091	0.013	8
9/09/2024 0:15				8
9/09/2024 0:30	0.0069	0.0094	0.0135	8
9/09/2024 0:45	0.0071	0.0094	0.0138	8
9/09/2024 1:00	0.0068	0.0083	0.0133	8
9/09/2024 1:15				8
9/09/2024 1:30	0.0076	0.0096	0.0134	8
9/09/2024 1:45	0.0067	0.0086	0.0136	8
9/09/2024 2:00				8
9/09/2024 2:15				8
9/09/2024 2:30	0.0077	0.01	0.0149	8
9/09/2024 2:45				8
9/09/2024 3:00	0.0069	0.0088	0.0129	8
9/09/2024 3:15				8
9/09/2024 3:30	0.007	0.0084	0.0137	8
9/09/2024 3:45	0.0069	0.0077	0.0138	8
9/09/2024 4:00	0.0076	0.0102	0.0131	8
9/09/2024 4:15				8
9/09/2024 4:30	0.0068	0.0081	0.0142	8
9/09/2024 4:45	0.0076	0.0095	0.0139	8
9/09/2024 5:00	0.0076	0.0099	0.0142	8
9/09/2024 5:15	0.0046	0.0057	0.0099	8
9/09/2024 5:30	0.0072	0.0081	0.0129	8
9/09/2024 5:45	0.0079	0.0093	0.0144	8
9/09/2024 6:00	0.0062	0.0091	0.0126	8
9/09/2024 6:15	0.0075	0.0096	0.014	8
9/09/2024 6:30	0.0061	0.007	0.0126	8
9/09/2024 6:45	0.0094	0.0099	0.015	8
9/09/2024 7:00	0.0053	0.0072	0.0106	8
9/09/2024 7:15	0.0079	0.009	0.0134	8
9/09/2024 7:30	0.0079	0.0102	0.0131	8
9/09/2024 7:45	0.0079	0.0091	0.0134	8
9/09/2024 8:00	0.0474	0.0847	0.0704	8
9/09/2024 8:15	0.0055	0.0046	0.0069	8
9/09/2024 8:30	0.0444	0.0526	0.0455	8
9/09/2024 8:45				8
9/09/2024 9:00	0.0714	0.0805	0.0619	8

9/09/2024 9:15	0.0093	0.0109	0.0135	8
9/09/2024 9:30				8
9/09/2024 9:45	0.0362	0.0268	0.0346	8
9/09/2024 10:00	0.0124	0.0098	0.0145	8
9/09/2024 10:30				8
9/09/2024 10:45				8
9/09/2024 11:00				8
9/09/2024 11:30	0.0294	0.0522	0.0354	8
9/09/2024 13:15				8
9/09/2024 13:30	0.0474	0.0499	0.0533	8
9/09/2024 13:45	0.0187	0.0283	0.0228	8
9/09/2024 14:00	0.0509	0.0448	0.0404	8
9/09/2024 14:15	0.0137	0.021	0.0187	8
9/09/2024 14:30	0.0114	0.0202	0.0182	8
9/09/2024 14:45	0.019	0.025	0.0265	8
9/09/2024 15:00	0.0305	0.0388	0.0241	8
9/09/2024 15:30	0.0365	0.0535	0.0496	8
9/09/2024 15:45	0.0289	0.0303	0.0212	8
9/09/2024 16:00				8
9/09/2024 16:30	0.0082	0.008	0.0137	8
9/09/2024 16:45	0.0111	0.0083	0.0174	8
9/09/2024 17:00				8
9/09/2024 17:15				8
9/09/2024 17:30	0.0072	0.0077	0.0117	8
9/09/2024 17:45	0.0078	0.008	0.0123	8
9/09/2024 18:00				8
9/09/2024 18:15				8
9/09/2024 18:30	0.0075	0.0104	0.0124	8
9/09/2024 18:45	0.007	0.0078	0.0119	8
9/09/2024 19:00				8
9/09/2024 19:30				8
9/09/2024 19:45				8
9/09/2024 20:30	0.0078	0.0087	0.0109	8
9/09/2024 20:45				8
9/09/2024 21:00	0.0073	0.0075	0.0113	8
9/09/2024 21:15	0.007	0.0092	0.0119	8
9/09/2024 21:45				8
9/09/2024 23:15	0.0073	0.0082	0.0107	8
10/09/2024 0:30	0.0088	0.0075	0.0115	8
10/09/2024 2:15	0.007	0.0075	0.0123	8
10/09/2024 3:15	0.007	0.0077	0.0121	8
10/09/2024 5:00	0.0079	0.0089	0.0133	8
10/09/2024 5:30	0.0079	0.0088	0.0134	8
10/09/2024 5:45	0.0079	0.0084	0.0132	8
10/09/2024 6:00	0	0	0	8
10/09/2024 6:15	0	0	0	8
10/09/2024 6:30	0	0	0	8
10/09/2024 6:45	0	0	0	8
10/09/2024 7:00	0	0	0	8
10/09/2024 7:15	0	0	0	8
10/09/2024 7:30	0	0	0	8
10/09/2024 7:45	0	0	0	8
10/09/2024 8:00	0	0	0	8
10/09/2024 8:15	0	0	0	8
10/09/2024 8:30	0	0	0	8
10/09/2024 8:45	0	0	0	8
10/09/2024 9:00	0	0	0	8
10/09/2024 9:15	0	0	0	8
10/09/2024 9:30	0	0	0	8
10/09/2024 9:45	0	0	0	8
10/09/2024 10:00	0	0	0	8
10/09/2024 10:15	0	0	0	8
10/09/2024 10:30	0	0	0	8
10/09/2024 10:45	0	0	0	8
10/09/2024 11:00	0	0	0	8
10/09/2024 11:15	0	0	0	8
10/09/2024 11:30	0	0	0	8
10/09/2024 11:45	0	0	0	8
10/09/2024 12:00	0	0	0	8
10/09/2024 12:15	0	0	0	8
10/09/2024 12:30	0	0	0	8
10/09/2024 12:45	0	0	0	8
10/09/2024 13:00	0	0	0	8
10/09/2024 13:15	0	0	0	8
10/09/2024 13:30	0	0	0	8
10/09/2024 13:45	0	0	0	8
10/09/2024 14:00	0	0	0	8
10/09/2024 14:15	0	0	0	8
10/09/2024 14:30	0	0	0	8
10/09/2024 14:45	0	0	0	8
10/09/2024 15:00	0	0	0	8
10/09/2024 15:15	0	0	0	8
10/09/2024 15:30	0	0	0	8
10/09/2024 15:45	0	0	0	8
10/09/2024 16:00	0	0	0	8
10/09/2024 16:15	0	0	0	8
10/09/2024 16:30	0	0	0	8
10/09/2024 16:45	0	0	0	8
10/09/2024 17:00	0	0	0	8
10/09/2024 17:15	0	0	0	8
10/09/2024 17:30	0	0	0	8
10/09/2024 17:45	0	0	0	8
10/09/2024 18:00	0	0	0	8
10/09/2024 18:15	0	0	0	8
10/09/2024 18:30	0	0	0	8
10/09/2024 18:45	0	0	0	8
10/09/2024 19:00	0	0	0	8
10/09/2024 19:15	0	0	0	8
10/09/2024 19:30	0	0	0	8
10/09/2024 19:45	0	0	0	8
10/09/2024 20:00	0	0	0	8
10/09/2024 20:15	0	0	0	8
10/09/2024 20:30	0	0	0	8
10/09/2024 20:45	0	0	0	8
10/09/2024 21:00	0	0	0	8
10/09/2024 21:15	0	0	0	8
10/09/2024 21:30	0	0	0	8
10/09/2024 21:45	0	0	0	8
10/09/2024 22:00	0	0	0	8
10/09/2024 22:15	0	0	0	8
10/09/2024 22:30	0	0	0	8
10/09/2024 22:45	0	0	0	8
10/09/2024 23:00	0	0	0	8
10/09/2024 23:15	0	0	0	8
10/09/2024 23:30	0	0	0	8
10/09/2024 23:45	0	0	0	8
11/09/2024 0:00	0	0	0	8
11/09/2024 0:15	0	0	0	8
11/09/2024 0:30	0	0	0	8
11/09/2024 0:45	0	0	0	8
11/09/2024 1:00	0	0	0	8
11/09/2024 1:15	0	0	0	8
11/09/2024 1:30	0	0	0	8
11/09/2024 1:45	0	0	0	8
11/09/2024 2:00	0	0	0	8
11/09/2024 2:15	0	0	0	8
11/09/2024 2:30	0	0	0	8
11/09/2024 2:45	0	0	0	8
11/09/2024 3:00	0	0	0	8
11/09/2024 3:15	0	0	0	8
11/09/2024 3:30	0	0	0	8
11/09/2024 3:45	0	0	0	8
11/09/2024 4:00	0	0	0	8
11/09/2024 4:15	0	0	0	8
11/09/2024 4:30	0	0	0	8
11/09/2024 4:45	0	0	0	8
11/09/2024 5:00	0	0	0	8
11/09/2024 5:15	0	0	0	8
11/09/2024 5:30	0	0	0	8
11/09/2024 5:45	0	0	0	8
11/09/2024 6:00	0	0	0	8
11/09/2024 6:15	0	0	0	8

29/09/2024 4:00	0	0	0	8
29/09/2024 4:15	0	0	0	8
29/09/2024 4:30	0	0	0	8
29/09/2024 4:45	0	0	0	8
29/09/2024 5:00	0	0	0	8
29/09/2024 5:15	0	0	0	8
29/09/2024 5:30	0	0	0	8
29/09/2024 5:45	0	0	0	8
29/09/2024 6:00	0	0	0	8
29/09/2024 6:15	0	0	0	8
29/09/2024 6:30	0	0	0	8
29/09/2024 6:45	0	0	0	8
29/09/2024 7:00	0	0	0	8
29/09/2024 7:15	0	0	0	8
29/09/2024 7:30	0	0	0	8
29/09/2024 7:45	0	0	0	8
29/09/2024 8:00	0	0	0	8
29/09/2024 8:15	0	0	0	8
29/09/2024 8:30	0	0	0	8
29/09/2024 8:45	0	0	0	8
29/09/2024 9:00	0	0	0	8
29/09/2024 9:15	0	0	0	8
29/09/2024 9:30	0	0	0	8
29/09/2024 9:45	0	0	0	8
29/09/2024 10:00	0	0	0	8
29/09/2024 10:15	0	0	0	8
29/09/2024 10:30	0	0	0	8
29/09/2024 10:45	0	0	0	8
29/09/2024 11:00	0	0	0	8
29/09/2024 11:15	0	0	0	8
29/09/2024 11:30	0	0	0	8
29/09/2024 11:45	0	0	0	8
29/09/2024 12:00	0	0	0	8
29/09/2024 12:15	0	0	0	8
29/09/2024 12:30	0	0	0	8
29/09/2024 12:45	0	0	0	8
29/09/2024 13:00	0	0	0	8
29/09/2024 13:15	0	0	0	8
29/09/2024 13:30	0	0	0	8
29/09/2024 13:45	0	0	0	8
29/09/2024 14:00	0	0	0	8
29/09/2024 14:15	0	0	0	8
29/09/2024 14:30	0	0	0	8
29/09/2024 14:45	0	0	0	8
29/09/2024 15:00	0	0	0	8
29/09/2024 15:15	0	0	0	8
29/09/2024 15:30	0	0	0	8
29/09/2024 15:45	0	0	0	8
29/09/2024 16:00	0	0	0	8
29/09/2024 16:15	0	0	0	8
29/09/2024 16:30	0	0	0	8
29/09/2024 16:45	0	0	0	8
29/09/2024 17:00	0	0	0	8
29/09/2024 17:15	0	0	0	8
29/09/2024 17:30	0	0	0	8
29/09/2024 17:45	0	0	0	8
29/09/2024 18:00	0	0	0	8
29/09/2024 18:15	0	0	0	8
29/09/2024 18:30	0	0	0	8
29/09/2024 18:45	0	0	0	8
29/09/2024 19:00	0	0	0	8
29/09/2024 19:15	0	0	0	8
29/09/2024 19:30	0	0	0	8
29/09/2024 19:45	0	0	0	8
29/09/2024 20:00	0	0	0	8
29/09/2024 20:15	0	0	0	8
29/09/2024 20:30	0	0	0	8
29/09/2024 20:45	0	0	0	8
29/09/2024 21:00	0	0	0	8
29/09/2024 21:15	0	0	0	8
29/09/2024 21:30	0	0	0	8
29/09/2024 21:45	0	0	0	8
29/09/2024 22:00	0	0	0	8
29/09/2024 22:15	0	0	0	8
29/09/2024 22:30	0	0	0	8
29/09/2024 22:45	0	0	0	8
29/09/2024 23:00	0	0	0	8
29/09/2024 23:15	0	0	0	8
29/09/2024 23:30	0	0	0	8
29/09/2024 23:45	0	0	0	8

Monitoring Locations: Three monitoring locations have been selected as shown in Figure 1 below
Level 2 Noise Monitor: KR Level 2 Zone 6
Level 2 Vibration Monitor: KR Level 2 Zone 6
Level 3 Vibration Monitor: SAM HD Lab
Equipment: B&K 3680C S/N 3117889 with geophone S26
Settings: DIN 4150-3 (1-315 Hz)
Calibration Date: 22/05/2024 (valid for 24 months)
Data Sample Interval: 15 mins

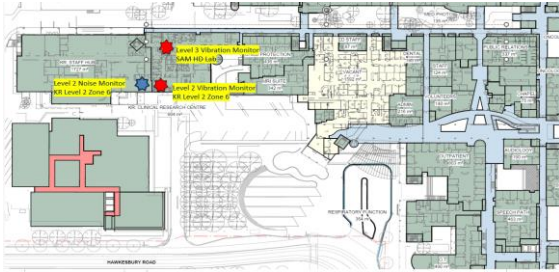
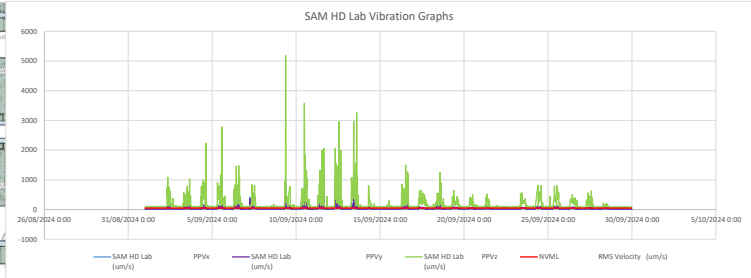

Figure 1: Noise & Vibration monitoring locations



Noise and Vibration Management Levels

Level 2 Noise Monitor	KR Level 2 Zone 6	L _{Aeq} , 15min=63dB
Level 2 Vibration Monitor	KR Level 2 Zone 6	DIN 4150-3 PPV -8mm/s
Level 3 Vibration Monitor**	SAM HD Lab	VC-A Curve PPV -50um/s

**Note: Vibration alerts will generate within the frequency range of 4-80Hz

Date/Time	SAM HD Lab PPVx (um/s)	SAM HD Lab PPVy (um/s)	SAM HD Lab PPVz (um/s)	NVWL RMS Velocity (um/s)
1/09/2024 0:00	15	16.4	97.2	50
1/09/2024 0:15	14.1	15.6	94.9	50
1/09/2024 0:30	14.3	16.9	90.5	50
1/09/2024 0:45	15.2	14.7	106.9	50
1/09/2024 1:00	15.4	14.8	93.8	50
1/09/2024 1:15	14.5	14.5	94.6	50
1/09/2024 1:30	15.2	14.5	94.9	50
1/09/2024 1:45	15	15.2	97.6	50
1/09/2024 2:00	15.6	14.1	94.1	50
1/09/2024 2:15	13.9	15	91.2	50
1/09/2024 2:30	14.2	15	95.6	50
1/09/2024 2:45	13.7	15.2	89.8	50
1/09/2024 3:00	14.1	14.4	94.3	50
1/09/2024 3:15	16	14.8	89.7	50
1/09/2024 3:30	14	15.2	91.9	50
1/09/2024 3:45	14.5	15.5	102.5	50
1/09/2024 4:00	14.5	14.7	87.5	50
1/09/2024 4:15	14.6	16.3	94.5	50
1/09/2024 4:30	15.8	14.3	96.7	50
1/09/2024 4:45	13.7	16.1	99	50
1/09/2024 5:00	14.3	16.1	103.6	50
1/09/2024 5:15	15.1	15.1	95.3	50
1/09/2024 5:30	14.1	15.2	91.6	50
1/09/2024 5:45	15.1	14.8	91.5	50
1/09/2024 6:00	15.7	15	96.6	50
1/09/2024 6:15	16.2	15.7	90.5	50
1/09/2024 6:30	18	14.7	99.2	50
1/09/2024 6:45	15.9	16	94.6	50
1/09/2024 7:00	15.2	14.1	89	50
1/09/2024 7:15	16.9	16.2	91.6	50
1/09/2024 7:30	19	15.7	90.3	50
1/09/2024 7:45	16.2	17.6	97.1	50
1/09/2024 8:00	16	16.2	92.8	50
1/09/2024 8:15	18.2	17	92.4	50
1/09/2024 8:30	20.4	16.4	101	50
1/09/2024 8:45	16.8	15.7	91.5	50
1/09/2024 9:00	17.4	16.9	88.6	50
1/09/2024 9:15	18.1	17.5	92	50
1/09/2024 9:30	16.3	16.7	88	50
1/09/2024 9:45	15.6	17.9	99.5	50
1/09/2024 10:00	21	19.3	83.6	50
1/09/2024 10:15	15.5	17.4	96.8	50
1/09/2024 10:30	17	15.8	95.3	50
1/09/2024 10:45	15.2	17.3	92.3	50
1/09/2024 11:00	16.2	18.4	99.9	50
1/09/2024 11:15	15.2	17.6	93.3	50
1/09/2024 11:30	15.3	18.5	101.2	50
1/09/2024 11:45	17	18.2	90.3	50
1/09/2024 12:00	17.9	19.8	95.2	50
1/09/2024 12:15	17.3	19.2	93.8	50
1/09/2024 12:30	17.9	19.4	94.3	50
1/09/2024 12:45	16.9	16.8	92.4	50
1/09/2024 13:00	18.6	17	100.5	50
1/09/2024 13:15	15.2	17.2	92.2	50
1/09/2024 13:30	17.4	17.2	91.6	50
1/09/2024 13:45	14.4	16.8	87	50
1/09/2024 14:00	15.6	16	95.5	50
1/09/2024 14:15	15.3	16.4	104.6	50
1/09/2024 14:30	15.4	15.8	89.9	50
1/09/2024 14:45	15.4	17.6	97.8	50
1/09/2024 15:00	15.7	18.7	102.7	50
1/09/2024 15:15	15.3	16.3	106.1	50
1/09/2024 15:30	16.9	16.6	105.5	50
1/09/2024 15:45	16.2	17.6	89.8	50
1/09/2024 16:00	15	15	97.2	50
1/09/2024 16:15	16	15.2	108.3	50
1/09/2024 16:30	16.2	18.4	94.6	50
1/09/2024 16:45	17.2	16.1	95.9	50
1/09/2024 17:00	15.4	14.7	93.6	50
1/09/2024 17:15	16.7	15.2	97.6	50
1/09/2024 17:30	15.7	15.4	93.4	50
1/09/2024 17:45	16.6	17.8	96	50
1/09/2024 18:00	14.7	18.4	100.3	50
1/09/2024 18:15	15.5	15.4	89.1	50
1/09/2024 18:30	18.4	14.8	95	50
1/09/2024 18:45	15.4	16.7	93.8	50
1/09/2024 19:00	15.4	15.3	93.4	50
1/09/2024 19:15	15.8	14.5	91.5	50
1/09/2024 19:30	14.6	15.4	91.3	50
1/09/2024 19:45	15.1	14.6	86.1	50
1/09/2024 20:00	17.9	15.4	96.2	50
1/09/2024 20:15	15	13.9	100.7	50
1/09/2024 20:30	16.2	15.1	87.6	50
1/09/2024 20:45	14.9	13.1	88	50
1/09/2024 21:00	15.3	14.6	89.1	50
1/09/2024 21:15	15.8	15.2	90.9	50
1/09/2024 21:30	14.9	12.6	97.7	50
1/09/2024 21:45	16.1	14.7	92.5	50
1/09/2024 22:00	15.6	13.5	96.7	50
1/09/2024 22:15	18.1	14.9	97	50
1/09/2024 22:30	15.8	14.7	93.4	50
1/09/2024 22:45	15.5	14.3	95.9	50
1/09/2024 23:00	17.8	14.1	95.8	50
1/09/2024 23:15	17.4	14.5	93.5	50
1/09/2024 23:30	14.9	14.1	86.6	50
1/09/2024 23:45	14.9	14.7	106.4	50

2/09/2024 0:00	15	13.7	89.6	50
2/09/2024 0:15	15.9	15	91.5	50
2/09/2024 0:30	13.9	16.2	93.9	50
2/09/2024 0:45	16.1	15.3	91	50
2/09/2024 1:00	16.1	14.8	90.8	50
2/09/2024 1:15	27.2	15	88.6	50
2/09/2024 1:30	16.5	15.1	91.7	50
2/09/2024 1:45	15.3	16.8	89	50
2/09/2024 2:00	14.2	14.2	87.5	50
2/09/2024 2:15	19.7	14.3	86.8	50
2/09/2024 2:30	16.1	16.2	94.1	50
2/09/2024 2:45	14.6	14.9	88.9	50
2/09/2024 3:00	14	14.4	109	50
2/09/2024 3:15	14.4	15.3	96	50
2/09/2024 3:30	14	14.3	98	50
2/09/2024 3:45	14.3	15.1	94.3	50
2/09/2024 4:00	16.4	15.8	107.2	50
2/09/2024 4:15	17.5	15.6	94.2	50
2/09/2024 4:30	14.7	13.7	91.7	50
2/09/2024 4:45	16.7	14.7	95.3	50
2/09/2024 5:00	16.8	14.7	91	50
2/09/2024 5:15	14.6	15.9	89.6	50
2/09/2024 5:30	15.2	14.9	94.8	50
2/09/2024 5:45	17.3	16.1	93.3	50
2/09/2024 6:00	16.5	17.3	106.3	50
2/09/2024 6:15	15.4	17.1	92	50
2/09/2024 6:30	15.5	16.9	91.9	50
2/09/2024 6:45	16.6	18.3	91.8	50
2/09/2024 7:00	17.4	17.1	96.4	50
2/09/2024 7:15	30.6	32	99.2	50
2/09/2024 7:30	88.6	90.3	737.2	50
2/09/2024 7:45	67.9	82.4	413.8	50
2/09/2024 8:00	58.5	49.4	515.1	50
2/09/2024 8:15	87	60.5	711.7	50
2/09/2024 8:30	194.8	135.3	1089.9	50
2/09/2024 8:45	54.1	64.6	327.5	50
2/09/2024 9:00	25.9	26.9	165.2	50
2/09/2024 9:15	23.7	23.2	145.8	50
2/09/2024 9:30	40.8	31.8	123.4	50
2/09/2024 9:45	56.2	38	249.8	50
2/09/2024 10:00	21.7	21.1	167	50
2/09/2024 10:15	26.5	24.4	146.7	50
2/09/2024 10:30	100.9	51.1	755	50
2/09/2024 10:45	70.2	77.4	591.5	50
2/09/2024 11:00	54.5	45.9	482.1	50
2/09/2024 11:15	28.1	23.5	184.3	50
2/09/2024 11:30	21.3	28.2	168.3	50
2/09/2024 11:45	76	48.5	379.5	50
2/09/2024 12:00	144.9	89.8	628.4	50
2/09/2024 12:15	56.2	62.1	289.7	50
2/09/2024 12:30	55.2	59.7	395.3	50
2/09/2024 12:45	23.9	25.1	167.2	50
2/09/2024 13:00	25.9	35.9	109.4	50
2/09/2024 13:15	23.5	23.3	123.4	50
2/09/2024 13:30	24.6	22.5	179.3	50
2/09/2024 13:45	23.2	21.1	135.6	50
2/09/2024 14:00	35.5	29.1	151.1	50
2/09/2024 14:15	25.8	27.7	146.8	50
2/09/2024 14:30	24	24.9	141.8	50
2/09/2024 14:45	19.2	20.2	139.4	50
2/09/2024 15:00	23	18.2	107	50
2/09/2024 15:15	22.5	31.9	214.4	50
2/09/2024 15:30	21.5	21.2	135.6	50
2/09/2024 15:45	22.5	26.4	261.4	50
2/09/2024 16:00	39.1	44.7	370.4	50
2/09/2024 16:15	21.4	21.4	291.9	50
2/09/2024 16:30	21	19	144.7	50
2/09/2024 16:45	18.5	18.5	117	50
2/09/2024 17:00	19.2	18.9	141	50
2/09/2024 17:15	15.3	15.5	98.6	50
2/09/2024 17:30	19.2	14.9	98.9	50
2/09/2024 17:45	16.7	17.5	96.1	50
2/09/2024 18:00	19.7	16.3	98.2	50
2/09/2024 18:15	16.8	15.2	99.4	50
2/09/2024 18:30	17.3	16.1	105.6	50
2/09/2024 18:45	16.3	15	102.6	50
2/09/2024 19:00	16.9	17	123.5	50
2/09/2024 19:15	16.7	15.6	98.1	50
2/09/2024 19:30	15.7	15.2	103.7	50
2/09/2024 19:45	16.7	15.4	96.2	50
2/09/2024 20:00	16.6	15.4	120.3	50
2/09/2024 20:15	16.3	15.3	94.2	50
2/09/2024 20:30	17	14.4	101.2	50
2/09/2024 20:45	16.8	14.8	127.7	50
2/09/2024 21:00	16.5	16.5	90.2	50
2/09/2024 21:15	14.9	15.3	96.4	50
2/09/2024 21:30	20.4	16.6	90.2	50
2/09/2024 21:45	19.7	17.2	91.4	50
2/09/2024 22:00	16.1	17.2	94.1	50
2/09/2024 22:15	15.5	14.5	92.2	50
2/09/2024 22:30	15.4	14.6	102.2	50
2/09/2024 22:45	16.6	16	91.6	50
2/09/2024 23:00	16.4	19.3	97.3	50
2/09/2024 23:15	15.1	17.1	94.7	50
2/09/2024 23:30	17.5	16	94.1	50
2/09/2024 23:45	14.5	17.2	102.8	50
3/09/2024 0:00	15	16.9	99.8	50
3/09/2024 0:15	14.9	16.1	95.4	50
3/09/2024 0:30	15	15.2	102	50
3/09/2024 0:45	15.5	14.8	92.2	50
3/09/2024 1:00	15.9	16.1	99.6	50
3/09/2024 1:15	15.3	16.2	93.2	50
3/09/2024 1:30	14.9	15.9	106.2	50
3/09/2024 1:45	14	20.3	91.5	50
3/09/2024 2:00	16.6	16.5	105.6	50
3/09/2024 2:15	14.6	16.6	101.7	50
3/09/2024 2:30	15	15.2	89.8	50
3/09/2024 2:45	16.6	15.8	93.8	50
3/09/2024 3:00	16.8	15.5	90.1	50
3/09/2024 3:15	14.1	15.6	97	50
3/09/2024 3:30	15.2	17.1	90.9	50
3/09/2024 3:45	15.5	17.2	95	50
3/09/2024 4:00	17	16.3	95.7	50
3/09/2024 4:15	15.8	16	93	50
3/09/2024 4:30	17.1	16.5	101.4	50
3/09/2024 4:45	14.8	16.8	86.1	50
3/09/2024 5:00	15.1	16.3	96.4	50
3/09/2024 5:15	16.1	16.6	94.8	50
3/09/2024 5:30	17.8	15.8	94.2	50
3/09/2024 5:45	18	16.6	96.1	50
3/09/2024 6:00	19.7	15.3	111.4	50
3/09/2024 6:15	20.9	17.3	197.6	50
3/09/2024 6:30	17.3	15.7	99.6	50
3/09/2024 6:45	16.5	15.1	100	50
3/09/2024 7:00	24.1	30.6	170.1	50
3/09/2024 7:15	19.5	17.9	106.6	50
3/09/2024 7:30	86.8	67.3	571.8	50
3/09/2024 7:45	55.3	31.9	200.7	50
3/09/2024 8:00	59.7	91.3	364.5	50
3/09/2024 8:15	62.1	74	413.2	50
3/09/2024 8:30	72.2	72.3	455.3	50
3/09/2024 8:45	53.7	68.7	402.9	50
3/09/2024 9:00	55.2	55.2	324	50
3/09/2024 9:15	69.1	68.2	489.1	50
3/09/2024 9:30	19.7	19.5	120	50
3/09/2024 9:45	23.5	27.8	174.6	50
3/09/2024 10:00	18.2	19.5	172.5	50
3/09/2024 10:15	26.8	22.9	102.5	50
3/09/2024 10:30	55.1	53.4	457.2	50
3/09/2024 10:45	53.4	38.3	466	50
3/09/2024 11:00	31	32.9	195.6	50
3/09/2024 11:15	77.5	62	468.9	50

3/09/2024 11:30	79.8	79.2	301.1	50
3/09/2024 11:45	74.3	87.1	528.4	50
3/09/2024 12:00	105	44.5	692.8	50
3/09/2024 12:15	71.3	68.2	486.5	50
3/09/2024 12:30	101.5	79.7	793.2	50
3/09/2024 12:45	18.4	18.4	123.8	50
3/09/2024 13:00	21.1	21.4	187.3	50
3/09/2024 13:15	22.4	24	126.9	50
3/09/2024 13:30	79.6	65.8	591.5	50
3/09/2024 13:45	66.2	54.6	408	50
3/09/2024 14:00	82.3	58.1	538.1	50
3/09/2024 14:15	69.6	80.2	583.9	50
3/09/2024 14:30	78.5	62.8	481.6	50
3/09/2024 14:45	52.8	64.2	171.1	50
3/09/2024 15:00	58.9	73.8	338.3	50
3/09/2024 15:15	82	81.5	543.3	50
3/09/2024 15:30	115.1	65.5	636.2	50
3/09/2024 15:45	179.2	140.7	1033.1	50
3/09/2024 16:00	21.1	20.7	138.9	50
3/09/2024 16:15	23.6	31.3	165	50
3/09/2024 16:30	20	16.5	157.4	50
3/09/2024 16:45	21	16.8	142.1	50
3/09/2024 17:00	53.6	51.3	474.3	50
3/09/2024 17:15	17.5	19.6	115.1	50
3/09/2024 17:30	21.8	21	130.1	50
3/09/2024 17:45	15.9	15.6	97.9	50
3/09/2024 18:00	17	21.1	113.1	50
3/09/2024 18:15	18.6	16.9	96.4	50
3/09/2024 18:30	15.7	15.4	107.4	50
3/09/2024 18:45	16.3	16.5	100.9	50
3/09/2024 19:00	16.7	15.3	96.3	50
3/09/2024 19:15	16.6	16.4	95.2	50
3/09/2024 19:30	20.1	17.5	89.2	50
3/09/2024 19:45	15.5	14.9	92.4	50
3/09/2024 20:00	16.2	14.9	98.6	50
3/09/2024 20:15	15.1	15.8	95.1	50
3/09/2024 20:30	15.3	16.9	104.9	50
3/09/2024 20:45	16.1	16	96	50
3/09/2024 21:00	14.6	15.6	93.4	50
3/09/2024 21:15	15.2	15.4	90.5	50
3/09/2024 21:30	15.4	15.8	96.9	50
3/09/2024 21:45	15.2	14.8	91.3	50
3/09/2024 22:00	15.9	16.4	91.3	50
3/09/2024 22:15	16.5	15.6	100.6	50
3/09/2024 22:30	33.9	16.9	95.5	50
3/09/2024 22:45	18.4	16.4	98.4	50
3/09/2024 23:00	16.2	16.7	112.9	50
3/09/2024 23:15	14.3	16.1	102.8	50
3/09/2024 23:30	15.6	16.1	91.1	50
3/09/2024 23:45	16	17.6	104.8	50
4/09/2024 0:00	15.7	15.9	103	50
4/09/2024 0:15	15.4	15.3	90	50
4/09/2024 0:30	15	16.4	92.7	50
4/09/2024 0:45	15.1	15.5	107.2	50
4/09/2024 1:00	15.7	16.1	93.2	50
4/09/2024 1:15	15.7	15.7	94	50
4/09/2024 1:30	15.3	17	90.8	50
4/09/2024 1:45	15.8	16	91.6	50
4/09/2024 2:00	16.3	17	98.8	50
4/09/2024 2:15	15.1	16.7	93.3	50
4/09/2024 2:30	15.5	15.5	99.5	50
4/09/2024 2:45	15.8	17.6	94.8	50
4/09/2024 3:00	15.2	16.8	92.7	50
4/09/2024 3:15	15.2	17.2	97.1	50
4/09/2024 3:30	15.3	15	95.3	50
4/09/2024 3:45	15.2	16.4	92.1	50
4/09/2024 4:00	14.5	16.5	93.9	50
4/09/2024 4:15	17.6	16.1	104	50
4/09/2024 4:30	14.1	17.2	85.6	50
4/09/2024 4:45	15.8	16.7	101.3	50
4/09/2024 5:00	15.4	16.5	88.4	50
4/09/2024 5:15	16.2	17.1	89.2	50
4/09/2024 5:30	14.9	15.6	91.3	50
4/09/2024 5:45	20.3	17.2	94.7	50
4/09/2024 6:00	16.9	17.5	92.1	50
4/09/2024 6:15	16.3	16.8	109.7	50
4/09/2024 6:30	15.6	17.1	94.7	50
4/09/2024 6:45	20.1	17.8	92.2	50
4/09/2024 7:00	13.6	20.1	98.6	50
4/09/2024 7:15	18.9	30.1	98.9	50
4/09/2024 7:30	82.1	78.9	430.1	50
4/09/2024 7:45	20.7	27	94.2	50
4/09/2024 8:00	53.2	34.8	397.2	50
4/09/2024 8:15	89.2	29.6	292.8	50
4/09/2024 8:30	96.5	142.5	777.8	50
4/09/2024 8:45	80.3	89.2	549.5	50
4/09/2024 9:00	64.6	47.3	395.8	50
4/09/2024 9:15	20.6	19.9	118.6	50
4/09/2024 9:30	25	36.1	109	50
4/09/2024 9:45	18.9	22	114.1	50
4/09/2024 10:00	31.9	36	222.6	50
4/09/2024 10:15	34.6	35.8	383.3	50
4/09/2024 10:30	147.5	143.5	838.9	50
4/09/2024 10:45	79.3	59.9	572.9	50
4/09/2024 11:00	177	125.3	916.3	50
4/09/2024 11:15	54.8	42.4	429.1	50
4/09/2024 11:30	117	93.8	1012.8	50
4/09/2024 11:45	92.1	82.1	428.5	50
4/09/2024 12:00	79.6	78.4	634.6	50
4/09/2024 12:15	60.9	51.9	368.4	50
4/09/2024 12:30	117.7	79.4	674.9	50
4/09/2024 12:45	74.9	56.8	337.8	50
4/09/2024 13:00	126.2	114.5	890.3	50
4/09/2024 13:15	55.2	54.1	369.4	50
4/09/2024 13:30	50.4	72.8	517.7	50
4/09/2024 13:45	26.9	24.6	345.4	50
4/09/2024 14:00	23.9	30.3	166.8	50
4/09/2024 14:15	24.2	19.1	219.4	50
4/09/2024 14:30	18.1	17.7	109.1	50
4/09/2024 14:45	24	26.7	167.4	50
4/09/2024 15:00	90.6	50.1	675.5	50
4/09/2024 15:15	251.4	345.9	2227.5	50
4/09/2024 15:30	135.9	122.4	841.9	50
4/09/2024 15:45	102.1	57.1	395.5	50
4/09/2024 16:00	20.6	29	147	50
4/09/2024 16:15	16.7	20.1	103	50
4/09/2024 16:30	17.4	18.1	99	50
4/09/2024 16:45	22.8	27.3	88.8	50
4/09/2024 17:00	17.1	16.6	103.9	50
4/09/2024 17:15	15.4	17	103.6	50
4/09/2024 17:30	19.6	19.1	119.3	50
4/09/2024 17:45	15	21.2	105	50
4/09/2024 18:00	18.8	17.8	111.7	50
4/09/2024 18:15	23.2	29.7	115.6	50
4/09/2024 18:30	19.5	14.4	106.8	50
4/09/2024 18:45	16.4	19.6	116.1	50
4/09/2024 19:00	14.3	15.1	96.2	50
4/09/2024 19:15	15.3	14.4	93	50
4/09/2024 19:30	15.3	14.5	110.4	50
4/09/2024 19:45	16.3	13.9	96	50
4/09/2024 20:00	16.4	16.2	87	50
4/09/2024 20:15	14.7	15.1	96.3	50
4/09/2024 20:30	16	14.2	94.4	50
4/09/2024 20:45	14.4	14.8	100.7	50
4/09/2024 21:00	14.7	15.4	95.7	50
4/09/2024 21:15	14.7	16	94.2	50
4/09/2024 21:30	15.3	16.1	97	50
4/09/2024 21:45	15.9	15.7	90.9	50
4/09/2024 22:00	17	15.9	92.4	50
4/09/2024 22:15	17.7	15	88.1	50
4/09/2024 22:30	15.7	16.1	91.3	50
4/09/2024 22:45	14.8	14.1	97.6	50

4/09/2024 23:00	16.9	14.9	90.4	50
4/09/2024 23:15	15.1	14.6	118.3	50
4/09/2024 23:30	17.4	16.1	95.5	50
4/09/2024 23:45	16.9	15.7	97.1	50
5/09/2024 0:00	15.9	15.5	94.2	50
5/09/2024 0:15	24.6	16.3	100.2	50
5/09/2024 0:30	15.3	14.7	86.9	50
5/09/2024 0:45	17.2	14.6	90.6	50
5/09/2024 1:00	15.2	15.8	91.4	50
5/09/2024 1:15	15.4	15.5	98.7	50
5/09/2024 1:30	16.2	15.5	91.4	50
5/09/2024 1:45	14.2	15.5	88.5	50
5/09/2024 2:00	14.4	15.1	93	50
5/09/2024 2:15	15.6	14.6	89.7	50
5/09/2024 2:30	14.5	17.4	90.3	50
5/09/2024 2:45	15.3	16.1	90.3	50
5/09/2024 3:00	13.8	14.2	93.6	50
5/09/2024 3:15	16.3	16.7	97.4	50
5/09/2024 3:30	14.9	15.3	95.1	50
5/09/2024 3:45	16.6	17	93.4	50
5/09/2024 4:00	16.1	15.2	95.2	50
5/09/2024 4:15	15.5	15.3	90	50
5/09/2024 4:30	15.2	15.3	92.5	50
5/09/2024 4:45	14.4	16	93.3	50
5/09/2024 5:00	14.1	15.5	105.5	50
5/09/2024 5:15	15.6	15.6	90	50
5/09/2024 5:30	17.6	15.9	90.8	50
5/09/2024 5:45	14.7	15.5	106.6	50
5/09/2024 6:00	15.7	15.7	94	50
5/09/2024 6:15	23.1	17.8	120	50
5/09/2024 6:30	18.8	17	96.4	50
5/09/2024 6:45	18.7	17.4	98.1	50
5/09/2024 7:00	16.4	16.5	97.1	50
5/09/2024 7:15	24.9	26.5	163.3	50
5/09/2024 7:30	143	125.5	907.8	50
5/09/2024 7:45	74.1	96.5	606	50
5/09/2024 8:00	102	90.1	474.8	50
5/09/2024 8:15	79	60.1	524.6	50
5/09/2024 8:30	78.2	118.1	91.9	50
5/09/2024 8:45	98.7	70.3	622.7	50
5/09/2024 9:00	54.7	67.1	344.2	50
5/09/2024 9:15	97.1	64.2	742.7	50
5/09/2024 9:30	94.5	85.8	801.8	50
5/09/2024 9:45	67	64.1	523.8	50
5/09/2024 10:00	72.1	67.5	615.9	50
5/09/2024 10:15	81.1	62.1	658.9	50
5/09/2024 10:30	34	54	211.7	50
5/09/2024 10:45	62.9	91.7	453.8	50
5/09/2024 11:00	33	38.5	132.4	50
5/09/2024 11:15	82.6	85.3	210.5	50
5/09/2024 11:30	201.5	211.3	706.3	50
5/09/2024 11:45	160.9	122.3	767.3	50
5/09/2024 12:00	261	117.4	1175.2	50
5/09/2024 12:15	173.5	114.5	727.5	50
5/09/2024 12:30	111.1	156.1	706	50
5/09/2024 12:45	117.5	88.1	421.2	50
5/09/2024 13:00	39.2	52.3	195.9	50
5/09/2024 13:15	27.2	28.4	162.1	50
5/09/2024 13:30	46.8	38.9	196.6	50
5/09/2024 13:45	38.9	41.2	152.7	50
5/09/2024 14:00	302.2	275.7	1636.2	50
5/09/2024 14:15	642	690	2783.2	50
5/09/2024 14:30	87.8	105.1	466.5	50
5/09/2024 14:45	82.8	82.9	313.4	50
5/09/2024 15:00	55.3	50.3	306.7	50
5/09/2024 15:15	42.4	34.5	214.2	50
5/09/2024 15:30	50.4	37.6	399.7	50
5/09/2024 15:45	50.3	47.5	262.2	50
5/09/2024 16:00	63.6	23.8	290.1	50
5/09/2024 16:15	34.8	82.3	377.3	50
5/09/2024 16:30	29.2	35.2	262.8	50
5/09/2024 16:45	16.5	18.5	132.4	50
5/09/2024 17:00	28.2	22.1	231.1	50
5/09/2024 17:15	20	23.9	161.9	50
5/09/2024 17:30	40.4	51	274.9	50
5/09/2024 17:45	16.5	15.6	100.9	50
5/09/2024 18:00	53.9	42.4	457.5	50
5/09/2024 18:15	14.4	16.1	93.4	50
5/09/2024 18:30	15.1	17.7	92.4	50
5/09/2024 18:45	14.5	16.3	96.3	50
5/09/2024 19:00	13.5	16.5	83.8	50
5/09/2024 19:15	14.3	14.6	95.4	50
5/09/2024 19:30	14.5	17.3	94.4	50
5/09/2024 19:45	14.4	15.4	89	50
5/09/2024 20:00	15.3	16.6	88.8	50
5/09/2024 20:15	14.7	14.9	84	50
5/09/2024 20:30	13.8	14.9	97.4	50
5/09/2024 20:45	16	16.5	90.5	50
5/09/2024 21:00	14.4	14.7	88.1	50
5/09/2024 21:15	14.8	15.5	89.4	50
5/09/2024 21:30	15.2	17	89.2	50
5/09/2024 21:45	14.9	15.3	93.4	50
5/09/2024 22:00	16	16.3	102.5	50
5/09/2024 22:15	15.1	16.1	91	50
5/09/2024 22:30	14.9	15.5	99.3	50
5/09/2024 22:45	15.4	16.4	102	50
5/09/2024 23:00	15.8	16.3	90	50
5/09/2024 23:15	16	16.6	93	50
5/09/2024 23:30	13.8	16.8	93.8	50
5/09/2024 23:45	15.4	14.4	90.8	50
6/09/2024 0:00	16.4	14.9	94.2	50
6/09/2024 0:15	14.9	15.6	92.1	50
6/09/2024 0:30	15.4	16.7	95.5	50
6/09/2024 0:45	15.7	15.1	88.2	50
6/09/2024 1:00	14.6	15.6	100	50
6/09/2024 1:15	16.9	17.3	95.3	50
6/09/2024 1:30	17.1	15.6	94.6	50
6/09/2024 1:45	14.5	15.6	89.4	50
6/09/2024 2:00	14.5	16.1	95.6	50
6/09/2024 2:15	15.9	16.9	105.6	50
6/09/2024 2:30	15.6	15.2	99.3	50
6/09/2024 2:45	14.5	14.7	97.2	50
6/09/2024 3:00	14.6	16	92.8	50
6/09/2024 3:15	15.2	14.6	90.1	50
6/09/2024 3:30	31.1	29.4	111.4	50
6/09/2024 3:45	16.1	16.2	94.7	50
6/09/2024 4:00	16	17.1	87.7	50
6/09/2024 4:15	15.8	19	91.3	50
6/09/2024 4:30	15.6	15.4	89	50
6/09/2024 4:45	15	15.9	93.6	50
6/09/2024 5:00	14.9	15.9	96.5	50
6/09/2024 5:15	13.8	15.8	89.4	50
6/09/2024 5:30	16.7	22.7	97.5	50
6/09/2024 5:45	15.5	16.1	90.7	50
6/09/2024 6:00	17.4	16.4	91.8	50
6/09/2024 6:15	19.7	17.5	104	50
6/09/2024 6:30	15.8	16.5	92.1	50
6/09/2024 6:45	17.6	17	90.3	50
6/09/2024 7:00	62.4	48.7	521.6	50
6/09/2024 7:15	46.6	44.7	300.6	50
6/09/2024 7:30	84.5	97.7	675.6	50
6/09/2024 7:45	149.7	101.3	470.5	50
6/09/2024 8:00	117.8	92.8	708.2	50
6/09/2024 8:15	120.5	127	828.3	50
6/09/2024 8:30	89.1	76	562.8	50
6/09/2024 8:45	107.1	98.8	716.7	50
6/09/2024 9:00	48.7	39.3	313.5	50
6/09/2024 9:15	41.6	38.3	156.5	50
6/09/2024 9:30	50.2	61.5	291.3	50
6/09/2024 9:45	43.1	41.8	150.1	50
6/09/2024 10:00	34.7	51.7	126	50
6/09/2024 10:15	45.9	53	141.4	50

6/09/2024 10:30	208.6	126.3	1457	50
6/09/2024 10:45	80.7	62.4	554	50
6/09/2024 11:00	104.2	118.1	861.4	50
6/09/2024 11:15	65.7	58.8	412.6	50
6/09/2024 11:30	103.3	72.7	381.9	50
6/09/2024 11:45	74	80.2	399.5	50
6/09/2024 12:00	143.6	120.5	744.4	50
6/09/2024 12:15	120.6	180.8	602.2	50
6/09/2024 12:30	93.6	61.7	271.9	50
6/09/2024 12:45	43.2	45.8	178.9	50
6/09/2024 13:00	30.4	25.4	181.6	50
6/09/2024 13:15	37	36.3	349.5	50
6/09/2024 13:30	149.7	120.5	560.2	50
6/09/2024 13:45	142.9	123.4	1112.6	50
6/09/2024 14:00	155.1	160	1472.6	50
6/09/2024 14:15	92.4	75.5	528.2	50
6/09/2024 14:30	86.2	123.7	520.6	50
6/09/2024 14:45	85.3	56.1	278.4	50
6/09/2024 15:00	160	137.2	1074.7	50
6/09/2024 15:15	76.1	58.4	349.9	50
6/09/2024 15:30	60.5	54.1	352.2	50
6/09/2024 15:45	58.7	54.5	201.7	50
6/09/2024 16:00	62.3	61.7	189.8	50
6/09/2024 16:15	95.5	38.5	433.8	50
6/09/2024 16:30	14.6	17	91.9	50
6/09/2024 16:45	29	55.4	150.8	50
6/09/2024 17:00	15	15.6	101.6	50
6/09/2024 17:15	18.5	16.6	164.6	50
6/09/2024 17:30	18.4	16.9	156.6	50
6/09/2024 17:45	27.9	34.9	224.2	50
6/09/2024 18:00	20	21.1	175.5	50
6/09/2024 18:15	14.6	16.7	93.1	50
6/09/2024 18:30	23.3	42.1	198.1	50
6/09/2024 18:45	24.4	54.5	128.4	50
6/09/2024 19:00	14.8	18.4	94.9	50
6/09/2024 19:15	16.2	16.9	85.4	50
6/09/2024 19:30	17.2	16.5	89.2	50
6/09/2024 19:45	14.4	16.6	98.2	50
6/09/2024 20:00	14.6	17.3	88	50
6/09/2024 20:15	16.8	16.1	97.7	50
6/09/2024 20:30	17.4	15.7	89.6	50
6/09/2024 20:45	15.1	16	87.4	50
6/09/2024 21:00	15.3	17.4	89.1	50
6/09/2024 21:15	13.9	15.3	91.1	50
6/09/2024 21:30	14.2	15.5	85	50
6/09/2024 21:45	14.3	16.2	91.4	50
6/09/2024 22:00	19	14.6	91.2	50
6/09/2024 22:15	15.2	15.1	87.6	50
6/09/2024 22:30	14.9	15.4	88.6	50
6/09/2024 22:45	14.2	15.1	92.7	50
6/09/2024 23:00	15.1	14.8	90.2	50
6/09/2024 23:15	16.4	15.6	94.8	50
6/09/2024 23:30	14.8	15.5	88.7	50
6/09/2024 23:45	15.2	17.4	86.2	50
7/09/2024 0:00	15.1	15.3	89.5	50
7/09/2024 0:15	14.1	15.3	100.2	50
7/09/2024 0:30	18.9	16	86.5	50
7/09/2024 0:45	14.5	15.6	109.1	50
7/09/2024 1:00	14.2	15.2	83.1	50
7/09/2024 1:15	14.4	16.2	91.1	50
7/09/2024 1:30	15.1	15.6	87.9	50
7/09/2024 1:45	18.5	13.9	86.6	50
7/09/2024 2:00	16.5	14.7	83.5	50
7/09/2024 2:15	15.3	15.4	90.5	50
7/09/2024 2:30	15.8	15.2	90.9	50
7/09/2024 2:45	17.7	16.6	83.9	50
7/09/2024 3:00	18	16	83.6	50
7/09/2024 3:15	15	16.8	84.6	50
7/09/2024 3:30	14.6	16.7	100.8	50
7/09/2024 3:45	18.3	16.3	86.8	50
7/09/2024 4:00	15.9	15.7	88.3	50
7/09/2024 4:15	16.5	15.5	90.8	50
7/09/2024 4:30	15.9	15.4	96.7	50
7/09/2024 4:45	15.4	16	95.1	50
7/09/2024 5:00	14.6	15.8	88.5	50
7/09/2024 5:15	16.3	15.5	89.4	50
7/09/2024 5:30	15.1	17	86.2	50
7/09/2024 5:45	41.7	342.2	115	50
7/09/2024 6:00	93.3	93.6	108.5	50
7/09/2024 6:15	14.4	15.9	92.8	50
7/09/2024 6:30	14.6	18.4	101.2	50
7/09/2024 6:45	16.1	22.1	89.7	50
7/09/2024 7:00	14.9	18.8	84.1	50
7/09/2024 7:15	20.1	18.4	150.7	50
7/09/2024 7:30	19.3	23.7	151.9	50
7/09/2024 7:45	46.5	65.7	190.2	50
7/09/2024 8:00	43.5	61.9	187.4	50
7/09/2024 8:15	35.6	29.7	149.9	50
7/09/2024 8:30	36.7	47.9	167.6	50
7/09/2024 8:45	135.1	225.2	839.2	50
7/09/2024 9:00	41	37.7	138.5	50
7/09/2024 9:15	60.5	77.7	460.7	50
7/09/2024 9:30	34.4	42	274.6	50
7/09/2024 9:45	17.5	43.7	324.2	50
7/09/2024 10:00	45.4	39.2	384.2	50
7/09/2024 10:15	39.7	27.7	141.3	50
7/09/2024 10:30	138.3	226.5	556.3	50
7/09/2024 10:45	65.7	153.8	435.4	50
7/09/2024 11:00	56.2	75.3	294	50
7/09/2024 11:15	38.3	55.5	284	50
7/09/2024 11:30	48.9	48.8	340.2	50
7/09/2024 11:45	49.7	45.5	399.9	50
7/09/2024 12:00	45.7	55.6	368.8	50
7/09/2024 12:15	17.6	41.6	303.7	50
7/09/2024 12:30	105.5	96.7	813.5	50
7/09/2024 12:45	83.2	105.2	466	50
7/09/2024 13:00	59.1	55.7	271.5	50
7/09/2024 13:15	98.1	100.6	452	50
7/09/2024 13:30	20.2	25.3	93.5	50
7/09/2024 13:45	44.4	42.6	179.1	50
7/09/2024 14:00	25.6	22	245	50
7/09/2024 14:15	18.7	18.9	86.4	50
7/09/2024 14:30	18.7	19	94.5	50
7/09/2024 14:45	15.5	18.9	85.9	50
7/09/2024 15:00	18.1	18.2	85.7	50
7/09/2024 15:15	16.1	18.1	82.6	50
7/09/2024 15:30	15.6	16.9	87.2	50
7/09/2024 15:45	16.4	18.4	87.6	50
7/09/2024 16:00	16.4	16.5	85.3	50
7/09/2024 16:15	17.2	17.8	91.7	50
7/09/2024 16:30	15.8	16.7	97.1	50
7/09/2024 16:45	18.8	18.9	84.8	50
7/09/2024 17:00	16.4	16.2	89.8	50
7/09/2024 17:15	16.2	16.2	86	50
7/09/2024 17:30	18.9	19.2	89.2	50
7/09/2024 17:45	17.2	17.2	96.3	50
7/09/2024 18:00	18.9	17	91.3	50
7/09/2024 18:15	18.8	17.9	92.7	50
7/09/2024 18:30	21.1	16.4	85.1	50
7/09/2024 18:45	19.2	18	89.8	50
7/09/2024 19:00	18.6	17.4	90.7	50
7/09/2024 19:15	17	15.5	85.1	50
7/09/2024 19:30	17.6	17	89	50
7/09/2024 19:45	18	15.5	84.5	50
7/09/2024 20:00	16.2	16.1	91.7	50
7/09/2024 20:15	15.8	17.8	102.8	50
7/09/2024 20:30	15.4	17.5	80.5	50
7/09/2024 20:45	15.7	16.7	83.4	50
7/09/2024 21:00	15	14.8	82	50
7/09/2024 21:15	16.2	17.3	85.9	50
7/09/2024 21:30	14.9	15.6	82.3	50
7/09/2024 21:45	16.1	17.5	98.7	50

7/09/2024 22:00	15.8	16.1	85.2	50
7/09/2024 22:15	15.6	14.7	86.5	50
7/09/2024 22:30	15.9	15.2	83.8	50
7/09/2024 22:45	16.3	16.5	87.8	50
7/09/2024 23:00	17.8	16.4	83.7	50
7/09/2024 23:15	21.5	18.6	88.8	50
7/09/2024 23:30	19.6	15.2	88.1	50
7/09/2024 23:45	15.7	16.6	87.8	50
8/09/2024 0:00	17	17	84.1	50
8/09/2024 0:15	19.4	14.8	84.3	50
8/09/2024 0:30	17.7	17.1	92.8	50
8/09/2024 0:45	15.8	15.8	87.3	50
8/09/2024 1:00	16.2	17	87.1	50
8/09/2024 1:15	15.9	15.8	89.1	50
8/09/2024 1:30	18.2	16.1	76.9	50
8/09/2024 1:45	16.2	16.2	82.7	50
8/09/2024 2:00	15.4	15.8	78.4	50
8/09/2024 2:15	18	16.6	98.3	50
8/09/2024 2:30	19.9	15.3	85.2	50
8/09/2024 2:45	18.7	16.6	80.5	50
8/09/2024 3:00	15.6	19	86	50
8/09/2024 3:15	16.9	16.6	83.8	50
8/09/2024 3:30	14.9	16.1	88.2	50
8/09/2024 3:45	18.2	16.7	87.2	50
8/09/2024 4:00	14.3	15.8	87.6	50
8/09/2024 4:15	18.8	15.6	86.1	50
8/09/2024 4:30	16.3	15.5	80.7	50
8/09/2024 4:45	15	15.3	87.9	50
8/09/2024 5:00	16.5	17.6	90.2	50
8/09/2024 5:15	16.2	16.3	85.5	50
8/09/2024 5:30	15.7	15.5	81.2	50
8/09/2024 5:45	14.9	15	92.4	50
8/09/2024 6:00	14.6	16.3	89.9	50
8/09/2024 6:15	16.4	16.4	88.7	50
8/09/2024 6:30	15.5	15.7	109.7	50
8/09/2024 6:45	16	16.3	91.8	50
8/09/2024 7:00	16.1	16.2	98.3	50
8/09/2024 7:15	16.1	15.9	100.2	50
8/09/2024 7:30	18.4	16.2	98.4	50
8/09/2024 7:45	16.7	15.9	84.2	50
8/09/2024 8:00	17.3	16.1	88.4	50
8/09/2024 8:15	16.8	16.2	94.2	50
8/09/2024 8:30	16.7	15.8	85.2	50
8/09/2024 8:45	20.9	21.1	90.6	50
8/09/2024 9:00	15.2	16.2	93.1	50
8/09/2024 9:15	19.3	16.5	93	50
8/09/2024 9:30	18.3	16.3	92.5	50
8/09/2024 9:45	15.6	15.4	92.2	50
8/09/2024 10:00	18.6	16.5	94.1	50
8/09/2024 10:15	16.2	16.4	87	50
8/09/2024 10:30	16	17	88.3	50
8/09/2024 10:45	17.9	25.1	94.8	50
8/09/2024 11:00	15.4	24.3	84.6	50
8/09/2024 11:15	15.8	18.3	88.6	50
8/09/2024 11:30	17.5	16.5	89.1	50
8/09/2024 11:45	18.4	16.2	92.5	50
8/09/2024 12:00	17.6	17.7	90.2	50
8/09/2024 12:15	14.3	15.9	109.1	50
8/09/2024 12:30	16.4	17	84.6	50
8/09/2024 12:45	16.4	23	94.7	50
8/09/2024 13:00	16.1	16.8	90.5	50
8/09/2024 13:15	17.5	21.1	131.6	50
8/09/2024 13:30	15.2	15	85.1	50
8/09/2024 13:45	16.5	21.8	93.8	50
8/09/2024 14:00	16.8	16.6	87.5	50
8/09/2024 14:15	15.2	17.7	88.2	50
8/09/2024 14:30	16.5	16.7	98.3	50
8/09/2024 14:45	16.5	15.4	87.2	50
8/09/2024 15:00	14.8	16.4	114.4	50
8/09/2024 15:15	14.3	16.4	88.6	50
8/09/2024 15:30	15.5	14.5	83.5	50
8/09/2024 15:45	15.5	15.4	85.9	50
8/09/2024 16:00	17.4	16.3	174.1	50
8/09/2024 16:15	16.7	16.3	87.7	50
8/09/2024 16:30	17.5	16.8	105.9	50
8/09/2024 16:45	15.8	15.5	87.8	50
8/09/2024 17:00	15	15.6	96.9	50
8/09/2024 17:15	15.1	15	89.3	50
8/09/2024 17:30	15.2	15.5	89.3	50
8/09/2024 17:45	15.9	16.9	93	50
8/09/2024 18:00	17	14.6	91.8	50
8/09/2024 18:15	16.8	15.5	90.9	50
8/09/2024 18:30	15.1	14.5	81.9	50
8/09/2024 18:45	14.7	14.4	98.9	50
8/09/2024 19:00	17	14.7	114.7	50
8/09/2024 19:15	14.6	16.3	111.3	50
8/09/2024 19:30	15.1	14.5	110.7	50
8/09/2024 19:45	14.2	14.7	87.7	50
8/09/2024 20:00	15.1	15.3	117.7	50
8/09/2024 20:15	15.8	15.4	92.8	50
8/09/2024 20:30	16.3	14.5	91	50
8/09/2024 20:45	16.4	14.6	96.3	50
8/09/2024 21:00	16	15.6	88.1	50
8/09/2024 21:15	17.9	15.2	98.8	50
8/09/2024 21:30	14.6	16.9	106.6	50
8/09/2024 21:45	13.6	15.9	85.6	50
8/09/2024 22:00	15.4	17.2	94.1	50
8/09/2024 22:15	15	16.9	93.2	50
8/09/2024 22:30	15.9	15.6	90.6	50
8/09/2024 22:45	16.2	16.7	93.1	50
8/09/2024 23:00	14.6	16	94.6	50
8/09/2024 23:15	14.1	15.9	95.2	50
8/09/2024 23:30	14	14.9	85.4	50
8/09/2024 23:45	15.5	15.2	89.9	50
9/09/2024 0:00	17.5	24.5	86.7	50
9/09/2024 0:15	16.2	15.9	87.4	50
9/09/2024 0:30	15.8	15.5	94.4	50
9/09/2024 0:45	15.2	15.8	89.4	50
9/09/2024 1:00	14.2	14	95.5	50
9/09/2024 1:15	15.6	14.6	89.4	50
9/09/2024 1:30	16.5	14.4	84.6	50
9/09/2024 1:45	15.3	16.1	92.4	50
9/09/2024 2:00	14.2	14.8	98.2	50
9/09/2024 2:15	15	15.9	93.3	50
9/09/2024 2:30	15.3	15.9	96	50
9/09/2024 2:45	14.8	15.5	92.7	50
9/09/2024 3:00	15.8	15.5	85	50
9/09/2024 3:15	17.1	15.7	80.6	50
9/09/2024 3:30	14.3	15.9	92.6	50
9/09/2024 3:45	14.7	15.7	93.4	50
9/09/2024 4:00	15.6	15.6	93.7	50
9/09/2024 4:15	16.2	15.7	95.9	50
9/09/2024 4:30	15.4	15.4	88.1	50
9/09/2024 4:45	16.3	15.1	95.4	50
9/09/2024 5:00	17.9	15.5	91	50
9/09/2024 5:15	17.7	16.1	96.1	50
9/09/2024 5:30	17.8	20.9	95.4	50
9/09/2024 5:45	15.8	16.2	95	50
9/09/2024 6:00	17.4	16.1	92.7	50
9/09/2024 6:15	18.1	16.6	112.4	50
9/09/2024 6:30	16.8	15	103.2	50
9/09/2024 6:45	16.7	16.1	105	50
9/09/2024 7:00	16.7	15.3	104.1	50
9/09/2024 7:15	23.1	20.7	100.6	50
9/09/2024 7:30	18.7	17.3	122.9	50
9/09/2024 7:45	74.7	53	576.7	50
9/09/2024 8:00	191.2	101.5	960	50
9/09/2024 8:15	126.5	121.3	621	50
9/09/2024 8:30	136.5	167.5	556	50
9/09/2024 8:45	89.3	66.1	441.2	50
9/09/2024 9:00	1029.6	727.1	5179.3	50
9/09/2024 9:15	134.9	112.1	923.5	50

9/09/2024 9:30	97.2	108.2	688.5	50
9/09/2024 9:45	95.5	80.7	573.1	50
9/09/2024 10:00	95.2	82.3	221.8	50
9/09/2024 10:30	100.3	100.4	374.6	50
9/09/2024 10:45	102.1	56.7	449.7	50
9/09/2024 12:30	22	24.4	106.9	50
9/09/2024 13:15	96	92.6	449.7	50
9/09/2024 13:30	74.3	92.1	519.8	50
9/09/2024 15:30	148.1	147.8	704.6	50
9/09/2024 15:45	24.9	24.3	120.9	50
9/09/2024 16:00	20.7	18.5	162.1	50
9/09/2024 17:00	27.4	53.7	122.5	50
9/09/2024 17:15	14.1	15.9	95.1	50
9/09/2024 17:30	18.7	26	118.3	50
9/09/2024 17:45	13.2	11.1	69.1	50
9/09/2024 18:00	13.5	14.2	79.1	50
9/09/2024 18:15	14.4	14.7	102.5	50
9/09/2024 18:30	16.1	16.7	129.9	50
9/09/2024 18:45	15	15.4	115	50
9/09/2024 19:00	15.8	14.4	93.4	50
9/09/2024 19:30	14.5	15	91.7	50
9/09/2024 19:45	16.7	19.3	157.6	50
9/09/2024 20:30	15	16.5	95.4	50
9/09/2024 20:45	9.1	9.5	47.9	50
9/09/2024 21:00	23.9	23.8	163.9	50
9/09/2024 21:15	10.4	11	59.5	50
9/09/2024 21:45	18.6	20.4	97.6	50
10/09/2024 6:00	17.4	16.8	96.8	50
10/09/2024 6:15	20	22	122.8	50
10/09/2024 6:30	16.8	16.3	99.9	50
10/09/2024 6:45	15.9	16.6	93.6	50
10/09/2024 7:00	25.9	23.5	96.4	50
10/09/2024 7:15	29.1	22.6	127.6	50
10/09/2024 7:30	90.5	240.8	414.5	50
10/09/2024 7:45	112.3	72.9	458.3	50
10/09/2024 8:00	96.6	94.8	695.5	50
10/09/2024 8:15	135.1	106.7	711.2	50
10/09/2024 8:30	131.8	167.4	459.4	50
10/09/2024 8:45	51.1	78	186.7	50
10/09/2024 9:00	76.1	68.3	271.7	50
10/09/2024 9:15	22.7	23.7	203.7	50
10/09/2024 9:30	58.3	61.1	471.5	50
10/09/2024 9:45	87	71.3	602.6	50
10/09/2024 10:00	34.3	27.8	162.7	50
10/09/2024 10:15	72.3	95	195.6	50
10/09/2024 10:30	93.4	81.8	687.5	50
10/09/2024 10:45	29.2	39.3	369.9	50
10/09/2024 11:00	60.5	88.7	314.8	50
10/09/2024 11:15	65.1	81	302.6	50
10/09/2024 11:30	121	87.9	688.5	50
10/09/2024 11:45	422.6	359.5	3576.7	50
10/09/2024 12:00	209.2	193.5	1755	50
10/09/2024 12:15	165	162.1	1315.7	50
10/09/2024 12:30	159.2	136.7	1833.9	50
10/09/2024 12:45	43.6	41.7	344.8	50
10/09/2024 13:00	48.8	35.1	172.1	50
10/09/2024 13:15	26.5	27.7	139.9	50
10/09/2024 13:30	68.3	62.9	320.9	50
10/09/2024 13:45	108.3	149.2	866.6	50
10/09/2024 14:00	39.5	43.8	334.6	50
10/09/2024 14:15	98.6	83.7	716.8	50
10/09/2024 14:30	98.3	71.4	415	50
10/09/2024 14:45	223.9	259.6	1319.6	50
10/09/2024 15:00	106.7	99	721.5	50
10/09/2024 15:15	171.1	183.6	1046.4	50
10/09/2024 15:30	157.5	168.7	815.9	50
10/09/2024 15:45	68	76.9	352	50
10/09/2024 16:00	25	36.8	230.7	50
10/09/2024 16:15	25.3	24.8	197.6	50
10/09/2024 16:30	22.4	19.1	128.6	50
10/09/2024 16:45	25.8	31.4	349.8	50
10/09/2024 17:00	21.9	19.3	218.1	50
10/09/2024 17:15	19.4	20.1	198.9	50
10/09/2024 17:30	38.3	52.3	332.7	50
10/09/2024 17:45	28.8	20.5	177.2	50
10/09/2024 18:00	26.2	30	187.7	50
10/09/2024 18:15	25.7	26.6	182	50
10/09/2024 18:30	26.6	15.8	145.3	50
10/09/2024 18:45	53.4	38.8	335.1	50
10/09/2024 19:00	16.7	15.4	89.9	50
10/09/2024 19:15	18	15.6	97.8	50
10/09/2024 19:30	18.9	15	87.2	50
10/09/2024 19:45	21	18.7	135.8	50
10/09/2024 20:00	16.6	16.6	109.5	50
10/09/2024 20:15	25.6	17.7	113.1	50
10/09/2024 20:30	18.2	16.1	93.9	50
10/09/2024 20:45	16.7	14.7	86.9	50
10/09/2024 21:00	21.3	22.7	121.2	50
10/09/2024 21:15	15.1	15.4	92.7	50
10/09/2024 21:30	17.6	15.4	106	50
10/09/2024 21:45	14.5	15.2	99.5	50
10/09/2024 22:00	17.6	18.3	90.3	50
10/09/2024 22:15	16.4	16	92.9	50
10/09/2024 22:30	15.1	16.6	91	50
10/09/2024 22:45	15.5	16.2	88.4	50
10/09/2024 23:00	16	16.4	97.4	50
10/09/2024 23:15	14.2	16.4	90.4	50
10/09/2024 23:30	14.5	16.3	88.5	50
10/09/2024 23:45	14.5	15.9	85.2	50
11/09/2024 0:00	15	19	89	50
11/09/2024 0:15	15.9	17.2	92	50
11/09/2024 0:30	14	17.2	89.2	50
11/09/2024 0:45	19.5	17.5	81.2	50
11/09/2024 1:00	15.3	15.5	101.4	50
11/09/2024 1:15	15.1	16.5	92.2	50
11/09/2024 1:30	17.5	15.9	91.6	50
11/09/2024 1:45	17.3	16.4	90.6	50
11/09/2024 2:00	14.5	15.7	89.8	50
11/09/2024 2:15	14.7	14.9	89.4	50
11/09/2024 2:30	16.5	15.4	89.1	50
11/09/2024 2:45	14.4	16.3	102.5	50
11/09/2024 3:00	15.2	14.8	87.1	50
11/09/2024 3:15	16.3	15.6	92.4	50
11/09/2024 3:30	16.4	16.7	92.9	50
11/09/2024 3:45	19.7	16	98.6	50
11/09/2024 4:00	16.6	15.7	93.1	50
11/09/2024 4:15	17.9	15.6	87	50
11/09/2024 4:30	14.6	16.2	93.5	50
11/09/2024 4:45	17.6	17.3	93.4	50
11/09/2024 5:00	15.7	16.3	95.6	50
11/09/2024 5:15	15.9	19	86.7	50
11/09/2024 5:30	16.1	15.5	91.6	50
11/09/2024 5:45	15.8	16.6	97.5	50
11/09/2024 6:00	19.9	17	112.1	50
11/09/2024 6:15	16.4	17.5	91.3	50
11/09/2024 6:30	18.9	15.7	89.9	50
11/09/2024 6:45	18.2	17.1	94.3	50
11/09/2024 7:00	101.3	50.8	472.3	50
11/09/2024 7:15	65.7	38.5	382.2	50
11/09/2024 7:30	65.7	63.4	250	50
11/09/2024 7:45	119.3	106.4	400.6	50
11/09/2024 8:00	83.2	76.4	199.5	50
11/09/2024 8:15	73.2	84.5	276	50
11/09/2024 8:30	139	144.6	375.3	50
11/09/2024 8:45	33.2	50.2	234.2	50
11/09/2024 9:00	70	94.8	836.9	50
11/09/2024 9:15	96.2	104.4	675.3	50
11/09/2024 9:30	115	109.2	491.3	50
11/09/2024 9:45	58.2	78.1	391.8	50
11/09/2024 10:00	339	560	1326.3	50
11/09/2024 10:15	283.3	378.9	611.2	50
11/09/2024 10:30	36	25.6	326.5	50

11/09/2024 10:45	38	42.1	291.4	50
11/09/2024 11:00	22	34.7	128.3	50
11/09/2024 11:15	88.9	156.9	644.7	50
11/09/2024 11:30	37	31.7	190.8	50
11/09/2024 11:45	74.6	150.3	665.8	50
11/09/2024 12:00	177.5	168.8	1026.2	50
11/09/2024 12:15	65.7	62.5	472.7	50
11/09/2024 12:30	115.3	116.6	624.1	50
11/09/2024 12:45	303.3	440.6	1998.5	50
11/09/2024 13:00	115.9	125.6	1034.6	50
11/09/2024 13:15	139	108.9	800.9	50
11/09/2024 13:30	217.2	302.1	1057.9	50
11/09/2024 13:45	20.8	19.3	127.1	50
11/09/2024 14:00	28.1	22.3	159.2	50
11/09/2024 14:15	28.1	30	192.7	50
11/09/2024 14:30	81.4	94.6	578.1	50
11/09/2024 14:45	112.6	164.3	758.7	50
11/09/2024 15:00	114.9	98.6	685.4	50
11/09/2024 15:15	89.1	85.6	513.9	50
11/09/2024 15:30	198.7	167.7	731.9	50
11/09/2024 15:45	397.4	460.9	2056.3	50
11/09/2024 16:00	40.3	51.9	277.6	50
11/09/2024 16:15	21.6	22.6	179.1	50
11/09/2024 16:30	17	16.1	110.5	50
11/09/2024 16:45	19	19.8	100.9	50
11/09/2024 17:00	18.3	19.3	88.1	50
11/09/2024 17:15	16.4	17.9	89.8	50
11/09/2024 17:30	15.8	17.2	96.6	50
11/09/2024 17:45	16.2	18.2	87.4	50
11/09/2024 18:00	15.2	16.6	93.9	50
11/09/2024 18:15	14.5	17.3	88.5	50
11/09/2024 18:30	18	16.8	88.9	50
11/09/2024 18:45	17.5	16.4	86.1	50
11/09/2024 19:00	16.2	14.4	90.1	50
11/09/2024 19:15	18.9	15.6	85.8	50
11/09/2024 19:30	14.5	14.8	79.8	50
11/09/2024 19:45	16.6	16.1	89.2	50
11/09/2024 20:00	47.2	47.1	442.5	50
11/09/2024 20:15	18.6	15.4	88.1	50
11/09/2024 20:30	15.1	17.2	82.9	50
11/09/2024 20:45	17.8	15.9	86.4	50
11/09/2024 21:00	15.7	15.3	85.8	50
11/09/2024 21:15	15.8	17.8	83.3	50
11/09/2024 21:30	17	16.2	86.1	50
11/09/2024 21:45	19.3	15	90.6	50
11/09/2024 22:00	15.1	15.1	91.2	50
11/09/2024 22:15	20.6	18.7	89.7	50
11/09/2024 22:30	17.3	16.3	87.7	50
11/09/2024 22:45	15	16.2	87.8	50
11/09/2024 23:00	16.4	15.3	85.7	50
11/09/2024 23:15	15.3	18.3	91.3	50
11/09/2024 23:30	17.2	16.1	86.8	50
11/09/2024 23:45	16.3	15.1	87.5	50
12/09/2024 0:00	16.2	17.2	82.6	50
12/09/2024 0:15	16.1	17	86.3	50
12/09/2024 0:30	14.6	15.5	88.7	50
12/09/2024 0:45	15	16.3	87.9	50
12/09/2024 1:00	16.1	15.9	86.8	50
12/09/2024 1:15	15.3	16.4	84.2	50
12/09/2024 1:30	15.7	16.3	82.4	50
12/09/2024 1:45	16.9	17.1	84.3	50
12/09/2024 2:00	16	15.6	89.2	50
12/09/2024 2:15	16	16.5	90	50
12/09/2024 2:30	16.7	17.1	87.7	50
12/09/2024 2:45	14.7	15.5	93.4	50
12/09/2024 3:00	15.2	16.8	87.3	50
12/09/2024 3:15	15.2	18.5	77.7	50
12/09/2024 3:30	15.3	15.5	88	50
12/09/2024 3:45	16.4	16.2	91.1	50
12/09/2024 4:00	15.6	17.6	79.2	50
12/09/2024 4:15	14.5	18	88.3	50
12/09/2024 4:30	16.8	15.5	90.9	50
12/09/2024 4:45	16.6	16.4	87.1	50
12/09/2024 5:00	15.5	16.4	86.6	50
12/09/2024 5:15	15.1	16.1	94.1	50
12/09/2024 5:30	15.6	16.7	87.5	50
12/09/2024 5:45	15.3	16.3	83.8	50
12/09/2024 6:00	19.4	18.1	120.6	50
12/09/2024 6:15	19.6	17.1	96	50
12/09/2024 6:30	17.4	18.1	102.4	50
12/09/2024 6:45	17	19.1	94.2	50
12/09/2024 7:00	34	31.9	144.1	50
12/09/2024 7:15	387.5	239.2	835.6	50
12/09/2024 7:30	199.4	103.6	1053.5	50
12/09/2024 7:45	173.6	190.7	1165.4	50
12/09/2024 8:00	260.9	234.3	2061.5	50
12/09/2024 8:15	86	105.5	354.3	50
12/09/2024 8:30	166	161.4	1032.8	50
12/09/2024 8:45	178.9	104.5	765.3	50
12/09/2024 9:00	177.1	373	1231.3	50
12/09/2024 9:15	177.9	148.3	1540.4	50
12/09/2024 9:30	213.6	115	1528.6	50
12/09/2024 9:45	51.3	48.3	477.5	50
12/09/2024 10:00	66.6	42.7	382.6	50
12/09/2024 10:15	26.6	29.5	216	50
12/09/2024 10:30	54.9	64.4	393.1	50
12/09/2024 10:45	107	119.8	987.1	50
12/09/2024 11:00	149.9	200.9	697.7	50
12/09/2024 11:15	198.2	119	576	50
12/09/2024 11:30	81.8	99	569.9	50
12/09/2024 11:45	213	279	1455.6	50
12/09/2024 12:00	103.3	152.8	1166.5	50
12/09/2024 12:15	84.5	105.5	570.8	50
12/09/2024 12:30	115	136.9	514.7	50
12/09/2024 12:45	111.7	123.6	728.3	50
12/09/2024 13:00	31.2	31.2	143.4	50
12/09/2024 13:15	35.9	32.6	167.8	50
12/09/2024 13:30	227.7	318.4	2961.8	50
12/09/2024 13:45	62.3	54.5	448.4	50
12/09/2024 14:00	230.2	160.8	530.5	50
12/09/2024 14:15	102.7	87	492.2	50
12/09/2024 14:30	112.9	82.7	629.8	50
12/09/2024 14:45	39.2	69.8	174.1	50
12/09/2024 15:00	68.4	92.8	315.5	50
12/09/2024 15:15	78.3	90.9	403.7	50
12/09/2024 15:30	84.8	92.4	376	50
12/09/2024 15:45	277.3	274	1999.1	50
12/09/2024 16:00	103.7	108.1	622.3	50
12/09/2024 16:15	17.4	21.1	124.4	50
12/09/2024 16:30	48.3	41.5	369.4	50
12/09/2024 16:45	28.9	31.3	229.2	50
12/09/2024 17:00	17.3	20.5	126.9	50
12/09/2024 17:15	18.4	22.7	145.2	50
12/09/2024 17:30	18.9	18.6	100.2	50
12/09/2024 17:45	28	56.5	315.3	50
12/09/2024 18:00	16.6	17	88.7	50
12/09/2024 18:15	19	16.3	120	50
12/09/2024 18:30	16.8	19.9	117.9	50
12/09/2024 18:45	17.8	16.6	90.5	50
12/09/2024 19:00	15.3	17.2	90.6	50
12/09/2024 19:15	15.7	16.4	85.8	50
12/09/2024 19:30	17.1	16.8	86.7	50
12/09/2024 19:45	20.5	17.5	99.2	50
12/09/2024 20:00	15.9	16.3	89	50
12/09/2024 20:15	18.4	18.5	88.1	50
12/09/2024 20:30	15.5	16.5	83.2	50
12/09/2024 20:45	16.2	15.5	91.3	50
12/09/2024 21:00	16.5	18.6	86.2	50
12/09/2024 21:15	15	15.4	85.5	50
12/09/2024 21:30	18	15.7	86.6	50
12/09/2024 21:45	14.7	15.8	83.8	50
12/09/2024 22:00	19.3	17.5	99.6	50

12/09/2024 22:15	18.6	15.7	92.8	50
12/09/2024 22:30	17.5	15.8	86.1	50
12/09/2024 22:45	18.8	15.5	83.3	50
12/09/2024 23:00	17.8	14.8	83.9	50
12/09/2024 23:15	17.1	15.4	89.8	50
12/09/2024 23:30	15.1	17.2	117	50
12/09/2024 23:45	14.9	15.3	86.3	50
13/09/2024 0:00	17.7	15.8	96.7	50
13/09/2024 0:15	18.9	15	92.1	50
13/09/2024 0:30	18	15.9	95.6	50
13/09/2024 0:45	15.5	16	81.2	50
13/09/2024 1:00	17.3	15.3	87.8	50
13/09/2024 1:15	15.9	16.1	88.4	50
13/09/2024 1:30	14.5	15.2	88	50
13/09/2024 1:45	15.2	15.3	91	50
13/09/2024 2:00	18.5	15.2	87.7	50
13/09/2024 2:15	17	17.7	89.6	50
13/09/2024 2:30	17	17.2	91.2	50
13/09/2024 2:45	16.6	16.3	91.7	50
13/09/2024 3:00	14	18.7	88.6	50
13/09/2024 3:15	14.2	17.8	87.5	50
13/09/2024 3:30	15.9	15.5	95.1	50
13/09/2024 3:45	14.6	15.4	98	50
13/09/2024 4:00	15.8	15.9	91.8	50
13/09/2024 4:15	15.7	15.3	87.8	50
13/09/2024 4:30	19.1	16	87.5	50
13/09/2024 4:45	19.8	16.5	93.3	50
13/09/2024 5:00	14.3	14.6	85.7	50
13/09/2024 5:15	14.8	15.9	91.5	50
13/09/2024 5:30	14.8	17.6	90.6	50
13/09/2024 5:45	23.5	15.6	99.6	50
13/09/2024 6:00	16.3	16.4	88.9	50
13/09/2024 6:15	18.1	18.7	94.8	50
13/09/2024 6:30	16.4	16.9	92.6	50
13/09/2024 6:45	20.4	17.5	152.8	50
13/09/2024 7:00	229.9	189.5	1070	50
13/09/2024 7:15	120.8	136.1	920.4	50
13/09/2024 7:30	94.8	115.6	900.9	50
13/09/2024 7:45	84	102.1	483.5	50
13/09/2024 8:00	207.6	141.6	1061.2	50
13/09/2024 8:15	45.8	48.1	302.8	50
13/09/2024 8:30	117.9	127	881.7	50
13/09/2024 8:45	188.3	124.8	531.4	50
13/09/2024 9:00	49.3	46.5	417.8	50
13/09/2024 9:15	61.5	50.7	371.2	50
13/09/2024 9:30	116.6	88.6	862.6	50
13/09/2024 9:45	60.7	75.4	467.6	50
13/09/2024 10:00	251.9	238.6	1365.1	50
13/09/2024 10:15	468.3	396.1	2971.2	50
13/09/2024 10:30	153.3	131.2	765.6	50
13/09/2024 10:45	163.6	295.7	844.2	50
13/09/2024 11:00	167	173.2	809.8	50
13/09/2024 11:15	117.2	111.9	794	50
13/09/2024 11:30	145	98.6	726	50
13/09/2024 11:45	72.6	59.8	526.8	50
13/09/2024 12:00	167.3	117.6	1278.5	50
13/09/2024 12:15	55.2	42.7	341.7	50
13/09/2024 12:30	43.3	35.5	412.1	50
13/09/2024 12:45	28.5	26.6	238.8	50
13/09/2024 13:00	226.6	149.6	1580.9	50
13/09/2024 13:15	26.7	26.4	121.4	50
13/09/2024 13:30	30.9	31.4	243.4	50
13/09/2024 13:45	79.1	146.8	377.2	50
13/09/2024 14:00	125.7	129.7	675.8	50
13/09/2024 14:15	32.2	34.8	237.9	50
13/09/2024 14:30	594	670	3258.3	50
13/09/2024 14:45	104.3	121.9	652.6	50
13/09/2024 15:00	76.2	72.9	489.9	50
13/09/2024 15:15	69.6	50.4	342.5	50
13/09/2024 15:30	177.5	159.3	1102.7	50
13/09/2024 15:45	67.6	24.2	174.8	50
13/09/2024 16:00	17.2	19.5	117.5	50
13/09/2024 16:15	17.9	18	123.5	50
13/09/2024 16:30	44.7	100.8	463.3	50
13/09/2024 16:45	20.3	20.6	167.1	50
13/09/2024 17:00	17.8	15.9	158.4	50
13/09/2024 17:15	17	25.3	149.7	50
13/09/2024 17:30	15.2	16.4	105.5	50
13/09/2024 17:45	16.5	17.3	126	50
13/09/2024 18:00	16.9	18	94.8	50
13/09/2024 18:15	15.8	16.3	105.4	50
13/09/2024 18:30	15.8	16.7	87.9	50
13/09/2024 18:45	14.9	16.1	85.7	50
13/09/2024 19:00	91.1	15.2	91.2	50
13/09/2024 19:15	15.2	16.1	94.8	50
13/09/2024 19:30	21.5	21.6	156.9	50
13/09/2024 19:45	16	15.2	98.3	50
13/09/2024 20:00	19.1	16.6	89	50
13/09/2024 20:15	24.1	23.5	152.6	50
13/09/2024 20:30	15.1	16.8	96.4	50
13/09/2024 20:45	18.9	17.8	85.8	50
13/09/2024 21:00	15	17.5	90.3	50
13/09/2024 21:15	14.5	16.1	84.8	50
13/09/2024 21:30	15.1	16.4	103.1	50
13/09/2024 21:45	15.2	15.1	92.2	50
13/09/2024 22:00	16.6	15.9	88.3	50
13/09/2024 22:15	14.5	15.3	87.5	50
13/09/2024 22:30	15.1	15	89.2	50
13/09/2024 22:45	14.6	16.5	92.5	50
13/09/2024 23:00	14.9	16.5	85.9	50
13/09/2024 23:15	14.9	15.4	93.4	50
13/09/2024 23:30	15.4	15.6	95.5	50
13/09/2024 23:45	15.1	15.7	89	50
14/09/2024 0:00	15.3	16.6	98.4	50
14/09/2024 0:15	15.3	16.4	91.1	50
14/09/2024 0:30	15.5	15.1	89.7	50
14/09/2024 0:45	16.3	15.2	87.3	50
14/09/2024 1:00	14.6	15.6	84.7	50
14/09/2024 1:15	14.2	15.8	90.6	50
14/09/2024 1:30	14.6	17	85.4	50
14/09/2024 1:45	18	15.5	91.8	50
14/09/2024 2:00	15.9	16.1	90.9	50
14/09/2024 2:15	20.3	18.1	91.9	50
14/09/2024 2:30	17.5	14.8	91.4	50
14/09/2024 2:45	18.3	15.2	88	50
14/09/2024 3:00	17.5	18	100.4	50
14/09/2024 3:15	17.1	14.8	91.9	50
14/09/2024 3:30	15.8	15.6	89	50
14/09/2024 3:45	15.1	16.6	85.2	50
14/09/2024 4:00	15.4	15.9	89	50
14/09/2024 4:15	14.7	16.7	89.9	50
14/09/2024 4:30	14.6	15.5	100.9	50
14/09/2024 4:45	16.3	16.4	85.8	50
14/09/2024 5:00	15.7	15.3	98.3	50
14/09/2024 5:15	18.3	16.6	97.3	50
14/09/2024 5:30	15.4	16.2	89.3	50
14/09/2024 5:45	14.1	18.5	85.7	50
14/09/2024 6:00	14.8	16.7	89.3	50
14/09/2024 6:15	17	17.7	90.6	50
14/09/2024 6:30	16.1	15.4	90.6	50
14/09/2024 6:45	17.2	17.6	91.3	50
14/09/2024 7:00	16.5	20.7	94.9	50
14/09/2024 7:15	36.9	65.9	260.6	50
14/09/2024 7:30	108.5	93.4	807.3	50
14/09/2024 7:45	111.5	99.2	765.3	50
14/09/2024 8:00	91.5	98.1	752.5	50
14/09/2024 8:15	73	57	495	50
14/09/2024 8:30	92.8	74.1	338.9	50
14/09/2024 8:45	84.9	62.1	344.6	50
14/09/2024 9:00	82.1	51.8	305.5	50
14/09/2024 9:15	57.7	58.4	270.6	50
14/09/2024 9:30	54.4	49.6	316.5	50

14/09/2024 9:45	16.4	20.7	93.8	50
14/09/2024 10:00	17.4	19.1	98.3	50
14/09/2024 10:15	16.7	21.7	84.7	50
14/09/2024 10:30	21.8	28.6	105.2	50
14/09/2024 10:45	28	36.1	153.4	50
14/09/2024 11:00	49.7	45.2	202.4	50
14/09/2024 11:15	40.5	31.1	134.6	50
14/09/2024 11:30	23	22.1	103.5	50
14/09/2024 11:45	16.1	18.8	92.2	50
14/09/2024 12:00	26.8	21.3	106.1	50
14/09/2024 12:15	15.2	19.6	86.1	50
14/09/2024 12:30	14.8	17.2	94.6	50
14/09/2024 12:45	15.4	18.7	103.7	50
14/09/2024 13:00	15.3	17.2	97.2	50
14/09/2024 13:15	14.4	17.6	101.8	50
14/09/2024 13:30	14.4	17.9	95	50
14/09/2024 13:45	15.8	16.6	90.2	50
14/09/2024 14:00	14.1	15.8	94.9	50
14/09/2024 14:15	15	15.8	93.9	50
14/09/2024 14:30	16.4	21.2	95.3	50
14/09/2024 14:45	15	18.1	90.4	50
14/09/2024 15:00	16.1	16.2	91.4	50
14/09/2024 15:15	19.6	13.4	92.5	50
14/09/2024 15:30	29.1	17	133.8	50
14/09/2024 15:45	17.5	15.8	86.4	50
14/09/2024 16:00	15	16.4	92.6	50
14/09/2024 16:15	14.5	15	97.5	50
14/09/2024 16:30	14.6	14.9	84.3	50
14/09/2024 16:45	14.5	15.9	95.3	50
14/09/2024 17:00	14.8	15	86.6	50
14/09/2024 17:15	13.8	14.5	91.7	50
14/09/2024 17:30	15.2	14.3	86.1	50
14/09/2024 17:45	14.7	16.5	89	50
14/09/2024 18:00	15.7	16.9	88.5	50
14/09/2024 18:15	14.4	16	90.8	50
14/09/2024 18:30	15.2	15.1	84.2	50
14/09/2024 18:45	16	15.9	99.2	50
14/09/2024 19:00	15.3	14.4	85.5	50
14/09/2024 19:15	14.7	14.4	84.2	50
14/09/2024 19:30	17	16.4	86.8	50
14/09/2024 19:45	17.4	16.9	89	50
14/09/2024 20:00	18.1	15.4	91.9	50
14/09/2024 20:15	16	16.2	84.6	50
14/09/2024 20:30	17.2	16.6	87.2	50
14/09/2024 20:45	15.7	16	89	50
14/09/2024 21:00	17.9	15.1	101.2	50
14/09/2024 21:15	14.8	15.8	92.9	50
14/09/2024 21:30	15.3	15.4	83.8	50
14/09/2024 21:45	14.9	14.9	103.3	50
14/09/2024 22:00	15.7	15.6	85.1	50
14/09/2024 22:15	15.9	15.4	88	50
14/09/2024 22:30	16.7	15.7	98.7	50
14/09/2024 22:45	14.7	16	89.6	50
14/09/2024 23:00	17.6	15.8	88.7	50
14/09/2024 23:15	15.4	15.6	92.9	50
14/09/2024 23:30	16.5	16	87.2	50
14/09/2024 23:45	14.9	15.8	82.9	50
15/09/2024 0:00	14.9	15.7	87.6	50
15/09/2024 0:15	15	16.6	87.3	50
15/09/2024 0:30	14.7	18.4	86.2	50
15/09/2024 0:45	14.8	15.8	84.8	50
15/09/2024 1:00	16.9	15.8	91.1	50
15/09/2024 1:15	14	15.7	87.7	50
15/09/2024 1:30	15.8	15.9	93.2	50
15/09/2024 1:45	15.4	15.1	85.8	50
15/09/2024 2:00	15.1	15.6	94.2	50
15/09/2024 2:15	17.1	15.6	90.2	50
15/09/2024 2:30	15.3	16.5	84.4	50
15/09/2024 2:45	15.5	15.5	95.8	50
15/09/2024 3:00	13.8	14.1	86.6	50
15/09/2024 3:15	15.9	15.3	91.3	50
15/09/2024 3:30	15.1	15	94.9	50
15/09/2024 3:45	14.5	16	94.8	50
15/09/2024 4:00	15.2	15.6	86.6	50
15/09/2024 4:15	14.9	16.9	85.3	50
15/09/2024 4:30	16.5	16.9	91.7	50
15/09/2024 4:45	14.9	15	89	50
15/09/2024 5:00	16.1	15.9	89.3	50
15/09/2024 5:15	14.5	17.4	84.4	50
15/09/2024 5:30	14.9	15.8	86.6	50
15/09/2024 5:45	15.6	15.7	88.3	50
15/09/2024 6:00	14.4	15.8	85.8	50
15/09/2024 6:15	17.9	17.3	100	50
15/09/2024 6:30	15.8	17.2	98.8	50
15/09/2024 6:45	16.6	16.1	97.6	50
15/09/2024 7:00	15.6	16.9	89.2	50
15/09/2024 7:15	15.8	16.8	99.5	50
15/09/2024 7:30	15.5	16.8	94.7	50
15/09/2024 7:45	16.3	16.2	98	50
15/09/2024 8:00	16.6	16.8	92	50
15/09/2024 8:15	15	17.6	93	50
15/09/2024 8:30	17	16.7	96.6	50
15/09/2024 8:45	15.6	17.4	103.3	50
15/09/2024 9:00	15.9	16	87.6	50
15/09/2024 9:15	17.2	18	104.1	50
15/09/2024 9:30	17.8	17.6	96.8	50
15/09/2024 9:45	19.9	18.2	148.5	50
15/09/2024 10:00	18.8	19	109.7	50
15/09/2024 10:15	17.7	17.3	111.9	50
15/09/2024 10:30	23.4	20	146.6	50
15/09/2024 10:45	18.4	18.4	99.8	50
15/09/2024 11:00	19.2	19.6	112.2	50
15/09/2024 11:15	20.7	21.7	103.2	50
15/09/2024 11:30	22.3	21.2	109	50
15/09/2024 11:45	22	22.1	112.8	50
15/09/2024 12:00	19.4	19.1	101.4	50
15/09/2024 12:15	22	22.8	147.6	50
15/09/2024 12:30	51.2	37.6	297.6	50
15/09/2024 12:45	23.7	23.8	103.9	50
15/09/2024 13:00	22.4	40.6	110.9	50
15/09/2024 13:15	22.2	20.4	100.8	50
15/09/2024 13:30	22.8	20	119.5	50
15/09/2024 13:45	24.4	25.9	102.6	50
15/09/2024 14:00	22.8	24.8	99.7	50
15/09/2024 14:15	20.3	21.8	138.6	50
15/09/2024 14:30	18.3	18.9	111.1	50
15/09/2024 14:45	16.4	18.7	87.5	50
15/09/2024 15:00	18.1	19.2	90.2	50
15/09/2024 15:15	18.2	18.1	103.6	50
15/09/2024 15:30	17	19	92.9	50
15/09/2024 15:45	17.1	18.1	99.4	50
15/09/2024 16:00	17.1	18.1	89.7	50
15/09/2024 16:15	17.9	17	88.7	50
15/09/2024 16:30	16.8	17.8	96	50
15/09/2024 16:45	16.5	17.3	89.8	50
15/09/2024 17:00	18.8	23.7	129	50
15/09/2024 17:15	15.2	15.5	98.2	50
15/09/2024 17:30	16.2	16.5	92.8	50
15/09/2024 17:45	16	17.3	99.7	50
15/09/2024 18:00	15.8	19.5	93.8	50
15/09/2024 18:15	15	16.5	92.9	50
15/09/2024 18:30	16.7	19.5	93.2	50
15/09/2024 18:45	16.6	17.4	92.3	50
15/09/2024 19:00	16	16.4	103.8	50
15/09/2024 19:15	17.5	16.1	100.8	50
15/09/2024 19:30	17.7	15.3	94.6	50
15/09/2024 19:45	15.1	15.6	81.7	50
15/09/2024 20:00	15.6	15.6	89.8	50
15/09/2024 20:15	16.7	15.2	89.1	50
15/09/2024 20:30	15.3	14.4	91	50
15/09/2024 20:45	14.4	15.2	98.6	50
15/09/2024 21:00	14.8	15.2	88.5	50

15/09/2024 21:15	14.5	14.7	93.8	50
15/09/2024 21:30	15.1	16.3	86.3	50
15/09/2024 21:45	16	16.4	94.5	50
15/09/2024 22:00	15.6	15.8	109.6	50
15/09/2024 22:15	14.5	15.7	87.2	50
15/09/2024 22:30	15.4	15.8	87.5	50
15/09/2024 22:45	18	15.7	89.7	50
15/09/2024 23:00	16.6	15.7	94	50
15/09/2024 23:15	14.1	15.4	92	50
15/09/2024 23:30	14.7	15.4	91	50
15/09/2024 23:45	15.3	16.1	97.6	50
16/09/2024 0:00	15	15.6	90.1	50
16/09/2024 0:15	14.2	16.4	122.1	50
16/09/2024 0:30	15.7	14.5	92.5	50
16/09/2024 0:45	15.4	15.6	89.1	50
16/09/2024 1:00	17.6	16.5	88.2	50
16/09/2024 1:15	14.6	14.9	85.2	50
16/09/2024 1:30	16	15.5	98.8	50
16/09/2024 1:45	15.4	15.7	85.9	50
16/09/2024 2:00	15.7	16.5	89.7	50
16/09/2024 2:15	14.9	15.5	86.3	50
16/09/2024 2:30	15.4	16.6	90.1	50
16/09/2024 2:45	14.9	15.5	88.1	50
16/09/2024 3:00	15.9	16.3	86.2	50
16/09/2024 3:15	15.9	17.6	89.3	50
16/09/2024 3:30	15.5	19.2	96.8	50
16/09/2024 3:45	16.2	16.3	93.7	50
16/09/2024 4:00	14	16	97.7	50
16/09/2024 4:15	14	16.3	89.1	50
16/09/2024 4:30	14.7	16.5	91.4	50
16/09/2024 4:45	16.3	16	89.4	50
16/09/2024 5:00	17.4	16.7	96.8	50
16/09/2024 5:15	14.2	17.1	87.6	50
16/09/2024 5:30	15.7	16.5	94.6	50
16/09/2024 5:45	19.7	17	121.7	50
16/09/2024 6:00	15.9	17.7	121.8	50
16/09/2024 6:15	17.1	18.4	98.4	50
16/09/2024 6:30	15.3	18.9	99.2	50
16/09/2024 6:45	90.5	95.8	594.4	50
16/09/2024 7:00	60	37.6	260.1	50
16/09/2024 7:15	66	71.1	369.7	50
16/09/2024 7:30	194.6	175.7	855.6	50
16/09/2024 7:45	77.1	64.8	515.6	50
16/09/2024 8:00	78.4	86.6	477.3	50
16/09/2024 8:15	22.9	25.3	130.5	50
16/09/2024 8:30	30.9	30.8	131.7	50
16/09/2024 8:45	36.9	38.3	133.1	50
16/09/2024 9:00	36.5	26.5	239.9	50
16/09/2024 9:15	35.5	26.9	168.8	50
16/09/2024 9:30	72.8	69.7	314.1	50
16/09/2024 9:45	88.4	71	705.1	50
16/09/2024 10:00	35.3	33.5	322.5	50
16/09/2024 10:15	47.6	43.5	317.6	50
16/09/2024 10:30	26.5	38.2	166	50
16/09/2024 10:45	21.5	25.2	182.2	50
16/09/2024 11:00	69.4	66	328	50
16/09/2024 11:15	70.9	57	494.7	50
16/09/2024 11:30	117.6	114.1	683.6	50
16/09/2024 11:45	59	80.6	289	50
16/09/2024 12:00	72.7	60.4	556.3	50
16/09/2024 12:15	26.9	49.7	236.1	50
16/09/2024 12:30	316.8	206.6	1496.7	50
16/09/2024 12:45	114.8	140.5	179	50
16/09/2024 13:00	19.5	24.3	146.3	50
16/09/2024 13:15	134.2	102.6	882.9	50
16/09/2024 13:30	29.1	35.9	138.6	50
16/09/2024 13:45	31.7	29.2	237.2	50
16/09/2024 14:00	38.1	31.6	422.8	50
16/09/2024 14:15	171.1	117.1	972.9	50
16/09/2024 14:30	54.2	34.4	206.6	50
16/09/2024 14:45	30.7	34.3	239.8	50
16/09/2024 15:00	25.6	27.4	212.7	50
16/09/2024 15:15	192.4	226.4	1269.7	50
16/09/2024 15:30	128.7	144.6	1043.3	50
16/09/2024 15:45	123.4	151.6	1176.1	50
16/09/2024 16:00	96	105.2	863.5	50
16/09/2024 16:15	168.6	152	1169.1	50
16/09/2024 16:30	21.5	25.9	117.7	50
16/09/2024 16:45	20.8	29.6	115.3	50
16/09/2024 17:00	18.5	18.5	123.4	50
16/09/2024 17:15	16.6	17.6	118.4	50
16/09/2024 17:30	17.2	17.2	136.7	50
16/09/2024 17:45	17.5	16.9	105.5	50
16/09/2024 18:00	20.4	25.4	144.4	50
16/09/2024 18:15	16.2	17.2	91.6	50
16/09/2024 18:30	14.8	16.7	91	50
16/09/2024 18:45	15.4	16.9	109.6	50
16/09/2024 19:00	17.6	14.3	94.6	50
16/09/2024 19:15	15.2	15.7	88.4	50
16/09/2024 19:30	15.7	15.2	89.6	50
16/09/2024 19:45	15.3	15	84.6	50
16/09/2024 20:00	15.6	16.1	86.3	50
16/09/2024 20:15	15.6	15.6	94.6	50
16/09/2024 20:30	15.5	16.9	94.1	50
16/09/2024 20:45	15.8	15.1	94.6	50
16/09/2024 21:00	15.4	15.2	86.1	50
16/09/2024 21:15	15.2	16.4	95.5	50
16/09/2024 21:30	17.8	15	84.7	50
16/09/2024 21:45	14.9	15.9	94	50
16/09/2024 22:00	17	15.4	91.2	50
16/09/2024 22:15	14.6	14.3	83.1	50
16/09/2024 22:30	15.3	16.2	97.5	50
16/09/2024 22:45	15	15	89.5	50
16/09/2024 23:00	16.3	16.9	108.8	50
16/09/2024 23:15	14.1	15.6	108.7	50
16/09/2024 23:30	15.1	15.8	89.8	50
16/09/2024 23:45	14.5	15.7	95.3	50
17/09/2024 0:00	14.5	16.1	94.2	50
17/09/2024 0:15	15.8	15.1	91.4	50
17/09/2024 0:30	14.4	15	87.7	50
17/09/2024 0:45	16.6	16.6	92.5	50
17/09/2024 1:00	15	15.2	88.7	50
17/09/2024 1:15	15.6	15.9	88	50
17/09/2024 1:30	15.8	16.7	91.4	50
17/09/2024 1:45	14.5	16.7	87.8	50
17/09/2024 2:00	15.5	16.1	87.2	50
17/09/2024 2:15	15.6	14.9	94.7	50
17/09/2024 2:30	15.4	16.5	93	50
17/09/2024 2:45	16.1	17.6	87.9	50
17/09/2024 3:00	15	14.5	89.7	50
17/09/2024 3:15	15.4	15.6	98	50
17/09/2024 3:30	15.9	16.6	85.8	50
17/09/2024 3:45	14.6	15.4	86.5	50
17/09/2024 4:00	15.8	16.1	91.8	50
17/09/2024 4:15	16.4	16.4	90.7	50
17/09/2024 4:30	15.4	15.5	95.9	50
17/09/2024 4:45	17	16.5	87.7	50
17/09/2024 5:00	15.2	16.3	83.3	50
17/09/2024 5:15	15.2	16	94.6	50
17/09/2024 5:30	17.3	16	87.1	50
17/09/2024 5:45	27.8	21.3	132.9	50
17/09/2024 6:00	15.7	18.4	90.7	50
17/09/2024 6:15	21.7	24.5	110.6	50
17/09/2024 6:30	22.7	24.2	94.1	50
17/09/2024 6:45	39.4	23	144.1	50
17/09/2024 7:00	19.6	18.1	151.6	50
17/09/2024 7:15	68.4	76.8	351.8	50
17/09/2024 7:30	48.9	28.9	363.2	50
17/09/2024 7:45	32.5	38.7	223.5	50
17/09/2024 8:00	59.9	52.8	265.5	50
17/09/2024 8:15	35.6	73.4	617.9	50
17/09/2024 8:30	40.6	92.7	467.8	50

17/09/2024 8:45	59.4	56.5	186.9	50
17/09/2024 9:00	54.5	50.3	227.1	50
17/09/2024 9:15	61.1	64.9	214	50
17/09/2024 9:30	60.1	64	224	50
17/09/2024 9:45	54.5	48.7	242.9	50
17/09/2024 10:00	73	69	505.8	50
17/09/2024 10:15	79.9	78	653.3	50
17/09/2024 10:30	63.5	57.4	312	50
17/09/2024 10:45	53.8	41.1	313.2	50
17/09/2024 11:00	35.4	44.5	188.8	50
17/09/2024 11:15	39.1	46.6	214.1	50
17/09/2024 11:30	54	55.1	402.3	50
17/09/2024 11:45	53.9	50.1	319.4	50
17/09/2024 12:00	78.1	50	169.8	50
17/09/2024 12:15	60.6	46.3	277.9	50
17/09/2024 12:30	39	35.7	264.9	50
17/09/2024 12:45	37.1	35.8	204.1	50
17/09/2024 13:00	24.8	20.3	209.8	50
17/09/2024 13:15	35.7	38.9	375.5	50
17/09/2024 13:30	58.7	59.2	555.2	50
17/09/2024 13:45	61.5	56.5	374.4	50
17/09/2024 14:00	63.9	63.1	343	50
17/09/2024 14:15	52.2	48.4	312.8	50
17/09/2024 14:30	59.7	57.8	368.7	50
17/09/2024 14:45	47.6	45	328.7	50
17/09/2024 15:00	52.5	64.3	311.2	50
17/09/2024 15:15	30.8	24	207.5	50
17/09/2024 15:30	72.7	29.5	497.3	50
17/09/2024 15:45	43.3	36.6	256.1	50
17/09/2024 16:00	38.2	46.1	142.7	50
17/09/2024 16:15	41.8	36.2	322	50
17/09/2024 16:30	46.2	35.2	362.1	50
17/09/2024 16:45	26.9	49	245.9	50
17/09/2024 17:00	21.9	16.8	172.8	50
17/09/2024 17:15	33	42.4	324.9	50
17/09/2024 17:30	20.7	31	213.8	50
17/09/2024 17:45	25.5	18.9	134.2	50
17/09/2024 18:00	21	15.8	137.7	50
17/09/2024 18:15	28.6	16.3	141.1	50
17/09/2024 18:30	16.2	15	92.8	50
17/09/2024 18:45	14.9	17.9	94.3	50
17/09/2024 19:00	15.7	14.7	94.1	50
17/09/2024 19:15	15.5	16.2	98	50
17/09/2024 19:30	20.6	14.6	132.4	50
17/09/2024 19:45	30.5	21.6	191.7	50
17/09/2024 20:00	14.8	14.2	80.5	50
17/09/2024 20:15	15.7	15.7	93.5	50
17/09/2024 20:30	14.8	16.3	99.5	50
17/09/2024 20:45	14.7	15.9	83.3	50
17/09/2024 21:00	15.3	15.9	83.8	50
17/09/2024 21:15	15.5	17	103.9	50
17/09/2024 21:30	15.3	15.4	93	50
17/09/2024 21:45	15.3	14.3	89	50
17/09/2024 22:00	15	15.2	82.9	50
17/09/2024 22:15	15.3	15	92.9	50
17/09/2024 22:30	15.5	16.4	90.1	50
17/09/2024 22:45	16.2	15.7	99.5	50
17/09/2024 23:00	17.1	15.5	91.7	50
17/09/2024 23:15	20.6	17	121.2	50
17/09/2024 23:30	14.5	16.7	93.8	50
17/09/2024 23:45	23.5	16.1	91.6	50
18/09/2024 0:00	15.8	15.3	89.9	50
18/09/2024 0:15	17.7	16.2	87	50
18/09/2024 0:30	14.7	17.4	88.2	50
18/09/2024 0:45	14.5	16.3	87.3	50
18/09/2024 1:00	14.7	15.2	88.8	50
18/09/2024 1:15	15.6	16.2	84.2	50
18/09/2024 1:30	14.7	16.6	85.1	50
18/09/2024 1:45	14.5	17.1	88.8	50
18/09/2024 2:00	14.3	15.9	90.6	50
18/09/2024 2:15	14.6	16.3	94.1	50
18/09/2024 2:30	15.2	17.9	89	50
18/09/2024 2:45	19.4	15.8	84.1	50
18/09/2024 3:00	15.4	16.4	92.8	50
18/09/2024 3:15	14.4	15.9	86.4	50
18/09/2024 3:30	16.5	16.2	85.2	50
18/09/2024 3:45	15.9	16.3	85.7	50
18/09/2024 4:00	14.8	17.5	94	50
18/09/2024 4:15	25.5	26.3	184.3	50
18/09/2024 4:30	16.2	15	90.5	50
18/09/2024 4:45	14.4	17	85.7	50
18/09/2024 5:00	16	17.2	92	50
18/09/2024 5:15	15	16.3	81.1	50
18/09/2024 5:30	16.4	17.2	91.7	50
18/09/2024 5:45	15.8	17.4	88.9	50
18/09/2024 6:00	17.3	17.4	118.2	50
18/09/2024 6:15	17.6	16.7	116.5	50
18/09/2024 6:30	17.2	17.9	86	50
18/09/2024 6:45	21.5	17	88.2	50
18/09/2024 7:00	37.6	29.9	167.2	50
18/09/2024 7:15	58.3	63.6	189.9	50
18/09/2024 7:30	52.2	50.6	163	50
18/09/2024 7:45	36	37.1	136.3	50
18/09/2024 8:00	88.6	74.4	231	50
18/09/2024 8:15	71	71.2	254.5	50
18/09/2024 8:30	31.8	31.6	159.1	50
18/09/2024 8:45	67.5	86	263	50
18/09/2024 9:00	24	26.6	182.4	50
18/09/2024 9:15	68.1	90.1	254.5	50
18/09/2024 9:30	117.1	143.9	509.9	50
18/09/2024 9:45	150.4	130.1	550.9	50
18/09/2024 10:00	151.5	103.1	502.1	50
18/09/2024 10:15	124.3	119.1	494	50
18/09/2024 10:30	132.4	148.6	500.2	50
18/09/2024 10:45	120.5	148.6	529.9	50
18/09/2024 11:00	128.5	115.3	455.5	50
18/09/2024 11:15	17.7	19.4	112.5	50
18/09/2024 11:30	24.3	18.5	226.3	50
18/09/2024 11:45	21.6	19.5	121.6	50
18/09/2024 12:00	118.3	115.7	448.8	50
18/09/2024 12:15	115.3	111.3	556.1	50
18/09/2024 12:30	28.9	26.1	155.9	50
18/09/2024 12:45	53.6	33.1	404.1	50
18/09/2024 13:00	42	23.3	320.4	50
18/09/2024 13:15	78.1	41.6	605.8	50
18/09/2024 13:30	163.5	108.6	1252.6	50
18/09/2024 13:45	31.1	37.7	253	50
18/09/2024 14:00	54.9	138.3	719.2	50
18/09/2024 14:15	48.5	65.5	385.6	50
18/09/2024 14:30	29.5	24.5	207.2	50
18/09/2024 14:45	80.7	81.6	658.4	50
18/09/2024 15:00	62.8	90.3	902.6	50
18/09/2024 15:15	68.8	35.5	471.5	50
18/09/2024 15:30	27.8	30.8	217.4	50
18/09/2024 15:45	23.6	30.6	166.4	50
18/09/2024 16:00	28.7	26.8	241.2	50
18/09/2024 16:15	20.1	27	146.5	50
18/09/2024 16:30	21.2	20.5	131.8	50
18/09/2024 16:45	16.2	16.2	110.3	50
18/09/2024 17:00	17.1	17.9	162.2	50
18/09/2024 17:15	16.2	15.1	91.8	50
18/09/2024 17:30	17.3	15.9	89.8	50
18/09/2024 17:45	19.2	23.7	86	50
18/09/2024 18:00	15	15	86.1	50
18/09/2024 18:15	15.2	19	83	50
18/09/2024 18:30	42	40.9	365	50
18/09/2024 18:45	19.4	14.5	116.1	50
18/09/2024 19:00	18.9	14.9	86.7	50
18/09/2024 19:15	15	16.8	112.1	50
18/09/2024 19:30	14.6	16.5	99.3	50
18/09/2024 19:45	14.8	15.6	83.7	50
18/09/2024 20:00	17.9	24.6	84.8	50

18/09/2024 20:15	14.9	15	89.1	50
18/09/2024 20:30	19	14.2	144.8	50
18/09/2024 20:45	15.3	14.6	80.1	50
18/09/2024 21:00	15.5	13.9	81.3	50
18/09/2024 21:15	15.7	15.3	85.6	50
18/09/2024 21:30	14.5	13.9	84.8	50
18/09/2024 21:45	14.8	14	79.6	50
18/09/2024 22:00	15.2	15.1	81	50
18/09/2024 22:15	15.2	14.9	78.8	50
18/09/2024 22:30	14.7	14.6	83.1	50
18/09/2024 22:45	15.8	14.8	86.5	50
18/09/2024 23:00	15.6	14.1	90.4	50
18/09/2024 23:15	15.6	15	99.8	50
18/09/2024 23:30	14.3	14	92.6	50
18/09/2024 23:45	15.1	13.6	83.3	50
19/09/2024 0:00	14.8	14	86.5	50
19/09/2024 0:15	14.9	16.1	84.9	50
19/09/2024 0:30	16.8	14.1	88.1	50
19/09/2024 0:45	14.4	14.8	88.3	50
19/09/2024 1:00	14.5	14.2	82.3	50
19/09/2024 1:15	14.7	16	123.5	50
19/09/2024 1:30	15.2	14.8	84.2	50
19/09/2024 1:45	14.8	14.8	99.8	50
19/09/2024 2:00	15.4	14.3	83.8	50
19/09/2024 2:15	15.1	14.1	91.9	50
19/09/2024 2:30	14.7	13.9	85.8	50
19/09/2024 2:45	15	15.3	85.2	50
19/09/2024 3:00	14.1	14.1	83.3	50
19/09/2024 3:15	17.8	14.4	89.9	50
19/09/2024 3:30	16.2	14.4	84.8	50
19/09/2024 3:45	17.1	14.2	79.7	50
19/09/2024 4:00	16.2	14.1	89.6	50
19/09/2024 4:15	17.6	14.2	83.1	50
19/09/2024 4:30	14.1	17.1	87.9	50
19/09/2024 4:45	16.2	14.3	81.3	50
19/09/2024 5:00	14.5	13.5	83.4	50
19/09/2024 5:15	15.8	14.7	86.7	50
19/09/2024 5:30	18.5	14.8	99.8	50
19/09/2024 5:45	30.4	15.6	139	50
19/09/2024 6:00	23	21.2	136.9	50
19/09/2024 6:15	19.1	18.2	91.3	50
19/09/2024 6:30	16.5	16	85.6	50
19/09/2024 6:45	21.2	16.3	99	50
19/09/2024 7:00	96.8	39	369.6	50
19/09/2024 7:15	118.1	109.6	432.1	50
19/09/2024 7:30	115.3	111.3	414.1	50
19/09/2024 7:45	105.6	105.7	400.9	50
19/09/2024 8:00	83.7	87.1	350.3	50
19/09/2024 8:15	52.2	51.8	205	50
19/09/2024 8:30	63.9	59.4	410.8	50
19/09/2024 8:45	45.4	42.1	180.1	50
19/09/2024 9:00	62.9	65	427.4	50
19/09/2024 9:15	80.6	77.8	652.3	50
19/09/2024 9:30	77.3	62.8	418.8	50
19/09/2024 9:45	39	33.7	189.6	50
19/09/2024 10:00	62.5	66.2	469.6	50
19/09/2024 10:15	59.4	51.7	298.2	50
19/09/2024 10:30	69.8	43.7	153.1	50
19/09/2024 10:45	38.1	41.9	155	50
19/09/2024 11:00	22.5	28.6	159.5	50
19/09/2024 11:15	30	53	141.6	50
19/09/2024 11:30	80.1	57.4	239.5	50
19/09/2024 11:45	32.2	26.6	145.8	50
19/09/2024 12:00	47	44.4	140.4	50
19/09/2024 12:15	33.6	43.1	150.3	50
19/09/2024 12:30	24.9	32.7	158	50
19/09/2024 12:45	52.2	53.2	290.1	50
19/09/2024 13:00	58	57.8	287.9	50
19/09/2024 13:15	41.9	75.3	327.8	50
19/09/2024 13:30	59.8	40.8	307.4	50
19/09/2024 13:45	49.2	42.5	255.2	50
19/09/2024 14:00	55.6	76.5	267.2	50
19/09/2024 14:15	81.5	53	442.6	50
19/09/2024 14:30	34.2	30.8	187.3	50
19/09/2024 14:45	26	33.7	253.1	50
19/09/2024 15:00	56.9	49	309.4	50
19/09/2024 15:15	55.3	66.5	351.4	50
19/09/2024 15:30	39.9	30.6	202.3	50
19/09/2024 15:45	29.8	24.4	148.5	50
19/09/2024 16:00	27.4	49.4	193.2	50
19/09/2024 16:15	18.9	22	106.7	50
19/09/2024 16:30	18.6	18.2	85.6	50
19/09/2024 16:45	21.9	21.6	105.8	50
19/09/2024 17:00	16.3	21.9	99.8	50
19/09/2024 17:15	15.7	21.2	82.6	50
19/09/2024 17:30	42.7	33.5	134.3	50
19/09/2024 17:45	15.8	15.9	84.9	50
19/09/2024 18:00	20	15.5	100.6	50
19/09/2024 18:15	17.3	15.7	85.8	50
19/09/2024 18:30	15.7	16.3	118.5	50
19/09/2024 18:45	15.6	15.7	97.9	50
19/09/2024 19:00	15.2	15.5	84.1	50
19/09/2024 19:15	15.2	15.1	87	50
19/09/2024 19:30	15	15.6	86.3	50
19/09/2024 19:45	15.1	15	89	50
19/09/2024 20:00	14.9	14.7	77.5	50
19/09/2024 20:15	15.4	15.7	99.9	50
19/09/2024 20:30	17.3	15.7	84.6	50
19/09/2024 20:45	14.8	15.5	89.8	50
19/09/2024 21:00	18.6	16.8	86.3	50
19/09/2024 21:15	14.7	15.7	86.7	50
19/09/2024 21:30	15.1	14.3	84.5	50
19/09/2024 21:45	15.4	15.5	90.3	50
19/09/2024 22:00	15.7	15.1	100.1	50
19/09/2024 22:15	16.7	15	88.2	50
19/09/2024 22:30	15.1	14.1	84.7	50
19/09/2024 22:45	15.1	14.5	81.8	50
19/09/2024 23:00	14.6	14.4	84.8	50
19/09/2024 23:15	14.9	14.7	80.1	50
19/09/2024 23:30	16.5	15.3	82.7	50
19/09/2024 23:45	16.4	14.8	84.5	50
20/09/2024 0:00	18.1	15.1	81.6	50
20/09/2024 0:15	16.7	16.1	86.2	50
20/09/2024 0:30	15.5	15.9	93.4	50
20/09/2024 0:45	15.3	15.1	88.5	50
20/09/2024 1:00	17.2	16.5	77.9	50
20/09/2024 1:15	15.8	16.4	86.4	50
20/09/2024 1:30	17.2	15.1	85.4	50
20/09/2024 1:45	15.1	14.6	81.1	50
20/09/2024 2:00	15.8	15	85.9	50
20/09/2024 2:15	15.2	14.7	90.2	50
20/09/2024 2:30	16.7	15.6	86	50
20/09/2024 2:45	20.4	19.1	83.7	50
20/09/2024 3:00	17.1	14.6	80.5	50
20/09/2024 3:15	17.4	15.4	88.1	50
20/09/2024 3:30	15.3	15.6	87.1	50
20/09/2024 3:45	14.6	15.7	81.6	50
20/09/2024 4:00	16.7	15.6	87.9	50
20/09/2024 4:15	15.3	14.6	78.5	50
20/09/2024 4:30	16.3	16.2	88.1	50
20/09/2024 4:45	17	15.1	90.4	50
20/09/2024 5:00	16.3	17.3	79.7	50
20/09/2024 5:15	14.3	15.3	85.3	50
20/09/2024 5:30	15.6	16.1	90.2	50
20/09/2024 5:45	22.6	19.2	95	50
20/09/2024 6:00	16.6	15.5	93.7	50
20/09/2024 6:15	16.5	15.9	91.2	50
20/09/2024 6:30	18.9	16.3	88.4	50
20/09/2024 6:45	18.9	15.2	86	50
20/09/2024 7:00	30	17.5	116.9	50
20/09/2024 7:15	19.4	16.6	91.5	50
20/09/2024 7:30	18.8	18.1	89.6	50

20/09/2024 7:45	20.3	19.3	137.4	50
20/09/2024 8:00	51.4	55.2	287.9	50
20/09/2024 8:15	59.1	47.9	305.5	50
20/09/2024 8:30	53.1	41.4	253.2	50
20/09/2024 8:45	46.9	75	416.7	50
20/09/2024 9:00	53.2	36.6	292.9	50
20/09/2024 9:15	46.6	37.5	273.1	50
20/09/2024 9:30	48.2	47.7	244.9	50
20/09/2024 9:45	42	39.3	183.8	50
20/09/2024 10:00	64.1	49.9	252.2	50
20/09/2024 10:15	43.6	31.7	199.8	50
20/09/2024 10:30	22	20	129	50
20/09/2024 10:45	42.2	64.4	364.9	50
20/09/2024 11:00	42.1	46.4	371.8	50
20/09/2024 11:15	62.8	41.3	325.3	50
20/09/2024 11:30	54.2	56.2	247.7	50
20/09/2024 11:45	58.3	42.2	267.3	50
20/09/2024 12:00	37.6	37.5	231.2	50
20/09/2024 12:15	53.8	110.1	501.3	50
20/09/2024 12:30	24.8	34.8	244.5	50
20/09/2024 12:45	21.4	22.5	103.5	50
20/09/2024 13:00	84.4	43.6	202.4	50
20/09/2024 13:15	44.3	33.6	263.8	50
20/09/2024 13:30	18.7	19.1	101.4	50
20/09/2024 13:45	27.8	25.1	121.3	50
20/09/2024 14:00	21.7	22.4	100.4	50
20/09/2024 14:15	21.5	30.9	126.6	50
20/09/2024 14:30	19.6	18.4	121.7	50
20/09/2024 14:45	32.8	27.9	104.5	50
20/09/2024 15:00	27	48.5	137.5	50
20/09/2024 15:15	21.3	19	106.8	50
20/09/2024 15:30	16.5	16.8	97.3	50
20/09/2024 15:45	24.1	28.6	148.7	50
20/09/2024 16:00	25.6	28.4	124.4	50
20/09/2024 16:15	29.5	54.4	153.7	50
20/09/2024 16:30	29.3	47.5	170.9	50
20/09/2024 16:45	24.1	33.3	151.2	50
20/09/2024 17:00	16.2	15.8	95.4	50
20/09/2024 17:15	15.8	15.9	119.6	50
20/09/2024 17:30	16.9	15	94.1	50
20/09/2024 17:45	15	19.7	86.4	50
20/09/2024 18:00	14.2	15.6	87.7	50
20/09/2024 18:15	15.5	15.3	81.1	50
20/09/2024 18:30	16	15.2	142.8	50
20/09/2024 18:45	18	14.7	88.3	50
20/09/2024 19:00	15.8	17	87.9	50
20/09/2024 19:15	16.8	15.4	134.8	50
20/09/2024 19:30	15.5	16.1	85.8	50
20/09/2024 19:45	15.5	14.8	86	50
20/09/2024 20:00	15.9	14.8	92.5	50
20/09/2024 20:15	15.5	13.9	85.1	50
20/09/2024 20:30	13.4	14.1	89.6	50
20/09/2024 20:45	15.3	17.4	95.9	50
20/09/2024 21:00	15.5	15.2	90.2	50
20/09/2024 21:15	14.8	16	83.4	50
20/09/2024 21:30	15.2	16.5	87.5	50
20/09/2024 21:45	15.1	17.2	82.3	50
20/09/2024 22:00	14.8	14.1	103.7	50
20/09/2024 22:15	14	15.6	81.3	50
20/09/2024 22:30	17.9	15.5	90.6	50
20/09/2024 22:45	17.6	16.2	100.6	50
20/09/2024 23:00	15.6	14.2	89.4	50
20/09/2024 23:15	14.8	15.3	90	50
20/09/2024 23:30	14.9	15.5	87	50
20/09/2024 23:45	14.4	15.5	84.9	50
21/09/2024 0:00	16.9	16.1	82.6	50
21/09/2024 0:15	16.1	15.5	96.3	50
21/09/2024 0:30	15.7	14.7	85.9	50
21/09/2024 0:45	15	15.4	88.9	50
21/09/2024 1:00	15.6	16.5	85.9	50
21/09/2024 1:15	14.6	15	91.2	50
21/09/2024 1:30	15.5	15.5	82.7	50
21/09/2024 1:45	15	14.9	84.4	50
21/09/2024 2:00	17.7	15.6	87.1	50
21/09/2024 2:15	18.3	15.5	83.7	50
21/09/2024 2:30	14.7	16.1	89.1	50
21/09/2024 2:45	13.5	15	91.1	50
21/09/2024 3:00	16	15.2	96	50
21/09/2024 3:15	15.1	15.4	79.2	50
21/09/2024 3:30	15	16.4	93.5	50
21/09/2024 3:45	15.3	15.5	87.7	50
21/09/2024 4:00	15.1	17.3	97.3	50
21/09/2024 4:15	17.5	15.8	97.4	50
21/09/2024 4:30	17.4	16	86.6	50
21/09/2024 4:45	16.8	16.1	83.2	50
21/09/2024 5:00	16.7	16.3	86.9	50
21/09/2024 5:15	15.3	14.9	84.8	50
21/09/2024 5:30	15.9	15.7	84.5	50
21/09/2024 5:45	16.6	15.1	85.5	50
21/09/2024 6:00	21.5	17.4	95.5	50
21/09/2024 6:15	19	16.7	88	50
21/09/2024 6:30	20.3	18	178.5	50
21/09/2024 6:45	17.5	17.1	85.5	50
21/09/2024 7:00	17.3	15.6	81.3	50
21/09/2024 7:15	115.7	85.3	408.2	50
21/09/2024 7:30	69.9	86	317.3	50
21/09/2024 7:45	76.2	79.5	325.5	50
21/09/2024 8:00	77.1	98.1	359.3	50
21/09/2024 8:15	113.9	96	398.4	50
21/09/2024 8:30	89.3	73.8	377	50
21/09/2024 8:45	120.9	122	515.2	50
21/09/2024 9:00	57.9	64	267	50
21/09/2024 9:15	65.7	87	241.1	50
21/09/2024 9:30	54.1	87.6	242.9	50
21/09/2024 9:45	15	17.1	106.8	50
21/09/2024 10:00	16.6	18.3	87.9	50
21/09/2024 10:15	16	17.1	91.6	50
21/09/2024 10:30	47.7	60.9	218.3	50
21/09/2024 10:45	58.7	90.5	250.7	50
21/09/2024 11:00	57.6	77.4	348.5	50
21/09/2024 11:15	79.2	97.6	347.1	50
21/09/2024 11:30	75.8	95.9	349.9	50
21/09/2024 11:45	46.1	54.1	251.9	50
21/09/2024 12:00	46.7	45.3	275	50
21/09/2024 12:15	53.7	52	253.9	50
21/09/2024 12:30	23.4	25	88	50
21/09/2024 12:45	31.8	27	130.4	50
21/09/2024 13:00	15.5	17.6	91.6	50
21/09/2024 13:15	18	20.7	81.2	50
21/09/2024 13:30	16.3	17.5	102.2	50
21/09/2024 13:45	16.8	19.8	98.6	50
21/09/2024 14:00	14.9	17.8	87.9	50
21/09/2024 14:15	15.6	16.8	85.7	50
21/09/2024 14:30	15.7	16.7	104	50
21/09/2024 14:45	17.1	17.7	96.7	50
21/09/2024 15:00	18	16.6	90.8	50
21/09/2024 15:15	16.2	21.3	84.4	50
21/09/2024 15:30	17.8	25.7	87.6	50
21/09/2024 15:45	18.2	18	85.3	50
21/09/2024 16:00	15.5	15.8	88	50
21/09/2024 16:15	16.6	15.9	92.5	50
21/09/2024 16:30	14.3	17.3	88.8	50
21/09/2024 16:45	16.6	17	90	50
21/09/2024 17:00	14.9	16.1	89.3	50
21/09/2024 17:15	16.5	16.7	93.6	50
21/09/2024 17:30	16.4	14.8	90.2	50
21/09/2024 17:45	17	17.5	92.2	50
21/09/2024 18:00	15.9	19.3	91.8	50
21/09/2024 18:15	15.2	14.4	89.5	50
21/09/2024 18:30	17.6	14.7	90.8	50
21/09/2024 18:45	17	17.1	105.1	50
21/09/2024 19:00	15.3	16.4	86.5	50

21/09/2024 19:15	17.2	15	84.2	50
21/09/2024 19:30	18.8	15.8	79.8	50
21/09/2024 19:45	14	15.2	80.7	50
21/09/2024 20:00	15.4	14.7	83.9	50
21/09/2024 20:15	15	18.2	85.3	50
21/09/2024 20:30	15.3	15.4	86.2	50
21/09/2024 20:45	19.3	16	80.2	50
21/09/2024 21:00	17.1	16.5	84.8	50
21/09/2024 21:15	15.7	15.3	87	50
21/09/2024 21:30	18	16.6	106.8	50
21/09/2024 21:45	16.2	15.9	85.3	50
21/09/2024 22:00	15	16.2	86.4	50
21/09/2024 22:15	16.2	16.6	89.4	50
21/09/2024 22:30	17.8	14.8	84.7	50
21/09/2024 22:45	14.9	15.8	83.7	50
21/09/2024 23:00	23.9	25.4	137.9	50
21/09/2024 23:15	16	17.1	88.3	50
21/09/2024 23:30	14.8	16.6	90.8	50
21/09/2024 23:45	15	16.3	80.2	50
22/09/2024 0:00	16.1	15.9	83.4	50
22/09/2024 0:15	14.6	17.6	84.1	50
22/09/2024 0:30	16.1	15.1	89.8	50
22/09/2024 0:45	14.5	17.3	90.9	50
22/09/2024 1:00	15.2	15.6	94.4	50
22/09/2024 1:15	16.7	16.7	84.2	50
22/09/2024 1:30	14.1	14.1	93.7	50
22/09/2024 1:45	14.3	15	86.7	50
22/09/2024 2:00	15.5	15.4	82.9	50
22/09/2024 2:15	17.3	16	85.9	50
22/09/2024 2:30	16.7	15	83.3	50
22/09/2024 2:45	17	15.6	92.4	50
22/09/2024 3:00	14.1	14.7	79.3	50
22/09/2024 3:15	15	14.6	83.8	50
22/09/2024 3:30	14.9	14.7	87.5	50
22/09/2024 3:45	18.9	14.8	90.1	50
22/09/2024 4:00	16.1	15	84.3	50
22/09/2024 4:15	15.9	14.8	86.8	50
22/09/2024 4:30	14.5	16.7	92.1	50
22/09/2024 4:45	14.2	14.5	85.8	50
22/09/2024 5:00	15.2	15.8	91	50
22/09/2024 5:15	15.1	15.9	86.2	50
22/09/2024 5:30	15.2	17.7	90.3	50
22/09/2024 5:45	17.1	15.6	85.4	50
22/09/2024 6:00	17.5	16.2	90.4	50
22/09/2024 6:15	16.4	15.1	85.6	50
22/09/2024 6:30	15.6	16.1	80.2	50
22/09/2024 6:45	15.8	15.9	81.7	50
22/09/2024 7:00	19.2	16	84.6	50
22/09/2024 7:15	15.1	16.7	85.9	50
22/09/2024 7:30	21.4	18	88.2	50
22/09/2024 7:45	15.2	18.7	102.2	50
22/09/2024 8:00	15.9	19.8	83.4	50
22/09/2024 8:15	17.2	15.9	80.6	50
22/09/2024 8:30	17.4	16.8	84.3	50
22/09/2024 8:45	16.5	16.2	86.5	50
22/09/2024 9:00	15.4	15.1	87.5	50
22/09/2024 9:15	15.3	18.7	86	50
22/09/2024 9:30	14.9	16.2	82	50
22/09/2024 9:45	16.2	17	97.6	50
22/09/2024 10:00	18.1	17.3	81.4	50
22/09/2024 10:15	16.1	16.1	83.8	50
22/09/2024 10:30	13.8	17.5	86.5	50
22/09/2024 10:45	14.7	15.1	83.3	50
22/09/2024 11:00	13.6	15.5	80	50
22/09/2024 11:15	14.7	17.3	88.6	50
22/09/2024 11:30	15.3	17.3	82.1	50
22/09/2024 11:45	14.3	15.3	87.2	50
22/09/2024 12:00	15.1	17.6	92.3	50
22/09/2024 12:15	16	16.2	83.6	50
22/09/2024 12:30	13.2	15.6	84.3	50
22/09/2024 12:45	15.2	16.4	89.1	50
22/09/2024 13:00	15.2	16.1	86.2	50
22/09/2024 13:15	16.2	16.8	89	50
22/09/2024 13:30	18.8	17	112.8	50
22/09/2024 13:45	14.9	16.8	86.6	50
22/09/2024 14:00	14.7	16.3	83.5	50
22/09/2024 14:15	14.4	18.6	83.6	50
22/09/2024 14:30	14.7	16.5	79.8	50
22/09/2024 14:45	16.1	15.8	85.7	50
22/09/2024 15:00	15.8	15.4	91.5	50
22/09/2024 15:15	15.3	14.5	85.8	50
22/09/2024 15:30	14.5	16.5	91.3	50
22/09/2024 15:45	16.2	15.8	87.4	50
22/09/2024 16:00	15.6	17.4	87.9	50
22/09/2024 16:15	18.9	17.8	83.4	50
22/09/2024 16:30	14.1	16.8	89.7	50
22/09/2024 16:45	17.9	16.3	83.5	50
22/09/2024 17:00	18.2	14.3	89.1	50
22/09/2024 17:15	18.4	15.2	87.8	50
22/09/2024 17:30	15.3	14.7	88.5	50
22/09/2024 17:45	14.9	15.6	86.8	50
22/09/2024 18:00	16.7	15.9	90.2	50
22/09/2024 18:15	15.9	15.6	84.7	50
22/09/2024 18:30	14.7	15.1	89.8	50
22/09/2024 18:45	14.3	14.9	85	50
22/09/2024 19:00	13.7	15.8	82.5	50
22/09/2024 19:15	14.6	15.5	82.5	50
22/09/2024 19:30	15.5	14.3	83.7	50
22/09/2024 19:45	14.9	14.8	83.6	50
22/09/2024 20:00	14.5	14.4	86.5	50
22/09/2024 20:15	15.6	14.5	82	50
22/09/2024 20:30	16.8	15.6	92.7	50
22/09/2024 20:45	15.2	16	84.6	50
22/09/2024 21:00	15	16.3	86.6	50
22/09/2024 21:15	14.5	15.5	82.8	50
22/09/2024 21:30	16.2	14.8	93.2	50
22/09/2024 21:45	16.7	15.7	97.2	50
22/09/2024 22:00	17.2	15.8	92.1	50
22/09/2024 22:15	15.9	15.3	85.3	50
22/09/2024 22:30	14	14.7	100.4	50
22/09/2024 22:45	15.3	16	88.8	50
22/09/2024 23:00	15.2	15.6	83.1	50
22/09/2024 23:15	14.2	15.8	87.3	50
22/09/2024 23:30	20.4	15.1	89.8	50
22/09/2024 23:45	15.4	15.7	88	50
23/09/2024 0:00	15.6	17.9	93.8	50
23/09/2024 0:15	14.6	15.8	80.2	50
23/09/2024 0:30	16.7	17.1	85.2	50
23/09/2024 0:45	15.9	15.3	92.6	50
23/09/2024 1:00	15.9	14.4	86.6	50
23/09/2024 1:15	16.8	15.1	96.7	50
23/09/2024 1:30	14.8	16	89.8	50
23/09/2024 1:45	15.1	16	85.8	50
23/09/2024 2:00	14.2	15.7	89.5	50
23/09/2024 2:15	14.8	15.7	79.6	50
23/09/2024 2:30	16.3	17	90.2	50
23/09/2024 2:45	15.2	15.6	85.9	50
23/09/2024 3:00	14.8	14.5	90.5	50
23/09/2024 3:15	17.1	15	78.3	50
23/09/2024 3:30	17	14.8	82.2	50
23/09/2024 3:45	15.2	15.9	89.7	50
23/09/2024 4:00	16	15.3	90.4	50
23/09/2024 4:15	17.1	15	84	50
23/09/2024 4:30	14.9	15.2	82.8	50
23/09/2024 4:45	15.9	17.2	88.4	50
23/09/2024 5:00	15.6	17.3	85.7	50
23/09/2024 5:15	15.5	15.1	88.1	50
23/09/2024 5:30	18	15.2	94.6	50
23/09/2024 5:45	16.9	15.6	114.2	50
23/09/2024 6:00	15	15.8	92.7	50
23/09/2024 6:15	16.4	17.4	96.5	50
23/09/2024 6:30	16.9	15.4	85.2	50

23/09/2024 6:45	16	16.6	86	50
23/09/2024 7:00	17.7	20.3	89.2	50
23/09/2024 7:15	15.6	21.6	81.6	50
23/09/2024 7:30	18.8	21.5	112.2	50
23/09/2024 7:45	21.7	20.7	88.9	50
23/09/2024 8:00	18	19	95.1	50
23/09/2024 8:15	22.8	20.1	100.5	50
23/09/2024 8:30	22.1	25.3	104.9	50
23/09/2024 8:45	62.2	85.7	52.8	50
23/09/2024 9:00	51.2	44.2	369.2	50
23/09/2024 9:15	61.8	50.2	405.8	50
23/09/2024 9:30	48.5	60.4	485.1	50
23/09/2024 9:45	45.8	40.4	281.2	50
23/09/2024 10:00	20.9	21.2	124.3	50
23/09/2024 10:15	27.7	52.9	243.6	50
23/09/2024 10:30	40.9	63.2	567.4	50
23/09/2024 10:45	57.9	80.5	533.8	50
23/09/2024 11:00	42.1	46.1	284.2	50
23/09/2024 11:15	47.3	23.9	233.5	50
23/09/2024 11:30	34.7	53.7	238.3	50
23/09/2024 11:45	36	45.4	224.7	50
23/09/2024 12:00	37.1	42.5	260	50
23/09/2024 12:15	39	37.5	211.9	50
23/09/2024 12:30	33.6	41.8	230.1	50
23/09/2024 12:45	47.1	45.5	219	50
23/09/2024 13:00	45.6	33	206.1	50
23/09/2024 13:15	44.9	44.3	215.4	50
23/09/2024 13:30	41.7	37	256.3	50
23/09/2024 13:45	62.1	51.2	310.5	50
23/09/2024 14:00	35.5	53	211.3	50
23/09/2024 14:15	56.7	39.9	321	50
23/09/2024 14:30	37.4	32.6	261.8	50
23/09/2024 14:45	52.2	88.7	223.5	50
23/09/2024 15:00	56.7	54.7	266.8	50
23/09/2024 15:15	48.4	71.6	292.2	50
23/09/2024 15:30	67.6	56.5	369.5	50
23/09/2024 15:45	32.1	33.5	309.2	50
23/09/2024 16:00	16.4	22.6	113.7	50
23/09/2024 16:15	14.3	15.6	116.2	50
23/09/2024 16:30	21.6	19.1	133.3	50
23/09/2024 16:45	24.2	20	184.5	50
23/09/2024 17:00	25.1	39	117.3	50
23/09/2024 17:15	13.9	16	84.4	50
23/09/2024 17:30	15.5	15.4	90.5	50
23/09/2024 17:45	14.1	15.8	81.9	50
23/09/2024 18:00	14.8	15.2	84.8	50
23/09/2024 18:15	15	15.4	88.5	50
23/09/2024 18:30	16.5	16.6	88.6	50
23/09/2024 18:45	21.8	16.4	140.6	50
23/09/2024 19:00	16.2	18.9	80.9	50
23/09/2024 19:15	14.7	15.4	84.1	50
23/09/2024 19:30	14.3	16.8	85.7	50
23/09/2024 19:45	14.8	15.9	84.2	50
23/09/2024 20:00	15.8	15.1	89.4	50
23/09/2024 20:15	14.2	15.7	99.2	50
23/09/2024 20:30	16.5	16.8	80.8	50
23/09/2024 20:45	32.7	22.2	90	50
23/09/2024 21:00	13.7	15.1	90	50
23/09/2024 21:15	15.7	14.4	84.1	50
23/09/2024 21:30	14.1	15.2	86.7	50
23/09/2024 21:45	13.9	15.7	89.1	50
23/09/2024 22:00	15.3	15.5	82.3	50
23/09/2024 22:15	14.8	16.1	92	50
23/09/2024 22:30	13.4	15.4	78.9	50
23/09/2024 22:45	15.1	16.2	88	50
23/09/2024 23:00	14.8	15.2	88.9	50
23/09/2024 23:15	15.3	15.6	82.8	50
23/09/2024 23:30	15.1	15.9	89.4	50
23/09/2024 23:45	16.7	16.6	86.7	50
24/09/2024 0:00	14.9	15.6	78.6	50
24/09/2024 0:15	14.9	15.7	82.9	50
24/09/2024 0:30	14.6	16.2	84.2	50
24/09/2024 0:45	14.9	17	87.6	50
24/09/2024 1:00	15.8	16.2	82.8	50
24/09/2024 1:15	14.3	16	88.9	50
24/09/2024 1:30	18.2	15.6	86.9	50
24/09/2024 1:45	17.5	16.1	80.6	50
24/09/2024 2:00	16.6	14.9	81.7	50
24/09/2024 2:15	15	16.2	81.5	50
24/09/2024 2:30	15.7	17.5	81.1	50
24/09/2024 2:45	32.3	22.2	123.1	50
24/09/2024 3:00	35.7	34	130.7	50
24/09/2024 3:15	15.2	15	89	50
24/09/2024 3:30	14.9	15.4	84.2	50
24/09/2024 3:45	14.5	15.4	97.2	50
24/09/2024 4:00	16.1	15.4	83.4	50
24/09/2024 4:15	16	18.2	93.3	50
24/09/2024 4:30	15.2	16.1	84.3	50
24/09/2024 4:45	15.4	16.1	103.9	50
24/09/2024 5:00	15.2	17.7	84.1	50
24/09/2024 5:15	14.3	16.6	85.9	50
24/09/2024 5:30	15.2	17.8	84.6	50
24/09/2024 5:45	16.2	15.8	84.6	50
24/09/2024 6:00	18.5	17.8	104.1	50
24/09/2024 6:15	68.4	132.7	820.9	50
24/09/2024 6:30	38.4	47.5	308.5	50
24/09/2024 6:45	19.8	44.4	101.1	50
24/09/2024 7:00	22.6	22.4	184	50
24/09/2024 7:15	50.9	56	352.7	50
24/09/2024 7:30	81.1	64.4	560.3	50
24/09/2024 7:45	53.5	47.9	365.6	50
24/09/2024 8:00	66.3	58.5	453.6	50
24/09/2024 8:15	94.3	68.8	587.8	50
24/09/2024 8:30	44.2	52	272.2	50
24/09/2024 8:45	84.9	60	389.5	50
24/09/2024 9:00	75.1	69.4	467.3	50
24/09/2024 9:15	67.5	57.6	501.3	50
24/09/2024 9:30	65.3	60.9	453.5	50
24/09/2024 9:45	90.6	93.6	490.8	50
24/09/2024 10:00	86.1	71.3	647.4	50
24/09/2024 10:15	75.9	63	565.1	50
24/09/2024 10:30	89.5	79.2	689.3	50
24/09/2024 10:45	88.9	90.4	801.8	50
24/09/2024 11:00	68.8	61.2	520.8	50
24/09/2024 11:15	21.3	18.9	166.1	50
24/09/2024 11:30	25.4	20.1	166.1	50
24/09/2024 11:45	24.4	27	150.9	50
24/09/2024 12:00	19.3	20.5	175.1	50
24/09/2024 12:15	18.4	17.7	161.7	50
24/09/2024 12:30	23	31.7	200.1	50
24/09/2024 12:45	31.9	36.1	239.3	50
24/09/2024 13:00	28.4	31.9	208.1	50
24/09/2024 13:15	19.4	36.2	97.3	50
24/09/2024 13:30	16.7	16.9	84.1	50
24/09/2024 13:45	15	15.2	95.6	50
24/09/2024 14:00	16.7	14.2	119.2	50
24/09/2024 14:15	15.2	14.3	90.1	50
24/09/2024 14:30	15.6	15.6	96	50
24/09/2024 14:45	15.3	15.2	80.4	50
24/09/2024 15:00	15.9	17.1	77.8	50
24/09/2024 15:15	14.9	16.1	82.7	50
24/09/2024 15:30	14	15.6	67.2	50
24/09/2024 15:45	15.4	13.9	77.3	50
24/09/2024 16:00	17.6	15.4	72.1	50
24/09/2024 16:15	15.8	14.1	71.5	50
24/09/2024 16:30	14.2	14.6	79.5	50
24/09/2024 16:45	17.6	14.7	77.2	50
24/09/2024 17:00	13.6	13.5	74.5	50
24/09/2024 17:15	14	14.4	77.3	50
24/09/2024 17:30	19.3	23.3	120.6	50
24/09/2024 17:45	14.1	15.6	74.6	50
24/09/2024 18:00	20.3	17.4	72.4	50

24/09/2024 21:45	18.1	13.8	86.7	50
24/09/2024 22:00	16.5	14.8	75.5	50
24/09/2024 22:15	15.8	14.7	74.3	50
24/09/2024 22:30	15.1	14.6	76.6	50
24/09/2024 22:45	17.7	15	74	50
24/09/2024 23:00	13.2	14.7	77.4	50
24/09/2024 23:15	17.6	15.4	75.1	50
24/09/2024 23:30	14.7	15.6	81.5	50
24/09/2024 23:45	14.1	16	71.4	50
25/09/2024 0:00	13.3	15.5	81.1	50
25/09/2024 0:15	14.5	14.3	71.2	50
25/09/2024 0:30	16	15.7	108.6	50
25/09/2024 0:45	11.1	13.8	75.4	50
25/09/2024 1:00	13.8	14.7	74.9	50
25/09/2024 1:15	12.5	14.2	85.8	50
25/09/2024 1:30	15.3	14.1	95.4	50
25/09/2024 1:45	15.6	15.4	74.6	50
25/09/2024 2:00	13.2	14.2	72.9	50
25/09/2024 2:15	14.1	14.9	88.3	50
25/09/2024 2:30	14.4	13.7	78.2	50
25/09/2024 2:45	22.4	26.3	85.5	50
25/09/2024 3:00	77.5	105.7	446.6	50
25/09/2024 3:15	18.8	16.1	85.7	50
25/09/2024 3:30	13.8	15.2	75.8	50
25/09/2024 3:45	13.9	15.2	77.6	50
25/09/2024 4:00	14.4	14.8	77.6	50
25/09/2024 4:15	13.6	13.9	71.4	50
25/09/2024 4:30	15.8	14.9	80.4	50
25/09/2024 4:45	18.9	14.8	77.5	50
25/09/2024 5:00	13.8	16.3	78	50
25/09/2024 5:15	12.3	14.3	74	50
25/09/2024 5:30	15.3	15	82.7	50
25/09/2024 5:45	19.9	16	79.8	50
25/09/2024 6:00	15.2	15.8	81.9	50
25/09/2024 6:15	17.2	15.1	141	50
25/09/2024 6:30	16.4	16.9	74.1	50
25/09/2024 6:45	15.7	15.8	82.8	50
25/09/2024 7:00	17.7	20.6	92.7	50
25/09/2024 7:15	24.6	21	90.4	50
25/09/2024 7:30	31.7	21	95.9	50
25/09/2024 7:45	31.4	25.1	110	50
25/09/2024 8:00	97	100.2	315	50
25/09/2024 8:15	72.9	89.9	278.8	50
25/09/2024 8:30	84.8	89.8	308.2	50
25/09/2024 8:45	49.3	61.7	327.3	50
25/09/2024 9:00	62.9	69.8	646.4	50
25/09/2024 9:15	101.1	68.1	780	50
25/09/2024 9:30	94.8	72.3	598.6	50
25/09/2024 9:45	57.9	74.6	403.3	50
25/09/2024 10:00	63.3	77	476.8	50
25/09/2024 10:15	58.7	73.9	388.7	50
25/09/2024 10:30	73.3	98.4	486.2	50
25/09/2024 10:45	67.6	93.5	356	50
25/09/2024 11:00	37.2	48.5	284.1	50
25/09/2024 11:15	51.2	54.1	290.6	50
25/09/2024 11:30	56	70.3	313.3	50
25/09/2024 11:45	41.6	29.6	281.9	50
25/09/2024 12:00	37.1	27.1	104.3	50
25/09/2024 12:15	32.5	27.8	188.6	50
25/09/2024 12:30	50.2	49.1	337.2	50
25/09/2024 12:45	63.5	56.1	351.6	50
25/09/2024 13:00	115.2	128.3	800.4	50
25/09/2024 13:15	86.1	90.6	504.8	50
25/09/2024 13:30	112.3	60.9	591	50
25/09/2024 13:45	89.1	63.8	680.3	50
25/09/2024 14:00	49.8	79.8	344	50
25/09/2024 14:15	92.7	101.6	578.7	50
25/09/2024 14:30	74.6	81.4	500	50
25/09/2024 14:45	73.4	84.9	520.7	50
25/09/2024 15:00	54.1	63.4	376.5	50
25/09/2024 15:15	97.3	69.7	568	50
25/09/2024 15:30	31.7	29.4	202.5	50
25/09/2024 15:45	46.9	35.4	234.6	50
25/09/2024 16:00	41	38.6	167	50
25/09/2024 16:15	19.6	24.7	85.9	50
25/09/2024 16:30	18.3	15.6	89.4	50
25/09/2024 16:45	17	16.1	85.1	50
25/09/2024 17:00	16.7	14.7	118.5	50
25/09/2024 17:15	39	21.3	204.2	50
25/09/2024 17:30	17.9	16.7	116.4	50
25/09/2024 17:45	26.9	14.9	78.5	50
25/09/2024 18:00	16.8	15.3	76.6	50
25/09/2024 18:15	18.1	15.3	84.9	50
25/09/2024 18:30	15.9	15.6	85.9	50
25/09/2024 18:45	14.9	14.9	78.9	50
25/09/2024 19:00	15.5	15.9	78.3	50
25/09/2024 19:15	14.5	14.7	74.9	50
25/09/2024 19:30	12.9	16.4	86.2	50
25/09/2024 19:45	15.8	14	68.6	50
25/09/2024 20:00	16.2	14.4	75.6	50
25/09/2024 20:15	14.2	15.2	76.8	50
25/09/2024 20:30	14	15.2	81.2	50
25/09/2024 20:45	13	14.8	78.1	50
25/09/2024 21:00	17.3	14.3	71.2	50
25/09/2024 21:15	17.4	13.5	71.1	50
25/09/2024 21:30	13.4	15.6	73.6	50
25/09/2024 21:45	14	13.7	83.7	50
25/09/2024 22:00	14.5	15	84.4	50
25/09/2024 22:15	14.5	15.1	80.7	50
25/09/2024 22:30	16.2	14.9	75.2	50
25/09/2024 22:45	14.2	13.7	72.1	50
25/09/2024 23:00	15.1	14.8	79.7	50
25/09/2024 23:15	16.1	15.2	77.4	50
25/09/2024 23:30	14.3	14.8	80.4	50
25/09/2024 23:45	13.6	14.3	80.8	50
26/09/2024 0:00	15	13.6	74.8	50
26/09/2024 0:15	14.6	14	68.1	50
26/09/2024 0:30	15.4	15.7	77.1	50
26/09/2024 0:45	17.4	15.7	80.7	50
26/09/2024 1:00	14.7	14.3	73.1	50
26/09/2024 1:15	15.4	14.6	79.1	50
26/09/2024 1:30	13.5	13.6	74.3	50
26/09/2024 1:45	13.5	13.8	77.8	50
26/09/2024 2:00	17	16.4	73.5	50
26/09/2024 2:15	14.6	14.4	74.5	50
26/09/2024 2:30	15.4	14.6	81.3	50
26/09/2024 2:45	16.4	15.9	79	50
26/09/2024 3:00	15.6	17.1	79.4	50
26/09/2024 3:15	14.2	15.8	72.9	50
26/09/2024 3:30	14.1	14.8	92.1	50
26/09/2024 3:45	14.3	15.3	77.4	50
26/09/2024 4:00	15.5	16.4	73	50
26/09/2024 4:15	17.2	14.9	81	50
26/09/2024 4:30	17.9	17.9	75.9	50
26/09/2024 4:45	16.4	14.6	72.5	50
26/09/2024 5:00	14.6	15.5	75	50
26/09/2024 5:15	16.6	15.2	74.6	50
26/09/2024 5:30	15	14.7	69.2	50
26/09/2024 5:45	16.9	16.7	100.1	50
26/09/2024 6:00	15.8	15.5	71.2	50
26/09/2024 6:15	17.4	16.6	79.9	50
26/09/2024 6:30	15.7	15.8	76.4	50
26/09/2024 6:45	15.5	16.1	78.7	50
26/09/2024 7:00	16.6	22	74.8	50
26/09/2024 7:15	18.9	15.5	111.5	50
26/09/2024 7:30	30.8	35.8	152.7	50
26/09/2024 7:45	51.1	46.7	353.7	50
26/09/2024 8:00	56.2	61.1	359	50
26/09/2024 8:15	63.7	60.6	372.2	50
26/09/2024 8:30	47.3	52.8	288.9	50
26/09/2024 8:45	41.3	38.4	242	50
26/09/2024 9:00	35.3	43.3	247.3	50

26/09/2024 9:15	54	49.2	301.7	50
26/09/2024 9:30	52.1	53.7	303.3	50
26/09/2024 9:45	22.6	25.4	258.3	50
26/09/2024 10:00	43.2	59.2	280.2	50
26/09/2024 10:15	49	43.9	267.3	50
26/09/2024 10:30	55.3	45.6	331.2	50
26/09/2024 10:45	82	88.2	503.4	50
26/09/2024 11:00	64.8	50.1	341	50
26/09/2024 11:15	61.5	54.6	328.1	50
26/09/2024 11:30	62.1	51.2	268.9	50
26/09/2024 11:45	34.4	40.8	210.1	50
26/09/2024 12:00	66.6	69.7	386.9	50
26/09/2024 12:15	31.2	26.3	229.2	50
26/09/2024 12:30	54.7	56.9	256.7	50
26/09/2024 12:45	29.2	28.4	165.8	50
26/09/2024 13:00	76.5	79.2	349.5	50
26/09/2024 13:15	50.4	52.3	293.2	50
26/09/2024 13:30	61.7	62	311.6	50
26/09/2024 13:45	54.3	75.7	323.5	50
26/09/2024 14:00	50	66	308	50
26/09/2024 14:15	52.6	70.9	289.7	50
26/09/2024 14:30	46.5	57.2	289	50
26/09/2024 14:45	46.5	54	393.8	50
26/09/2024 15:00	19.9	29.6	243.5	50
26/09/2024 15:15	19.6	18.6	122.3	50
26/09/2024 15:30	18.9	19.4	132.7	50
26/09/2024 15:45	20.9	28.4	153.1	50
26/09/2024 16:00	15.2	17.4	86.3	50
26/09/2024 16:15	18.6	24.8	111.2	50
26/09/2024 16:30	26.9	40.1	255.5	50
26/09/2024 16:45	20	28.1	198.5	50
26/09/2024 17:00	20.4	15.6	118.1	50
26/09/2024 17:15	19.6	18.7	85.8	50
26/09/2024 17:30	15.9	17.9	154.6	50
26/09/2024 17:45	26.6	46.8	319.2	50
26/09/2024 18:00	14.9	14.4	89.8	50
26/09/2024 18:15	19.5	15.2	77.3	50
26/09/2024 18:30	17.7	15.5	76.1	50
26/09/2024 18:45	17.9	14.8	75.5	50
26/09/2024 19:00	17	16	110.5	50
26/09/2024 19:15	15.2	17.4	71.8	50
26/09/2024 19:30	15	14.3	70.1	50
26/09/2024 19:45	18.3	18.9	99.7	50
26/09/2024 20:00	13.8	14.9	75.2	50
26/09/2024 20:15	16.1	15.1	72.2	50
26/09/2024 20:30	13.6	15	70.9	50
26/09/2024 20:45	14.4	14.3	80.2	50
26/09/2024 21:00	14.2	13.4	71.5	50
26/09/2024 21:15	13.8	14.3	71.5	50
26/09/2024 21:30	14.5	14.2	78.6	50
26/09/2024 21:45	13.6	15.4	76.1	50
26/09/2024 22:00	13.3	14.8	78.6	50
26/09/2024 22:15	14.8	15.7	70.4	50
26/09/2024 22:30	14.3	15.4	77.6	50
26/09/2024 22:45	16.5	15.7	86.8	50
26/09/2024 23:00	15.6	14.8	74.9	50
26/09/2024 23:15	13.7	14.9	69.5	50
26/09/2024 23:30	17	16.1	75.3	50
26/09/2024 23:45	15.4	15.4	71.2	50
27/09/2024 0:00	14.6	15.3	81.5	50
27/09/2024 0:15	13.7	14.8	83.7	50
27/09/2024 0:30	13.9	15.7	78.1	50
27/09/2024 0:45	13.4	15.3	74.3	50
27/09/2024 1:00	15.4	17.6	76	50
27/09/2024 1:15	14.3	15.9	74.4	50
27/09/2024 1:30	14.7	14.6	74.6	50
27/09/2024 1:45	14.8	15.3	72.7	50
27/09/2024 2:00	15.6	14.3	70.4	50
27/09/2024 2:15	15	15.3	70.1	50
27/09/2024 2:30	15.2	16.9	73.7	50
27/09/2024 2:45	14.4	16	84	50
27/09/2024 3:00	13	15.9	79.2	50
27/09/2024 3:15	15.2	17.5	84.7	50
27/09/2024 3:30	14.9	14.6	71.7	50
27/09/2024 3:45	13.9	14.6	80.3	50
27/09/2024 4:00	15.2	16.2	72.1	50
27/09/2024 4:15	13.4	15.2	77.1	50
27/09/2024 4:30	15.5	13.6	77.1	50
27/09/2024 4:45	13.2	15.1	70.9	50
27/09/2024 5:00	13.8	15.7	74.1	50
27/09/2024 5:15	13.9	14.4	69.2	50
27/09/2024 5:30	13.6	14.8	75.7	50
27/09/2024 5:45	16	15.3	78.3	50
27/09/2024 6:00	15	17.4	80.7	50
27/09/2024 6:15	15.7	15.8	77.4	50
27/09/2024 6:30	22.3	16.5	106	50
27/09/2024 6:45	53.3	59	315.3	50
27/09/2024 7:00	57.3	66.2	304.6	50
27/09/2024 7:15	41.6	25.9	145.3	50
27/09/2024 7:30	41	47.1	180.8	50
27/09/2024 7:45	29.9	38.7	164	50
27/09/2024 8:00	38.1	42.3	178.8	50
27/09/2024 8:15	26.5	24.7	184	50
27/09/2024 8:30	26.3	24.8	178.7	50
27/09/2024 8:45	45.8	50.8	236.7	50
27/09/2024 9:00	54.5	42.2	214.7	50
27/09/2024 9:15	78.9	68.6	560.3	50
27/09/2024 9:30	34.3	32.9	186.2	50
27/09/2024 9:45	34.8	25.3	121.4	50
27/09/2024 10:00	35.6	47	165.8	50
27/09/2024 10:15	45.1	26.9	88.1	50
27/09/2024 10:30	22.6	26.7	141.3	50
27/09/2024 10:45	61.2	59.3	376.5	50
27/09/2024 11:00	24.2	23.8	134.6	50
27/09/2024 11:15	62.7	57.5	455.3	50
27/09/2024 11:30	60.8	61.4	386.6	50
27/09/2024 11:45	35.3	34.7	151.3	50
27/09/2024 12:00	39.8	37.8	211	50
27/09/2024 12:15	35.7	27.9	207.8	50
27/09/2024 12:30	77	69.3	392.7	50
27/09/2024 12:45	68.8	52.5	232.9	50
27/09/2024 13:00	24.5	25.9	110.4	50
27/09/2024 13:15	77.1	60.6	363.8	50
27/09/2024 13:30	38.8	28.5	137.2	50
27/09/2024 13:45	22.1	22.9	142.6	50
27/09/2024 14:00	68.2	108	626.8	50
27/09/2024 14:15	27.6	28.4	203	50
27/09/2024 14:30	15.9	18.6	110.4	50
27/09/2024 14:45	21.2	31.9	157.5	50
27/09/2024 15:00	20.2	25.8	127.8	50
27/09/2024 15:15	53	44.7	400.3	50
27/09/2024 15:30	23.1	17.4	218.1	50
27/09/2024 15:45	55.8	32.3	228	50
27/09/2024 16:00	27.2	45.1	103.6	50
27/09/2024 16:15	27.8	43.1	168.4	50
27/09/2024 16:30	28.6	29.7	159.7	50
27/09/2024 16:45	19.7	18.7	163.8	50
27/09/2024 17:00	12.9	14.8	74.8	50
27/09/2024 17:15	18.6	14.7	112	50
27/09/2024 17:30	13.6	15.1	109.1	50
27/09/2024 17:45	13.7	14.4	75.1	50
27/09/2024 18:00	15.7	16.1	111.6	50
27/09/2024 18:15	14.7	15.5	79.7	50
27/09/2024 18:30	15.2	14.8	83.1	50
27/09/2024 18:45	13.4	14.6	83.2	50
27/09/2024 19:00	16.2	15.5	80.4	50
27/09/2024 19:15	15.3	15.4	78.8	50
27/09/2024 19:30	13.6	14.4	77.5	50
27/09/2024 19:45	13	15.5	75.7	50
27/09/2024 20:00	16.4	16.2	78.4	50
27/09/2024 20:15	13.6	15.3	73.6	50
27/09/2024 20:30	13	15.8	78.5	50

27/09/2024 20:45	14.5	14.3	74.1	50
27/09/2024 21:00	14.2	15.1	74.8	50
27/09/2024 21:15	12.4	15	76	50
27/09/2024 21:30	13.5	14.6	77.6	50
27/09/2024 21:45	15.1	16.1	80.7	50
27/09/2024 22:00	14	13.9	70.7	50
27/09/2024 22:15	14	15.3	88.6	50
27/09/2024 22:30	14.5	14.1	71.6	50
27/09/2024 22:45	15.1	15.1	76.7	50
27/09/2024 23:00	14.2	14.8	80.3	50
27/09/2024 23:15	12.6	14.8	79.2	50
27/09/2024 23:30	13.4	15.2	83.5	50
27/09/2024 23:45	12.7	14.4	76.7	50
28/09/2024 0:00	13.7	15.9	80.6	50
28/09/2024 0:15	13.5	13.2	74.4	50
28/09/2024 0:30	15.4	17	80.8	50
28/09/2024 0:45	13.8	15.6	72.7	50
28/09/2024 1:00	14.4	15.1	77.7	50
28/09/2024 1:15	14.5	16.6	75.4	50
28/09/2024 1:30	14.6	14.7	83.9	50
28/09/2024 1:45	16.2	14.9	82.1	50
28/09/2024 2:00	14	14.2	77.6	50
28/09/2024 2:15	14.3	16.1	76.6	50
28/09/2024 2:30	13.1	15.1	78.1	50
28/09/2024 2:45	14.2	38.2	81.5	50
28/09/2024 3:00	13.1	15.9	74.8	50
28/09/2024 3:15	13.3	15.4	84.2	50
28/09/2024 3:30	13.6	14.3	72.2	50
28/09/2024 3:45	14.3	15.5	76.2	50
28/09/2024 4:00	16.5	15.5	75.6	50
28/09/2024 4:15	13.2	14.2	72.8	50
28/09/2024 4:30	12.9	14.9	78.7	50
28/09/2024 4:45	13.5	14.2	77.6	50
28/09/2024 5:00	15	14	75.9	50
28/09/2024 5:15	14.5	14.6	76.3	50
28/09/2024 5:30	13.2	16.2	88	50
28/09/2024 5:45	15.8	15.1	79.3	50
28/09/2024 6:00	15.6	16.8	96.2	50
28/09/2024 6:15	14.5	16.4	83.5	50
28/09/2024 6:30	14.5	15.3	106.8	50
28/09/2024 6:45	14	16.9	80	50
28/09/2024 7:00	60.8	86.4	217.3	50
28/09/2024 7:15	54	70.2	194.1	50
28/09/2024 7:30	38	65.6	172.1	50
28/09/2024 7:45	38	37.1	146.5	50
28/09/2024 8:00	45.8	46.5	154.3	50
28/09/2024 8:15	39.2	41.4	112	50
28/09/2024 8:30	38.7	33.1	118.5	50
28/09/2024 8:45	43.4	40.4	148.7	50
28/09/2024 9:00	37.5	45.6	143.5	50
28/09/2024 9:15	38.3	55.3	174.8	50
28/09/2024 9:30	33.5	40.8	164.2	50
28/09/2024 9:45	17.9	17.2	80.4	50
28/09/2024 10:00	54.2	47.5	159.2	50
28/09/2024 10:15	55.1	54	170.4	50
28/09/2024 10:30	13.5	16.5	72.4	50
28/09/2024 10:45	19.8	20	78	50
28/09/2024 11:00	34.9	34.7	90.7	50
28/09/2024 11:15	34.4	33.7	128.5	50
28/09/2024 11:30	54.5	55.1	178.6	50
28/09/2024 11:45	47.8	54.9	160.5	50
28/09/2024 12:00	58.7	48.6	199.8	50
28/09/2024 12:15	56.7	37	152.3	50
28/09/2024 12:30	44.5	48.5	154.3	50
28/09/2024 12:45	61.5	54.5	174.1	50
28/09/2024 13:00	51.5	44.9	149.3	50
28/09/2024 13:15	22.6	19.2	87.1	50
28/09/2024 13:30	13.9	19.5	72.2	50
28/09/2024 13:45	15.7	15.3	78.7	50
28/09/2024 14:00	14.5	15.3	77.8	50
28/09/2024 14:15	15.2	18.5	80	50
28/09/2024 14:30	13.9	14.9	77.9	50
28/09/2024 14:45	14.1	15.2	80.9	50
28/09/2024 15:00	16.3	15	121.7	50
28/09/2024 15:15	17.5	20.4	82.5	50
28/09/2024 15:30	13.7	16.2	77.8	50
28/09/2024 15:45	15.1	14.3	78.3	50
28/09/2024 16:00	13.1	14.3	79.3	50
28/09/2024 16:15	14.9	15.2	76.6	50
28/09/2024 16:30	14.4	14.7	79.2	50
28/09/2024 16:45	14	15.6	76.8	50
28/09/2024 17:00	13	14.9	79.4	50
28/09/2024 17:15	13.7	14.6	74.1	50
28/09/2024 17:30	13.2	13.5	74.4	50
28/09/2024 17:45	13	15.3	76.2	50
28/09/2024 18:00	13.9	15.2	78.9	50
28/09/2024 18:15	13.2	14.6	74.1	50
28/09/2024 18:30	13.6	13.3	80.3	50
28/09/2024 18:45	13.1	13.1	84.5	50
28/09/2024 19:00	13.8	13.4	78	50
28/09/2024 19:15	12.4	14.2	75.6	50
28/09/2024 19:30	14.2	14.9	76.1	50
28/09/2024 19:45	13	11.5	78.2	50
28/09/2024 20:00	12.7	14	77.4	50
28/09/2024 20:15	14.3	14	74.7	50
28/09/2024 20:30	12.7	13.6	73.2	50
28/09/2024 20:45	12.6	14.3	72.8	50
28/09/2024 21:00	13.8	13.9	84.9	50
28/09/2024 21:15	11.8	13.3	87.4	50
28/09/2024 21:30	13.9	14.4	73.1	50
28/09/2024 21:45	14.1	16	79.7	50
28/09/2024 22:00	14.3	14.2	78	50
28/09/2024 22:15	14	13.5	76.7	50
28/09/2024 22:30	14.4	14.3	80.9	50
28/09/2024 22:45	13.5	13.4	75	50
28/09/2024 23:00	12.4	15.9	73.7	50
28/09/2024 23:15	12.7	13.7	76.5	50
28/09/2024 23:30	13	12.8	74.4	50
28/09/2024 23:45	14.2	13.9	71.9	50
29/09/2024 0:00	12.2	14.1	70.5	50
29/09/2024 0:15	13.3	15	71.1	50
29/09/2024 0:30	14	14.8	83.4	50
29/09/2024 0:45	13.6	15	75.9	50
29/09/2024 1:00	14	13.8	71.7	50
29/09/2024 1:15	35	38	105.6	50
29/09/2024 1:30	12.3	13.2	79	50
29/09/2024 1:45	13.8	15.1	79.8	50
29/09/2024 2:00	12.1	14.9	72.7	50
29/09/2024 2:15	13.2	14	76	50
29/09/2024 2:30	13.1	13.6	78.6	50
29/09/2024 2:45	12.8	14.8	75.1	50
29/09/2024 3:00	13.8	13.8	73.5	50
29/09/2024 3:15	13.4	14.4	71.1	50
29/09/2024 3:30	13.9	14.9	74.3	50
29/09/2024 3:45	14.3	13.5	74.2	50
29/09/2024 4:00	13.8	14.6	74.4	50
29/09/2024 4:15	14.3	13.9	86.6	50
29/09/2024 4:30	13.8	14.3	76.8	50
29/09/2024 4:45	15	13.8	79.2	50
29/09/2024 5:00	15.4	15	75.9	50
29/09/2024 5:15	13	13.9	76	50
29/09/2024 5:30	13.3	13.3	79.2	50
29/09/2024 5:45	14.3	13.6	70.6	50
29/09/2024 6:00	14.7	14.7	77	50
29/09/2024 6:15	15.3	14.2	79	50
29/09/2024 6:30	13.8	14.5	78.3	50
29/09/2024 6:45	14.7	13.8	78.3	50
29/09/2024 7:00	14.6	15.1	80.9	50
29/09/2024 7:15	16	15.2	89	50
29/09/2024 7:30	13.4	15	82.8	50
29/09/2024 7:45	13.9	15	78.9	50
29/09/2024 8:00	13.7	15.9	80.1	50

29/09/2024 8:15	13.2	14.8	71.5	50
29/09/2024 8:30	14.5	16.6	75.3	50
29/09/2024 8:45	14.4	17.7	73.6	50
29/09/2024 9:00	14.5	14.4	82.1	50
29/09/2024 9:15	13.8	15.5	75.5	50
29/09/2024 9:30	14.6	13.9	78.2	50
29/09/2024 9:45	20.6	22.5	78.2	50
29/09/2024 10:00	15.1	14.3	90.1	50
29/09/2024 10:15	13.4	13.7	81	50
29/09/2024 10:30	14.5	14	76.6	50
29/09/2024 10:45	16.6	14.6	85.6	50
29/09/2024 11:00	12.9	16.2	73.5	50
29/09/2024 11:15	14	14.7	75.6	50
29/09/2024 11:30	13	14	92.6	50
29/09/2024 11:45	13.9	15.9	84	50
29/09/2024 12:00	15.4	15.4	78.3	50
29/09/2024 12:15	16	13.6	73.3	50
29/09/2024 12:30	17.6	16.2	74.1	50
29/09/2024 12:45	13.6	14.6	75.6	50
29/09/2024 13:00	13.2	15.3	69.8	50
29/09/2024 13:15	14.6	17.2	72.4	50
29/09/2024 13:30	14.2	15.2	72.3	50
29/09/2024 13:45	14.4	15.3	107.3	50
29/09/2024 14:00	16.8	15.7	75.5	50
29/09/2024 14:15	15.5	14.6	71.8	50
29/09/2024 14:30	16	13.9	81.3	50
29/09/2024 14:45	14	13.8	75.1	50
29/09/2024 15:00	13.5	14.2	80	50
29/09/2024 15:15	13.3	14.9	80.2	50
29/09/2024 15:30	13	14.5	82.8	50
29/09/2024 15:45	13.1	15.7	78.2	50
29/09/2024 16:00	14.2	15.9	74.4	50
29/09/2024 16:15	13.5	15.7	81.8	50
29/09/2024 16:30	13.6	15.3	73.5	50
29/09/2024 16:45	12.7	13.6	80.3	50
29/09/2024 17:00	14.4	13.6	79.5	50
29/09/2024 17:15	13.7	15.1	78.7	50
29/09/2024 17:30	16.2	15.3	78.2	50
29/09/2024 17:45	16.8	14.9	75.8	50
29/09/2024 18:00	13.2	14.4	74.8	50
29/09/2024 18:15	14.7	14.1	79.3	50
29/09/2024 18:30	14.7	13.4	86.1	50
29/09/2024 18:45	15.8	13.3	86.4	50
29/09/2024 19:00	14.2	13.6	71.3	50
29/09/2024 19:15	12.7	14.1	74.8	50
29/09/2024 19:30	15.5	13.2	67.9	50
29/09/2024 19:45	13.8	13.2	77.2	50
29/09/2024 20:00	13.4	14.1	70.8	50
29/09/2024 20:15	14	15.1	73.6	50
29/09/2024 20:30	14.1	13.7	70.9	50
29/09/2024 20:45	12.9	14.4	73.5	50
29/09/2024 21:00	15.3	15.8	74.8	50
29/09/2024 21:15	13.8	15.4	71.2	50
29/09/2024 21:30	15	14.1	75.4	50
29/09/2024 21:45	13.2	14.3	71.9	50
29/09/2024 22:00	13.8	14.3	74.1	50
29/09/2024 22:15	15.3	15.3	76.2	50
29/09/2024 22:30	15.5	13.9	72.4	50
29/09/2024 22:45	13.3	14.6	81.1	50
29/09/2024 23:00	13.6	13.5	75.4	50
29/09/2024 23:15	13.8	14.1	75.8	50
29/09/2024 23:30	12.8	13.2	69.8	50
29/09/2024 23:45	14	13.5	82.9	50