

## Fact Sheet

# Canterbury Hospital Redevelopment

October 2024

# Project overview

The NSW Government is investing \$350 million in the Canterbury Hospital Redevelopment to expand the facilities and deliver upgrades to existing infrastructure.

The Canterbury Hospital Redevelopment will be the biggest upgrade to the hospital in 26 years, providing patients and staff with access to the latest facilities.

## Project update

- A Clinical Services Plan (CSP) has been developed to inform the project and reflects the current and future health needs of the community.
- The CSP uses data projections, such as population growth and age profiles, to assess the health needs of the changing community. This will include information around:
  - the unique health needs and challenges in the area
  - what services can best meet these needs
  - future infrastructure requirements
  - models of care.
- The team is working to determine what scope of services are possible within the project budget.
- Hospital redevelopment projects require extensive planning before commencing construction.
- The final scope and construction programme will be confirmed as part of the planning process.



WE ARE HERE

## MASTER PLAN

Overarching plan to guide the project outcomes.

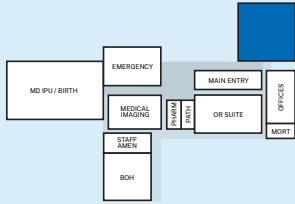

PLANNING

## CONCEPT DESIGN

Relationship between the hospital and other facilities, such as access and transport.

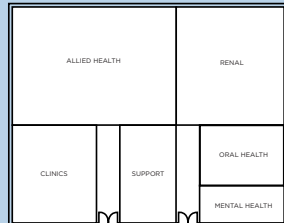

## SCHEMATIC DESIGN

Focuses on departments and how things will connect.

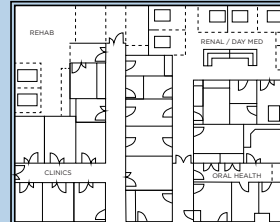

## DETAILED DESIGN

Layout for each room and confirms the project scope.

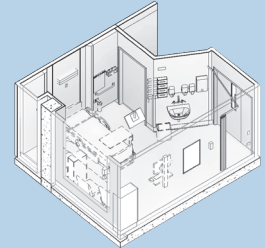

DESIGN

Example of project planning and design process

## Who will deliver the redevelopment?

- The project will be delivered by Health Infrastructure, in partnership with Sydney Local Health District.
- The Lead Design Team was appointed in March 2024 including:
  - **Project Manager:** Johnstaff Projects
  - **Architect:** Silver Thomas Hanley (STH)
  - **Cost Manager:** Slattery Australia
- The Lead Design Team will work with Health Infrastructure, Sydney Local Health District and Canterbury Hospital to determine the key clinical service priorities and progress the planning for the redevelopment.



## How can you be involved?

Residents, staff and key stakeholders across Canterbury and surrounding suburbs are being consulted as part of the planning process to ensure the hospital meets the needs of the diverse communities in the area.

Consultation will occur through community and hospital pop-up sessions, presentations, in-language information and sessions, consumer groups, project user groups, surveys and more.

To be involved in the Canterbury Hospital Redevelopment and follow the redevelopment journey, sign up for our project updates via the QR code below, [project website](#) or [greenarrow.health.nsw.gov.au/ga/front/forms/160/subscriptions/new/](https://greenarrow.health.nsw.gov.au/ga/front/forms/160/subscriptions/new/)



[Sign up for project updates](#)



For an interpreter, call **131 450** and ask them to call **02 9978 5959**

## For more information

T: 02 9978 5959

E: [CanterburyHospitalRedev@health.nsw.gov.au](mailto:CanterburyHospitalRedev@health.nsw.gov.au)

W: [hinfra.health.nsw.gov.au/canterburyhospitalredev](https://hinfra.health.nsw.gov.au/canterburyhospitalredev)